

THIS DRAWING IS UNPUBLISHED. RELEASED FOR PUBLICATION
 © COPYRIGHT 20 BY TYCO ELECTRONICS CORPORATION. ALL RIGHTS RESERVED.

LOC		DIST		REVISIONS			
P	LYR	DESCRIPTION	DATE	BY	APPD		
J		REVISE PER ECR-05-003184 AND OADO-0148-05	14JUN2005	BB	LS		
K		REVISE PER ECR-06-005019	13MAR2006	BB	LS		

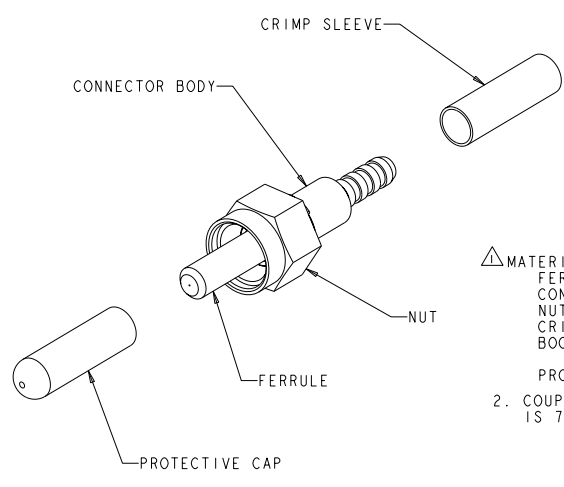
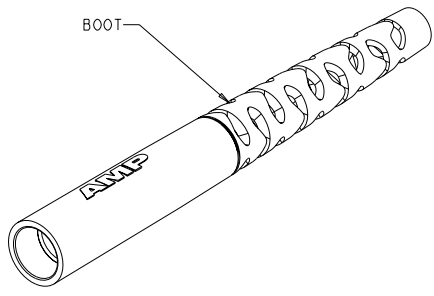
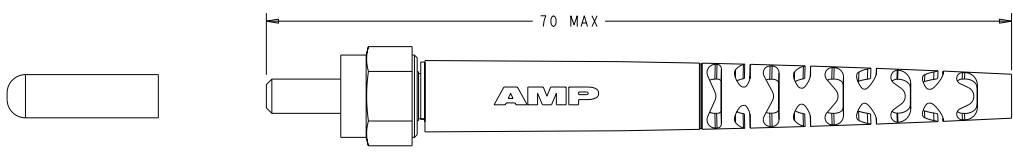

△ MATERIAL:
 FERRULE: STAINLESS STEEL
 CONNECTOR BODY: NICKEL PLATED BRASS
 NUT: NICKEL PLATED BRASS
 CRIMP SLEEVE: NICKEL PLATED BRASS
 BOOT: TPE, COLOR: BLACK, UL94 V-0 RATED AT QUALIFYING THICKNESS
 PROTECTIVE CAP: VINYL, COLOR: RED
 2. COUPLING NUT NORMAL TIGHTENING. TORQUE RANGE IS 7.0 TO 10.0 in-lbf. DO NOT EXCEED 20 in-lbf.

FIBER HOLE SIZE	PART NUMBER
.042 in	3-504566-1
.039 in	3-504566-0
336um	1-504566-4
231um	504566-7
140um	504566-2
125um	504566-1

DIMENSIONS: 0 PLC ±.010 1 PLC ±.015 2 PLC ±.020 3 PLC ±.030 4 PLC ±.040		TOLERANCES UNLESS OTHERWISE SPECIFIED: .010 ±.005 .015 ±.005 .020 ±.005 .030 ±.005 .040 ±.005		DWG: D. BRIGGS 10JUN2005 CHK: I. SAUERBECK 0JUN2005 APPR: S. BUCHTER 0JUN2005	Tyco Electronics Harrisburg, PA 17105-3600 tyco electronics
MATERIAL:		WEIGHT: -		NAME: CONNECTOR KIT, SMA 905, STAINLESS STEEL FRONT BODY, BRASS REAR BODY, 3.1mm CABLE	
CUSTOMER DRAWING		SIZE: A200779		CASE CODE: C=504566	
SCALE: 4:1		SHEET: 1 OF 1		REV: K	

AMP 1471-9 REV 51MAR2006