

HDA1040X

Dimensional Drawing

10.4", XGA (1024 X768) , TFT Color Graphics ,CCFL Backlight

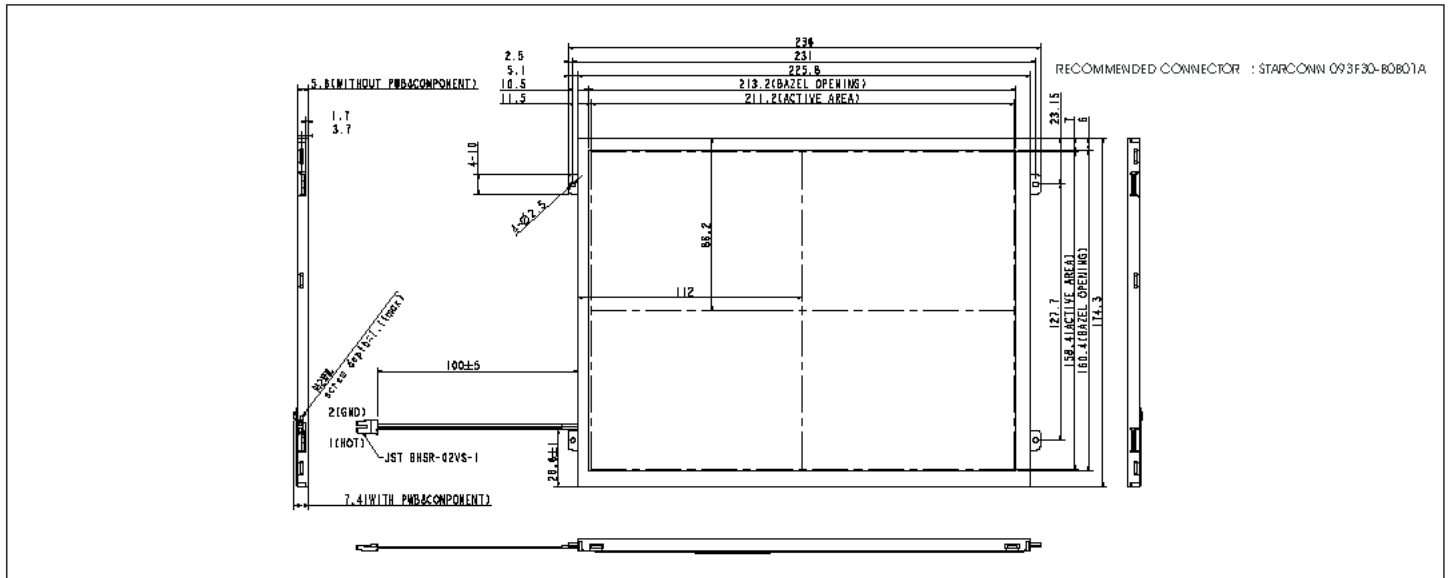

Features

Viewing Angle(H/V)	140/120 degrees
High Contrast	500:1
Fast Response Time(R/F)	.25 msec
Built-in Controller	none
LVDS Interface Logic	

Physical Data

Module Size	236.0W x174.3H x7.4T mm
Viewing Area Size	213.2W x160.4 H mm
Dot Pitch	0.20625W x 0.20625H mm
Weight	380 g

Power Supply

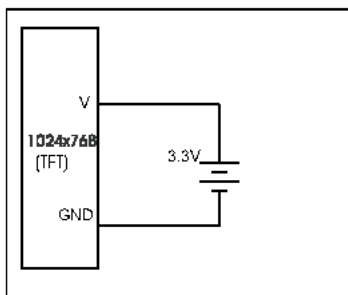

Electrical Characteristics (VCC—3.3±0.125V 25°C)

PARAMETER	SYM	CONDITION	MIN	TYP	MAX	UNIT
OPERATING VOLTAGE	V _{CC}	-	3.0	3.3	3.6	V
OPERATING VOLTAGE(CCFL)	V _{CCFL}	-	752	835	919	V _{rms}
INPUT DIF. VOLTAGE (LVDS)	V _{ID}	-	250	350	450	mV
INPUT COM. MODE VOLII	V _{CM}		1.08	1.2	1.32	V
OPERATING CURRENT	I _{CC}	V _{CC} = 3.3V	-	420	600	mA
OPERATING CURRENT (CCFL)	I _{CCFL}	-	5.5	6.0	6.5	mA _{rms}
POWER CONSUMPTION	P		-	6.41	-	W
BRIGHTNESS	L		240	300	-	cd/m ²

Pin Connections

PIN NO.	SYMBOL		FUNCTION
1	GND	-	Ground
2	V	-	+3.3V Power Supply
3	V	-	+3.3V Power Supply
4	NC	-	No Connection
5	NC	-	No Connection
6	NC	-	No Connection
7	GND	-	Ground
8	RXIN0-	H/L	LVDS (-) - chanel 0
9	RXIN0+	H/L	LVDS (+) - chanel 0
10	GND	-	Ground
11	RXIN1-	H/L	LVDS (-) - chanel 1
12	RXIN1+	H/L	LVDS (+) - chanel 1
13	GND	-	Ground
14	RXIN2-	H/L	LVDS (-) - chanel 2
15	RXIN2+	H/L	LVDS (+) - chanel 2
16	GND	-	Ground
17	RXCLK-	H/L	LVDS (-) - clock
18	RXCLK+	H/L	LVDS (+) - clock
19	GND	-	Ground
20	NC	-	No Connection
21	NC	-	No Connection
22	GND	-	Ground
23	GND	-	Ground
24	NC	-	No Connection
25	NC	-	No Connection
26	NC	-	No Connection
27	NC	-	No Connection
28	NC	-	No Connection
29	NC	-	No Connection
30	NC	-	No Connection

Absolute Maximum Ratings

PARAMETER	SYMBOL	MIN	MAX	UNIT
SUPPLY VOLTAGE	V _{CC}	-0.3	4.0	V
INPUT VOLTAGE	V _{IN}	-0.3	V _{CC} + 0.3	V
OPERATING TEMPERATURE	T _{OP}	-20	+70	°C
STORAGE TEMPERATURE	T _{STG}	-30	+80	°C
CCFL LAMP CURRENT	I _L	4	8	mA

HANTRONIX

HDA1040X

Dimensional Drawing

10.4", XGA (1024 X768) , TFT Color Graphics ,CCFL Backlight

MECHANICAL DIMENSION

Front Side

[U Nit - mm]

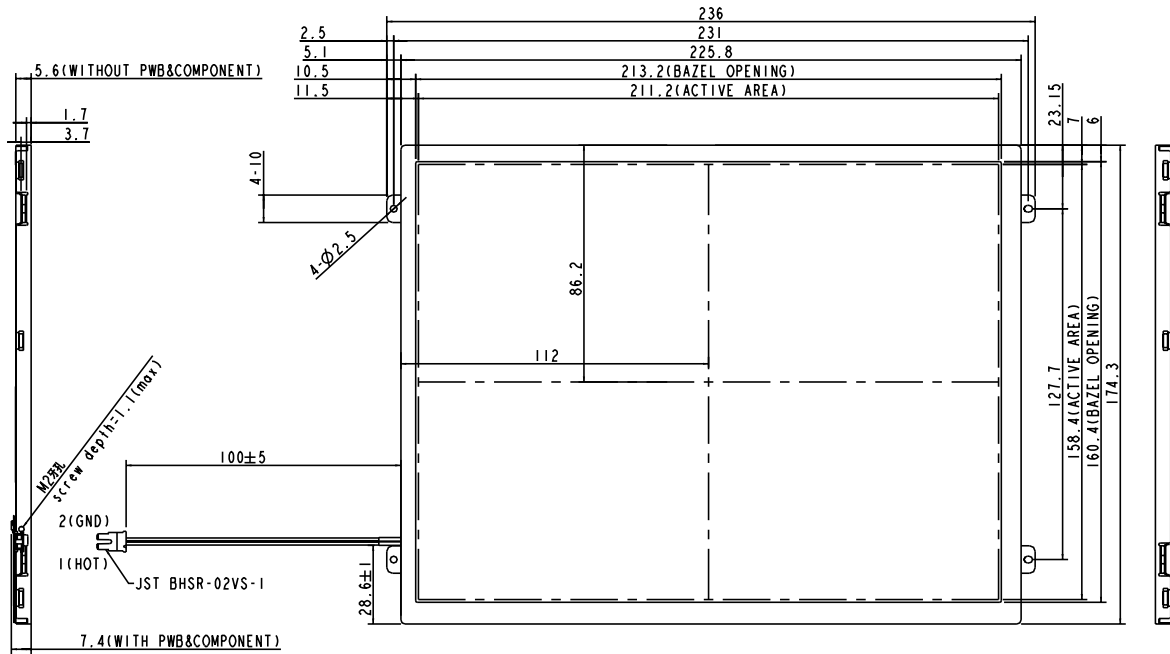

Remark? General tolerance? $\pm 0.3\text{mm}$
?

7.2 Rear Side

[Unit mm]

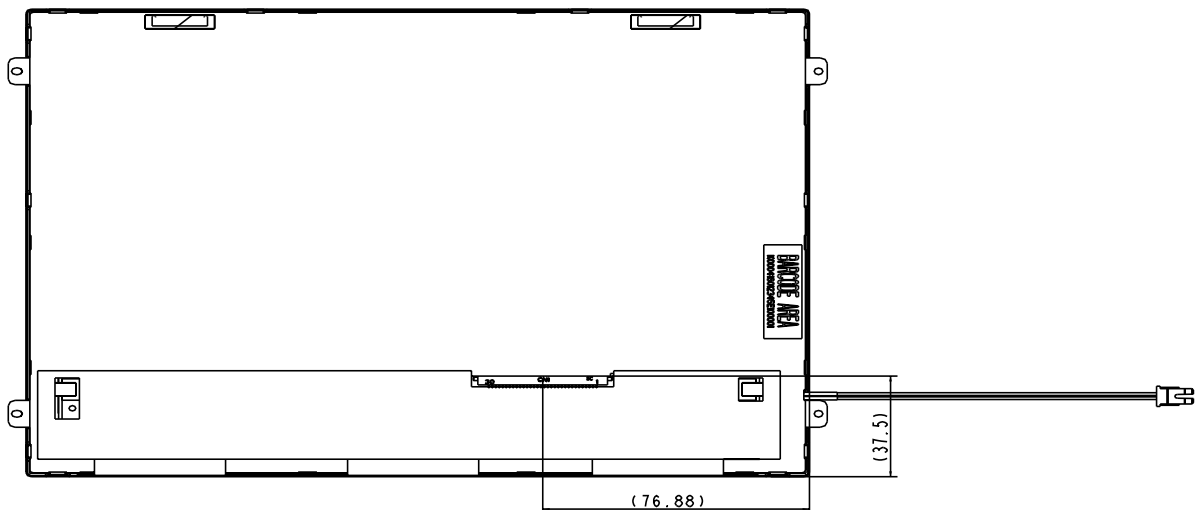

Remark General tolerance $\pm 0.3\text{mm}$

HANTRONIX

HDA1040XT

Dimensional Drawing

10.4", XGA (1024 X768) , TFT, With Touch Screen, CCFL Backlight

With TOUCH SCREEN

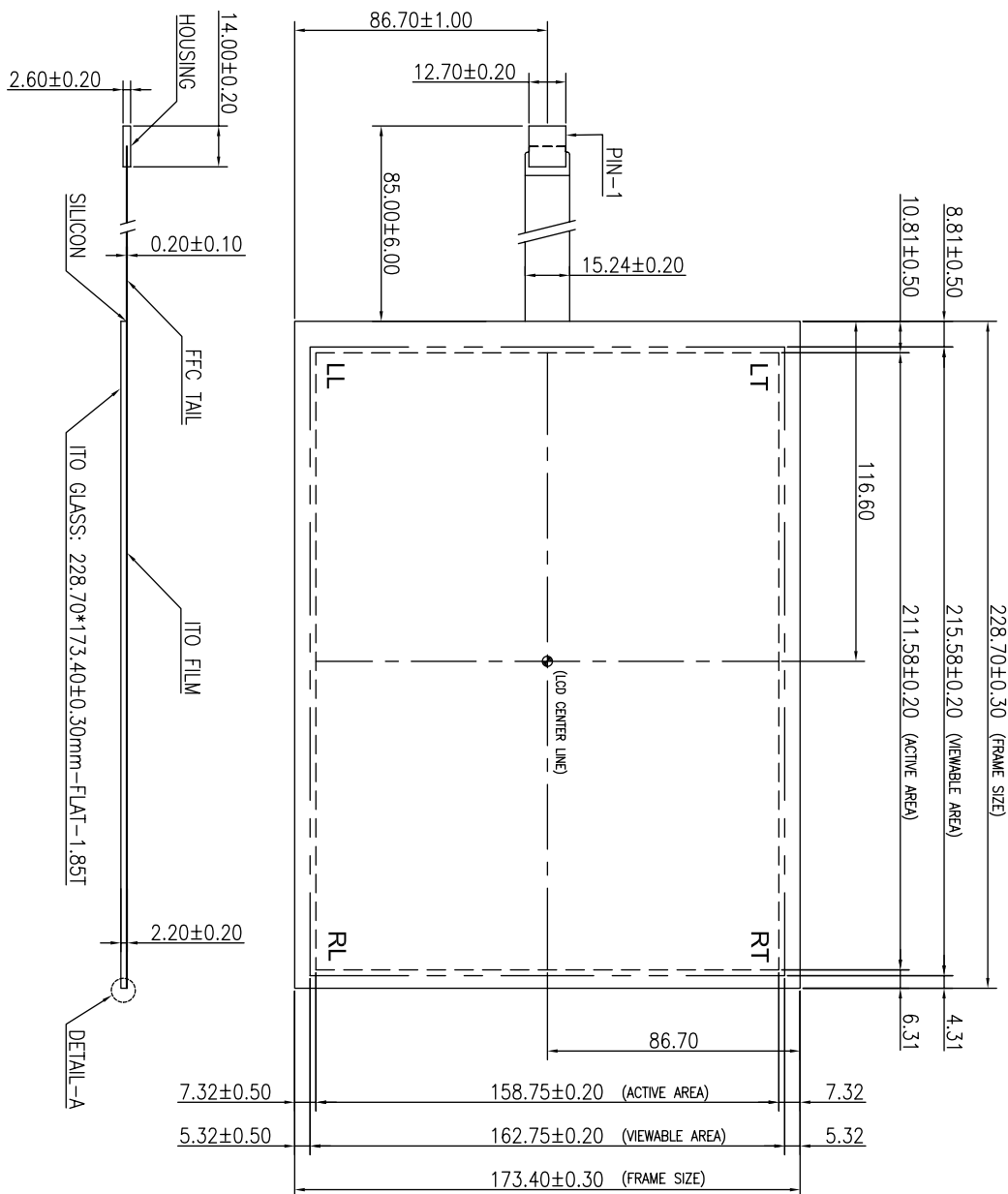
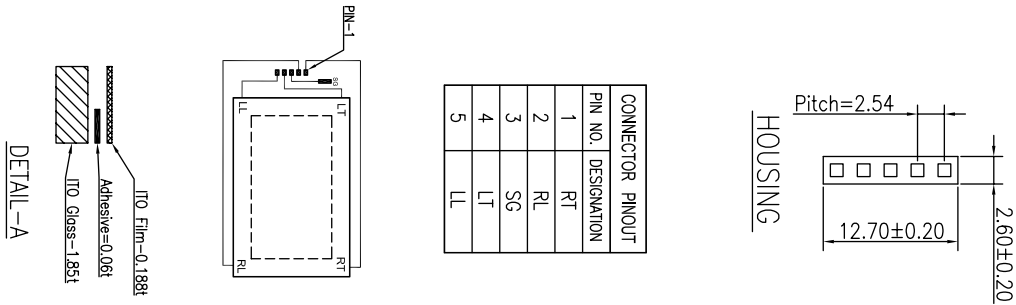

DEC.2

HANTRONIX