

DATE	REVISIONS	REV
6-26-95	REDRAWN./	A

DRAWING NUMBER	REV
LDS-A301RI	A

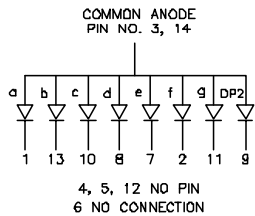
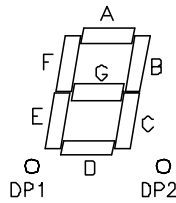
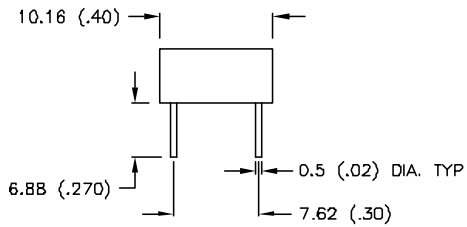
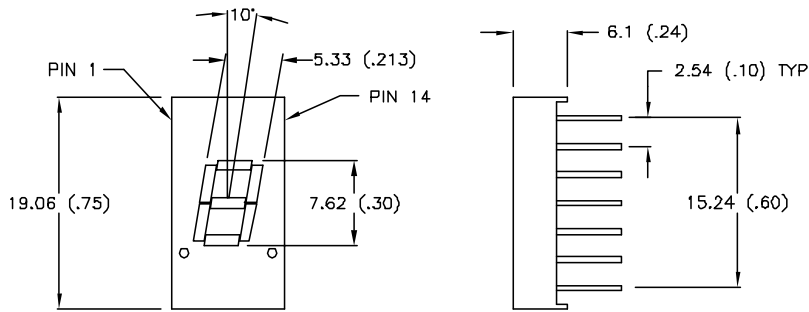

UNLESS OTHERWISE SPECIFIED TOLERANCE IS $\pm .25\text{mm}$ ($\pm 0.010''$)

ELECTRO-OPTICAL CHARACTERISTICS $T_A=25^\circ\text{C}$ $I_f=10\text{mA}$

PARAMETER	MIN	TYP	MAX	UNITS	TEST COND
PEAK WAVELENGTH		655 (RED)		nm	
FORWARD VOLTAGE		1.7	2.0	V_f	
REVERSE VOLTAGE	5.0			V_r	$I_f=100\mu\text{A}$
AXIAL INTENSITY		400		ucd	$I_f=10\text{mA}$
EMITTED COLOR	RED				
EPOXY SEGMENT	MILKY WHITE DIFFUSED				
FONT COLOR	GRAY				

LIMITS OF SAFE OPERATION PER CHIP AT 25°C

PARAMETER	MAX	UNITS
PEAK FORWARD CURRENT*	150	mA
STEADY CURRENT	30	mA
POWER DISSIPATION	100	mW
DERATE FROM 25°C	-1.8	mW/ $^\circ\text{C}$
OPERATING, STORAGE TEMP	-25 TO +80	$^\circ\text{C}$
LEAD SOLDERING TEMP	+260	$^\circ\text{C}$
2.0mm FROM BODY	3 SEC. MAX	

* $t < 10\mu\text{s}$

NOTES:

- UNITS: mm (INCHES). TOLERANCE: 0.25 (0.01"), UNLESS OTHERWISE SPECIFIED.
- I_v TESTED CONDITION $I_f=10\text{mA}$ AND THE LISTED I_v IS THE AVERAGE INTENSITY FOR EVERY SEGMENT LISTED.

LUMEX
OPTO COMPONENTS INC.

290 E. HELLEN ROAD
PALATINE, ILLINOIS 60067
(847) 359-2790

CONFIDENTIAL INFORMATION
THE INFORMATION CONTAINED IN THIS DOCUMENT IS THE PROPERTY OF LUMEX OPTO/COMPONENTS, INC. EXCEPT AS SPECIFICALLY AUTHORIZED IN WRITING BY LUMEX OPTO/COMPONENTS, INC., THE HOLDER OF THIS DOCUMENT SHALL KEEP ALL INFORMATION CONTAINED HEREIN CONFIDENTIAL AND SHALL PROTECT SAME IN WHOLE OR IN PART FROM DISCLOSURE AND DISSEMINATION TO ALL THIRD PARTIES.

DATE: 9-2-92	DWN:	CHK'D:	APPD:
SCALE: N/A			

.3" SINGLE DIGIT, SEVEN SEGMENT DISPLAY,
655nm, RED

PAGE 1 OF 1	DRAWING NUMBER LDS-A301RI	REV A
-------------	------------------------------	----------