

Aluminum Capacitors Power Eurodin Screw Terminals

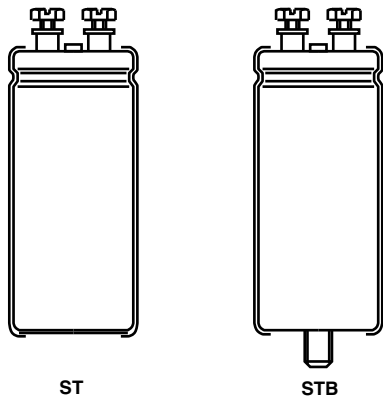

Fig.1 Component outlines



FEATURES

- Polarized aluminum electrolytic capacitors, non-solid electrolyte
- Large types, cylindrical aluminum case, insulated with a blue sleeve
- Also available in bolt version (106 PED-STB)
- Pressure relief in the sealing
- Charge and discharge proof
- Extremely low ESR and ESL allowing very high ripple current load
- Very long useful life: 20 000 h at 85 °C
- High resistance to shock and vibration
- Compliant to RoHS directive 2002/95/EC

APPLICATIONS

- Computer, telecommunications and industrial systems
- Smoothing and filtering
- Standard and switched mode power supplies
- Energy storage in pulse systems

MARKING

The capacitors are marked with the following information:

- Rated capacitance (in μF)
- Tolerance on rated capacitance, code letter in accordance with IEC 60062 (Q for - 10 %/+ 30 %)
- Rated voltage (in V)
- Date code (YYMM)
- Name of manufacturer
- Code for factory of origin
- '-' sign to identify the negative terminal, visible from the top and side of the capacitor
- Code number
- Climatic category in accordance with IEC 60068
- "LL" for long life grade

QUICK REFERENCE DATA

| DESCRIPTION | VALUE |
|--|---|
| Nominal case size (\varnothing D x L in mm) | 35 x 60 to 90 x 220 |
| Rated capacitance range (E6 series), C_R | 1000 μF to 330 000 μF |
| Tolerance on C_R | - 10 % to + 30 % |
| Rated voltage range, U_R | 25 V to 100 V |
| Category temperature range | - 40 °C to + 85 °C |
| Endurance test at 85 °C | 8000 h |
| Useful life at 85 °C | 20 000 h |
| Shelf life at 0 V, 85 °C | 500 h |
| Based on sectional specification | IEC 60384-4/EN130300 |
| Climatic category IEC 60068 | 40/085/56 |

SELECTION CHART FOR C_R , U_R AND RELEVANT NOMINAL CASE SIZES (\varnothing D x L in mm)

| C_R (μF) | U_R (V) | | | |
|----------------------------|-----------|----------|----------|----------|
| | 25 | 40 | 63 | 100 |
| 1000 | - | - | - | 35 x 60 |
| 1500 | - | - | - | 35 x 60 |
| 2200 | - | - | 35 x 60 | 35 x 80 |
| 3300 | - | 35 x 60 | 35 x 60 | 35 x 105 |
| 4700 | 35 x 60 | 35 x 60 | 35 x 80 | 50 x 80 |
| 6800 | 35 x 60 | 35 x 80 | 35 x 105 | 50 x 105 |
| 10 000 | 35 x 80 | 35 x 105 | 50 x 80 | 65 x 105 |
| 15 000 | 35 x 105 | 50 x 80 | 50 x 105 | 65 x 105 |
| 22 000 | 50 x 80 | 50 x 105 | 65 x 105 | 76 x 105 |
| 33 000 | 50 x 105 | 65 x 105 | 65 x 105 | 76 x 146 |
| 47 000 | 65 x 105 | 65 x 105 | 76 x 105 | 76 x 220 |
| 68 000 | 65 x 105 | 76 x 105 | 76 x 146 | 90 x 220 |
| 100 000 | 76 x 105 | 76 x 146 | 76 x 220 | - |

| SELECTION CHART FOR C_R, U_R AND RELEVANT NOMINAL CASE SIZES (∅ D x L in mm) | | | | |
|---|--------------------|----------|----------|-----|
| C _R (μF) | U _R (V) | | | |
| | 25 | 40 | 63 | 100 |
| 150 000 | 76 x 146 | 76 x 220 | - | - |
| | - | 90 x 146 | 90 x 220 | - |
| 220 000 | 76 x 220 | - | - | - |
| | 90 x 146 | 90 x 220 | - | - |
| 330 000 | 90 x 220 | - | - | - |

Table 1

| DIMENSIONS in millimeters, MASS AND PACKAGING QUANTITIES | | | | | | | | | | | | | | |
|---|---------|-------|--------------------|-------|---------|---------|---------|---------|----------------------|----|-------|-----|----------------------|----------|
| DESIGN | DRAWING | L ± 1 | L _t ± 1 | D ± 1 | P ± 0.3 | T ± 0.2 | H ± 0.3 | B ± 0.3 | d ₁ ± 0.1 | M | S - 0 | Mb | l _b ± 0.1 | MASS (g) |
| 35 x 60 | 2A | 63.3 | 68.7 | 35.3 | 12.8 | 7.0 | 4.6 | 11.0 | 7.9 | M5 | 9.5 | M8 | 12.0 | 75 |
| 35 x 80 | 2A | 81.3 | 86.7 | 35.3 | 12.8 | 7.0 | 4.6 | 11.0 | 7.9 | M5 | 9.5 | M8 | 12.0 | 95 |
| 35 x 105 | 2A | 103.3 | 108.7 | 35.3 | 12.8 | 7.0 | 4.6 | 11.0 | 7.9 | M5 | 9.5 | M8 | 12.0 | 130 |
| 50 x 80 | 2A | 82.8 | 88.8 | 51.0 | 22.2 | 7.1 | 4.8 | 11.0 | 7.9 | M5 | 9.5 | M12 | 16.0 | 200 |
| 50 x 105 | 2A | 104.8 | 110.8 | 51.0 | 22.2 | 7.1 | 4.8 | 11.0 | 7.9 | M5 | 9.5 | M12 | 16.0 | 300 |
| 65 x 105 | 2A | 104.8 | 110.7 | 65.0 | 28.5 | 7.0 | 4.6 | 11.9 | 7.9 | M5 | 9.5 | M12 | 16.0 | 480 |
| 65 x 105 HC | 2B | 104.8 | 109.2 | 65.0 | 28.5 | 5.5 | 3.5 | 18.0 | 13.0 | M6 | 8.5 | M12 | 16.0 | 480 |
| 76 x 105 | 2A | 105.8 | 111.7 | 76.4 | 31.8 | 7.0 | 4.6 | 11.7 | 7.9 | M5 | 9.5 | M12 | 16.0 | 700 |
| 76 x 105 HC | 2B | 105.8 | 110.2 | 76.4 | 31.8 | 5.5 | 3.5 | 18.3 | 13.0 | M6 | 8.5 | M12 | 16.0 | 700 |
| 76 x 146 | 2A | 145.8 | 151.7 | 76.4 | 31.8 | 7.0 | 4.6 | 11.7 | 7.9 | M5 | 9.5 | M12 | 16.0 | 1000 |
| 76 x 146 HC | 2B | 145.8 | 150.2 | 76.4 | 31.8 | 5.5 | 3.5 | 18.3 | 13.0 | M6 | 8.5 | M12 | 16.0 | 1000 |
| 76 x 220 | 2A | 219.8 | 225.7 | 76.4 | 31.8 | 7.0 | 4.6 | 11.7 | 7.9 | M5 | 9.5 | M12 | 16.0 | 1500 |
| 76 x 220 HC | 2B | 219.8 | 224.2 | 76.4 | 31.8 | 5.5 | 3.5 | 18.3 | 13.0 | M6 | 8.5 | M12 | 16.0 | 1500 |
| 90 x 146 HC | 2B | 150.1 | 155.4 | 89.4 | 31.8 | 7.9 | 0.0 | 13.0 | 13.0 | M6 | 10.0 | M12 | 16.0 | 1300 |
| 90 x 220 HC | 2B | 218.1 | 223.4 | 89.4 | 31.8 | 7.9 | 0.0 | 13.0 | 13.0 | M6 | 10.0 | M12 | 16.0 | 2000 |

Notes

- For bolt version holds:
 L = L standard - 0.5 mm
 L_t = L_t standard - 0.5 mm

| DIMENSIONS in millimeters, MASS AND PACKAGING QUANTITIES | | |
|---|--------------------------------------|--|
| DESIGN | PACKAGING QUANTITIES (UNITS PER BOX) | CARDBOARD BOX DIMENSIONS L x W x H in mm |
| 35 x 60 | 50 | 377 x 375 x 88 |
| 35 x 80 | 50 | 377 x 375 x 123 |
| 35 x 105 | 50 | 377 x 375 x 129 |
| 50 x 80 | 25 | 377 x 375 x 123 |
| 50 x 105 | 25 | 377 x 375 x 129 |
| 65 x 105 | 16 | 377 x 375 x 129 |
| 65 x 105 HC | 16 | 377 x 375 x 129 |
| 76 x 105 | 12 | 377 x 375 x 129 |
| 76 x 105 HC | 12 | 377 x 375 x 129 |
| 76 x 146 | 12 | 377 x 375 x 168 |
| 76 x 146 HC | 12 | 377 x 375 x 168 |
| 76 x 220 | 18 | 520 x 270 x 280 |
| 76 x 220 HC | 18 | 520 x 270 x 280 |
| 90 x 146 HC | 10 | 520 x 270 x 190 |
| 90 x 220 HC | 10 | 520 x 270 x 280 |

Note

- For bolt version holds:
 H of cardbox box: + 10 mm

DIMENSIONS in millimeters AND AVAILABLE FORMS

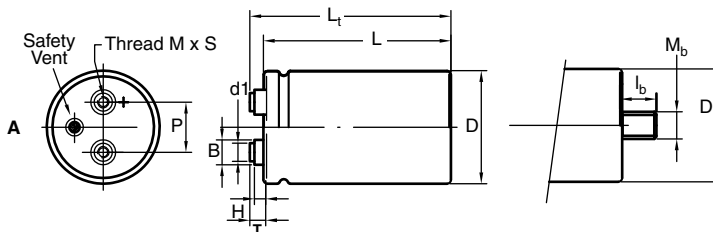

Fig. 2A: Standard M5 disc: screw terminal (ST) and screw terminal bolt nut (STB)

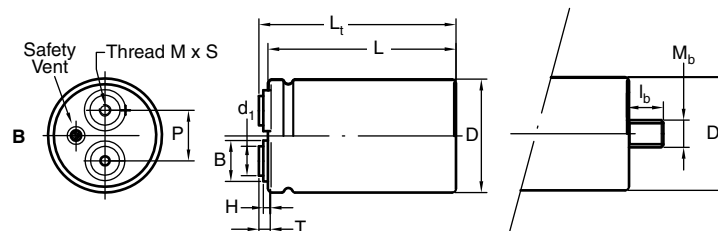

Fig. 2B: High current M6 disc: screw terminal (ST) and screw terminal bolt nut (STB)

Maximum permissible torque which may be applied to the termination screws: 2 Nm for M5; 2.5 Nm for M6
For accessories refer to datasheet "Mounting Accessories".
The capacitors are delivered with screws and washers.

ELECTRICAL DATA

| SYMBOL | DESCRIPTION |
|----------|---|
| C_R | Rated capacitance at 100 Hz, tolerance - 10 % to + 30 % |
| I_R | Rated RMS ripple current at 100 Hz, 85 °C |
| I_{L5} | Max. leakage current after 5 min at U_R |
| ESR | Max. equivalent series resistance at 100 Hz |
| Z | Impedance at 20 kHz |

Note

- Unless otherwise specified, all electrical values in tables 2 and 3 apply at $T_{amb} = 20\text{ °C}$, $P = 86\text{ kPa}$ to 106 kPa , $RH = 45\%$ to 75%

ORDERING EXAMPLE

Electrolytic capacitor 106 PED-ST series
10 000 $\mu\text{F}/25\text{ V}$; - 10 %/+ 30 %
Nominal case size: $\varnothing 35\text{ mm} \times 80\text{ mm}$; ST version
Ordering code: MAL210616103E3
Former 12NC: 222210616103

Table 2

| ELECTRICAL DATA AND ORDERING INFORMATION | | | | | | | | | | |
|--|--------------------------------------|---|---------------------------------|---------------------------|--|--------------------------------------|--|---|--|---|
| U_R (V) | C_R 100 Hz (μF) | NOMINAL CASE SIZE $\varnothing D \times L$ (mm) | I_R 100 Hz 85 °C (A) | I_{L5} 5 min (mA) | ESR max. 100 Hz (m Ω) | Z max. 20 kHz (m Ω) | STANDARD HIGH POST M5 DISC | | HIGH CURRENT M6 DISC | |
| | | | | | | | ST ORDERING CODE MAL2106..... | ST BOLT NUT ORDERING CODE MAL2106..... | ST ORDERING CODE MAL2106..... | ST BOLT NUT ORDERING CODE MAL2106..... |
| 25 | 4700 | 35 x 60 | 6.0 | 0.24 | 53 | 32 | 16472E3 | 56472E3 | - | - |
| | 6800 | 35 x 60 | 6.5 | 0.34 | 43 | 29 | 16682E3 | 56682E3 | - | - |
| | 10 000 | 35 x 80 | 7.9 | 0.50 | 32 | 22 | 16103E3 | 56103E3 | - | - |
| | 15 000 | 35 x 105 | 9.3 | 0.75 | 25 | 18 | 16153E3 | 56153E3 | - | - |
| | 22 000 | 50 x 80 | 14.0 | 1.10 | 15 | 11 | 16223E3 | 56223E3 | - | - |
| | 33 000 | 50 x 105 | 16.4 | 1.65 | 12 | 9 | 16333E3 | 56333E3 | - | - |
| | 47 000 | 65 x 105 | 23.2 | 3.35 | 8 | 6 | 16473E3 | 56473E3 | 36473E3 | 76473E3 |
| | 68 000 | 65 x 105 | 23.5 | 3.40 | 8 | 6 | 16683E3 | 56683E3 | 36683E3 | 76683E3 |
| | 100 000 | 76 x 105 | 30.1 | 5.00 | 6 | 5 | 16104E3 | 56104E3 | 36104E3 | 76104E3 |
| | 150 000 | 76 x 146 | 34.5 | 7.5 | 5 | 5 | 16154E3 | 56154E3 | 36154E3 | 76154E3 |
| | 220 000 | 76 x 220 | 40.8 | 11.0 | 5 | 5 | 16224E3 | 56224E3 | 36224E3 | 76224E3 |
| | 220 000 | 90 x 146 | 50 | 11.0 | 5 | 5 | - | - | 46224E3 | 86224E3 |
| | 330 000 | 90 x 220 | 50 | 16.5 | 5 | 5 | - | - | 46334E3 | 86334E3 |



| ELECTRICAL DATA AND ORDERING INFORMATION | | | | | | | | | | |
|--|----------------------------------|--|--|----------------------------------|-------------------------------|-----------------------------|--|---|--|---|
| U _R (V) | C _R 100 Hz (µF) | NOMINAL CASE SIZE Ø D x L (mm) | I _R 100 Hz 85 °C (A) | I _{L5} 5 min (mA) | ESR max. 100 Hz (mΩ) | Z max. 20 kHz (mΩ) | STANDARD HIGH POST M5 DISC | | HIGH CURRENT M6 DISC | |
| | | | | | | | ST ORDERING CODE MAL2106..... | ST BOLT NUT ORDERING CODE MAL2106..... | ST ORDERING CODE MAL2106..... | ST BOLT NUT ORDERING CODE MAL2106..... |
| 40 | 3300 | 35 x 60 | 5.7 | 0.27 | 56 | 32 | 17332E3 | 57332E3 | - | - |
| | 4700 | 35 x 60 | 6.0 | 0.38 | 48 | 31 | 17472E3 | 57472E3 | - | - |
| | 6800 | 35 x 80 | 7.3 | 0.55 | 36 | 24 | 17682E3 | 57682E3 | - | - |
| | 10 000 | 35 x 105 | 10.9 | 0.80 | 19 | 11 | 17103E3 | 57103E3 | - | - |
| | 15 000 | 50 x 80 | 13.0 | 1.20 | 17 | 12 | 17153E3 | 57153E3 | - | - |
| | 22 000 | 50 x 105 | 15.2 | 1.76 | 13 | 10 | 17223E3 | 57223E3 | - | - |
| | 33 000 | 65 x 105 | 21.6 | 2.64 | 9 | 7 | 17333E3 | 57333E3 | 37333E3 | 77333E3 |
| | 47 000 | 65 x 105 | 25.1 | 3.76 | 7 | 5 | 17473E3 | 57473E3 | 37473E3 | 77473E3 |
| | 68 000 | 76 x 105 | 27.3 | 5.44 | 7 | 5 | 17683E3 | 57683E3 | 37683E3 | 77683E3 |
| | 100 000 | 76 x 146 | 31.8 | 8.0 | 5 | 5 | 17104E3 | 57104E3 | 37104E3 | 77104E3 |
| | 150 000 | 76 x 220 | 38.2 | 12.0 | 5 | 5 | 17154E3 | 57154E3 | 37154E3 | 77154E3 |
| | 150 000 | 90 x 146 | 50.0 | 12.0 | 5 | 5 | - | - | 47154E3 | 87154E3 |
| 220 000 | 90 x 220 | 50.0 | 17.6 | 5 | 5 | - | - | 47224E3 | 87224E3 | |
| 63 | 2200 | 35 x 60 | 5.6 | 0.28 | 56 | 32 | 18222E3 | 58222E3 | - | - |
| | 3300 | 35 x 60 | 7.4 | 0.42 | 32 | 17 | 18332E3 | 58332E3 | - | - |
| | 4700 | 35 x 80 | 9.0 | 0.60 | 24 | 13 | 18472E3 | 58472E3 | - | - |
| | 6800 | 35 x 105 | 10.8 | 0.86 | 18 | 10 | 18682E3 | 58682E3 | - | - |
| | 15 000 | 50 x 105 | 17.5 | 1.89 | 10 | 7 | 18153E3 | 58153E3 | - | - |
| | 10 000 | 50 x 80 | 14.8 | 1.26 | 13 | 8 | 18103E3 | 58103E3 | - | - |
| | 22 000 | 65 x 105 | 23.9 | 2.78 | 7 | 5 | 18223E3 | 58223E3 | 38223E3 | 78223E3 |
| | 33 000 | 65 x 105 | 23.9 | 4.16 | 7 | 5 | 18333E3 | 58333E3 | 38333E3 | 78333E3 |
| | 47 000 | 76 x 105 | 25.4 | 5.93 | 8 | 5 | 18473E3 | 58473E3 | 38473E3 | 78473E3 |
| | 68 000 | 76 x 146 | 29.8 | 8.6 | 6 | 5 | 18683E3 | 58683E3 | 38683E3 | 78683E3 |
| | 100 000 | 76 x 220 | 36.6 | 12.6 | 5 | 5 | 18104E3 | 58104E3 | 38104E3 | 78104E3 |
| | 150 000 | 90 x 220 | 50.0 | 18.9 | 5 | 5 | - | - | 48154E3 | 88154E3 |
| 100 | 1000 | 35 x 60 | 3.7 | 0.20 | 96 | 48 | 19102E3 | 59102E3 | - | - |
| | 1500 | 35 x 60 | 4.8 | 0.30 | 59 | 27 | 19152E3 | 59152E3 | - | - |
| | 2200 | 35 x 80 | 5.9 | 0.44 | 42 | 20 | 19222E3 | 59222E3 | - | - |
| | 3300 | 35 x 105 | 7.3 | 0.66 | 29 | 15 | 19332E3 | 59332E3 | - | - |
| | 4700 | 50 x 80 | 10.1 | 0.94 | 22 | 12 | 19472E3 | 59472E3 | - | - |
| | 6800 | 50 x 105 | 12.1 | 1.36 | 16 | 9 | 19682E3 | 59682E3 | - | - |
| | 10 000 | 65 x 105 | 16.7 | 2.00 | 11 | 7 | 19103E3 | 59103E3 | 39103E3 | 79103E3 |
| | 15 000 | 65 x 105 | 17.6 | 3.00 | 10 | 6 | 19153E3 | 59153E3 | 39153E3 | 79153E3 |
| | 22 000 | 76 x 105 | 19.5 | 4.40 | 9 | 6 | 19223E3 | 59223E3 | 39223E3 | 79223E3 |
| | 33 000 | 76 x 146 | 23.0 | 6.6 | 8 | 6 | 19333E3 | 59333E3 | 39333E3 | 79333E3 |
| | 47 000 | 76 x 220 | 28.6 | 9.4 | 5 | 5 | 19473E3 | 59473E3 | 39473E3 | 79473E3 |
| | 68 000 | 90 x 220 | 50.0 | 13.6 | 5 | 5 | - | - | 49683E3 | 89683E3 |

| ADDITIONAL ELECTRICAL DATA | | |
|------------------------------------|-------------------------------|--|
| PARAMETER | CONDITIONS | VALUE |
| Voltage | | |
| Surge voltage | | U _s = 1.15 x U _R |
| Reverse voltage | | U _{rev} ≤ 1 V |
| Current | | |
| Leakage current | After 1 min at U _R | I _{L1} ≤ 0.006 C _R x U _R + 4 µF |
| | After 5 min at U _R | I _{L5} ≤ 0.002 C _R x U _R + 4 µF |
| Inductance | | |
| Equivalent series inductance (ESL) | Case Ø D = 35 mm | typ. 13 nH |
| | Case Ø D = 50 mm | typ. 16 nH |
| | Case Ø D = 65 mm | typ. 19 nH ⁽¹⁾ |
| | Case Ø D = 76 mm | typ. 20 nH ⁽¹⁾ |
| | Case Ø D = 90 mm | typ. 21 nH ⁽¹⁾ |

Note

(1) Low ESL designs available on request

RIPPLE CURRENT AND USEFUL LIFE

CCC205-05

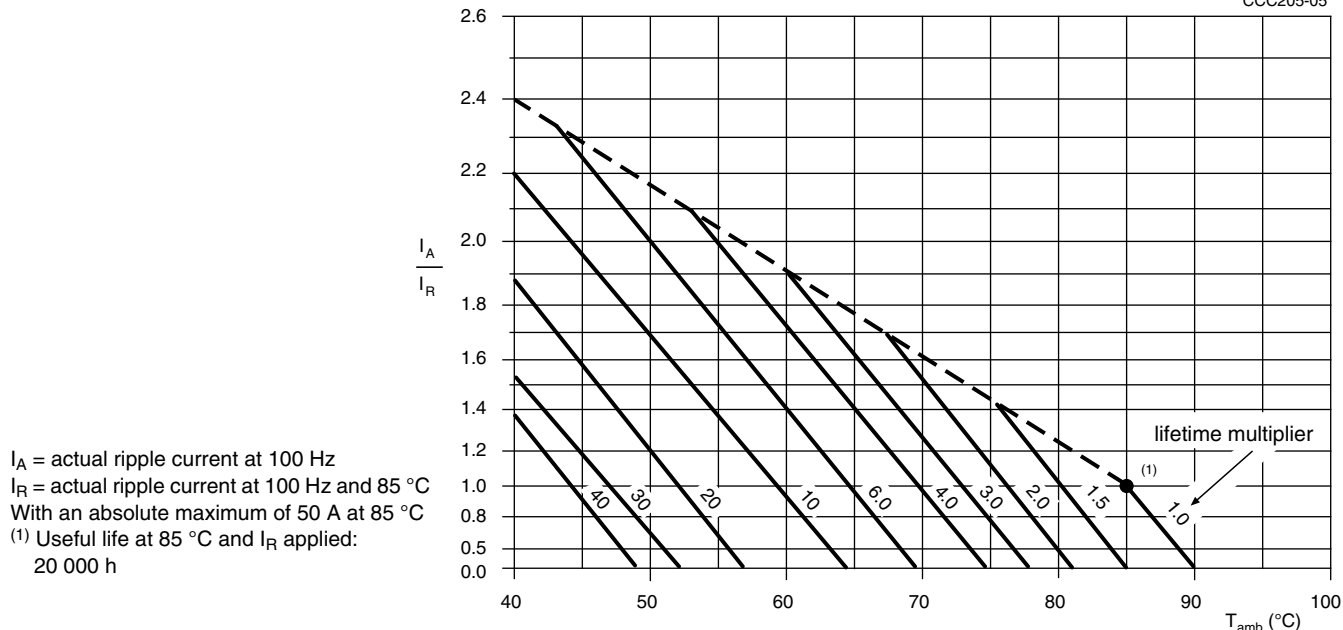

Fig.3 Multiplier of useful life as a function of ambient temperature and ripple current load

Table 3

| MULTIPLIER OF RIPPLE CURRENT (I_R) AS A FUNCTION OF FREQUENCY | |
|---|------------------|
| FREQUENCY (Hz) | I_R MULTIPLIER |
| 50 | 0.83 |
| 100 | 1.00 |
| 200 | 1.10 |
| 400 | 1.15 |
| 1000 | 1.19 |
| ≥ 2000 | 1.20 |

Table 4

| TEST PROCEDURES AND REQUIREMENTS | | | |
|--|--|---|---|
| TEST | | PROCEDURE (quick reference) | REQUIREMENTS |
| NAME OF TEST | REFERENCE | | |
| Endurance | IEC 60384-4/ EN130300 subclause 4.13 | $T_{amb} = 85\text{ °C}$; U_R applied; 8000 h | $\Delta C/C: \pm 15\%$ $\tan \delta \leq 1.3 \times \text{spec. limit}$ $Z \leq 2 \times \text{spec. limit}$ $I_{L5} \leq \text{spec. limit}$ |
| Useful life | CECC 30301 subclause 1.8.1 | $T_{amb} = 85\text{ °C}$; U_R and I_R applied; 20 000 h | $\Delta C/C: \pm 45\%$ $\tan \delta \leq 3 \times \text{spec. limit}$ $Z \leq 3 \times \text{spec. limit}$ $I_{L5} \leq \text{spec. limit}$ no short or open circuit, no visible damage total failure percentage $\leq 1\%$ |
| Shelf life (storage at high temperature) | IEC 60384-4/ EN130300 subclause 4.17 | $T_{amb} = 85\text{ °C}$; no voltage applied; 500 h after test: U_R to be applied for 30 min, 24 h to 48 h before measurement | $\Delta C/C: \pm 10\%$ $\tan \delta \leq 1.2 \times \text{spec. limit}$ $IL5 \leq 2 \times \text{spec. limit}$ |



Disclaimer

All product specifications and data are subject to change without notice.

Vishay Intertechnology, Inc., its affiliates, agents, and employees, and all persons acting on its or their behalf (collectively, "Vishay"), disclaim any and all liability for any errors, inaccuracies or incompleteness contained herein or in any other disclosure relating to any product.

Vishay disclaims any and all liability arising out of the use or application of any product described herein or of any information provided herein to the maximum extent permitted by law. The product specifications do not expand or otherwise modify Vishay's terms and conditions of purchase, including but not limited to the warranty expressed therein, which apply to these products.

No license, express or implied, by estoppel or otherwise, to any intellectual property rights is granted by this document or by any conduct of Vishay.

The products shown herein are not designed for use in medical, life-saving, or life-sustaining applications unless otherwise expressly indicated. Customers using or selling Vishay products not expressly indicated for use in such applications do so entirely at their own risk and agree to fully indemnify Vishay for any damages arising or resulting from such use or sale. Please contact authorized Vishay personnel to obtain written terms and conditions regarding products designed for such applications.

Product names and markings noted herein may be trademarks of their respective owners.