

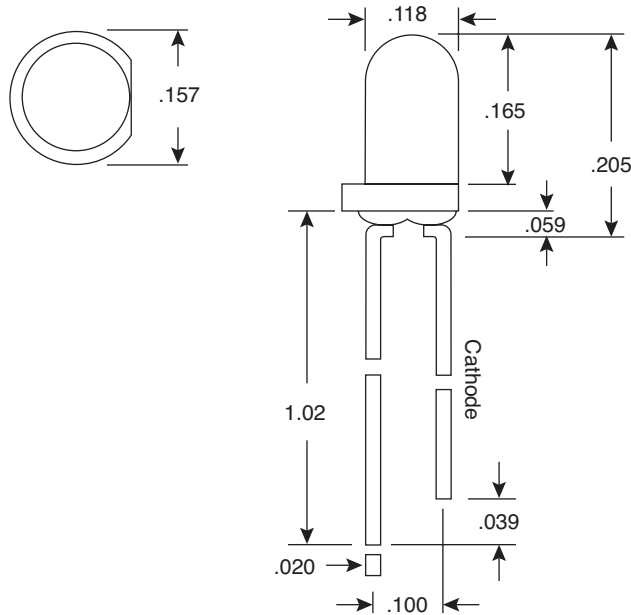

# T-1 Super Bright LED Lamps

# 351-3310, 351-3312, 351-3316



Dimensions (In.)

## ■ ABSOLUTE MAXIMUM RATINGS (Ta=25°C)

Parameter	351-3310	351-3312	351-3316
Power Dissipation (mW)	120	120	120
Forward Current (mA)	30	30	30
Peak Forward Current (mA) (Duty 1/10 @ 10KHz)	100	100	100
Reverse Current @ 5V (µA)	50	50	50
Operating Temperature	-20°C to +80°C		
Storage Temperature Range	-30°C to +100°C		
Lead Solder Temperature .079" below package (case) 260°C for 5 seconds			

## ■ ELECTRICAL CHARACTERISTICS (Ta=25°C)

Mouser Stock No.	Dice Material	Emitted Light Color	Lens	Forward Voltage (V) @20mA		Peak Wavelength (nm)	Luminous Intensity (mcd)		Viewing Angle
				Typ	Max		Min	Typ	
351-3310	InGaN/GaN	Blue	Water Clear	3.5	4.0	470	900	1800	30°
351-3312	InGaN/GaN	White	Water Clear	3.5	4.0	470	1800	3000	30°
351-3316	InGaN/GaN	Green	Water Clear	3.5	4.0	518	1500	2700	30°



XICON PASSIVE COMPONENTS • (800) 628-0544

XC-600113

Specifications are subject to change without notice. No liability or warranty implied by this information. Environmental compliance based on producer documentation. Date Revised: 3/06/06