

UNCONTROLLED DOCUMENT

PART NUMBER
SSF-LXH250LGD

REV.

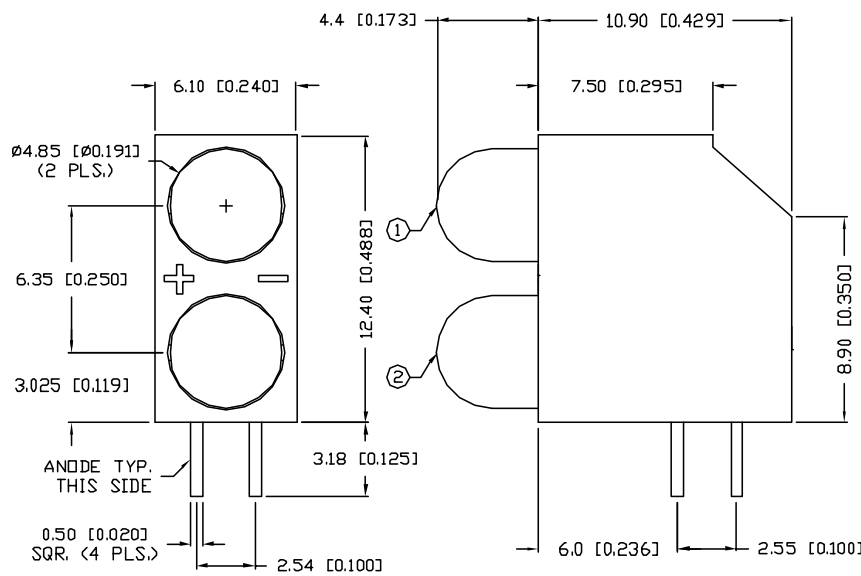

NOTES:

1. SSL-LX509F3LGD, GREEN LED.
2. SSL-LX509F3LJD, RED LED.
3. SSH-LXH250, BLACK HOLDER.

ELECTRO-OPTICAL CHARACTERISTICS $T_A=25^{\circ}\text{C}$ $I_f=20\text{mA}$

PARAMETER	GREEN	RED	UNITS	TEST COND
PEAK WAVELENGTH	565	635	nm	
FORWARD VOLTAGE (TYP.)	2.2	2.0	V_f	
FORWARD VOLTAGE (MAX.)	2.6	2.5	V_f	
REVERSE VOLTAGE (TYP.)	5.0	5.0	V_r	$I_f=100\mu\text{A}$
AXIAL INTENSITY (TYP.)	30	40	mcd	$I_f=20\text{mA}$
AXIAL INTENSITY (MIN.)	1.0	1.0	mcd	$I_f=2\text{mA}$
VIEWING ANGLE	60	80	2x theta	
LED POSITION:	1	2		
EPOXY LENS FINISH: DIFFUSED SAME AS EMITTED COLOR				

LIMITS OF SAFE OPERATION AT 25°C

PARAMETER	COLORS	MAX	UNITS
PEAK FORWARD CURRENT*		150	mA
STEADY CURRENT	(G/R)	25/30	mA
POWER DISSIPATION		105	mW
DERATE FROM 25°C		-1.2	mW/ $^{\circ}\text{C}$
OPERATING, STORAGE TEMP.		-40 TO +85	$^{\circ}\text{C}$
SOLDERING TEMP.		+260	$^{\circ}\text{C}$
2.0mm FROM BODY			3 SEC. MAX

* $t < 10\mu\text{s}$

*UNLESS OTHERWISE SPECIFIED TOLERANCES PER DECIMAL PRECISION ARE: X=±1 (±0.039), XX=±0.5 (±0.020), XXX=±0.25 (±0.010), XXXX=±0.127 (±0.005). LEAD SIZE=±0.05 (±0.002), LEAD LENGTH=±0.75 (±0.030). MIN.=^{+0.00} DECIMAL PRECISION, MAX.=^{+0.00} DECIMAL PRECISION

UNCONTROLLED DOCUMENT

REV.	PART NUMBER	CONFIDENTIAL INFORMATION	LUMEX INCORPORATED	290 E. HELLEN ROAD PALATINE, ILLINOIS 60067 PHONE: (847) 359-2790 WEB: http://www.lumex.com
	SSF-LXH250LGD	THE INFORMATION CONTAINED IN THIS DOCUMENT IS THE PROPERTY OF LUMEX INC. EXCEPT AS SPECIFICALLY AUTHORIZED IN WRITING BY LUMEX INC., THE HOLDER OF THIS DOCUMENT SHALL KEEP ALL INFORMATION CONTAINED HEREIN CONFIDENTIAL AND SHALL PROTECT SAME IN WHOLE OR IN PART FROM DISCLOSURE AND DISSEMINATION TO ALL THIRD PARTIES.		
	T-5mm (T-1 3/4) LED RIGHT ANGLE FAULT INDICATOR, POS.1: 565nm GREEN DIFFUSED LED, LOW CURRENT, POS.2: 635nm RED DIFFUSED LED, LOW CURRENT.	RELIABILITY NOTE OUR MANY YEARS OF EXPERIENCE DATA ACCUMULATION INDICATE THAT SOLDER HEAT IS A MAJOR CAUSE OF EARLY AND FUTURE FAILURE. PLEASE PAY ATTENTION TO YOUR SOLDERING PROCESS.	DRAWN BY: BC	CHECKED BY: APPROVED BY: DATE: 9.26.00 PAGE: 1 OF 1 SCALE: N/A