

SIGN	DATE	DESCRIPTION	APPROVER
△	2009.01.21	CUL approval added	Lee
△	2009.01.21	Torque changed from 1.7 to 1.1Lb-In	Lee

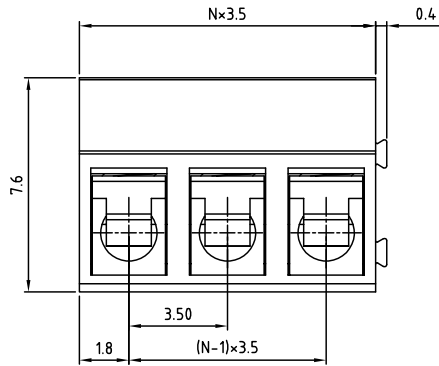

N=Number of poles

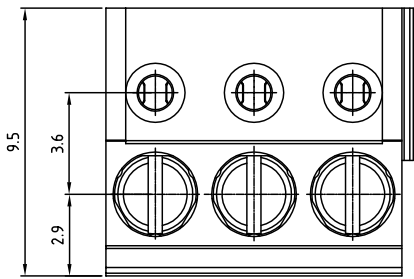
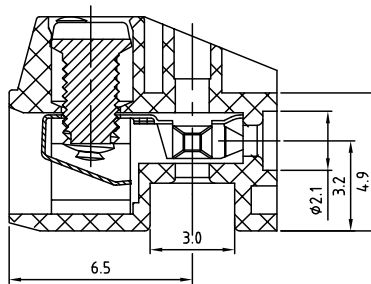

**Material**

- Terminal body (Contact pin): Brass(Cuzn)
- Terminal screw: Steel Zinc plating: "-" slot type
- Wire guard: Copper Alloy
- Insulator (housing): Thermoplastic (UL94V-0)

**Electrical**

- Voltage rating: 150VAC
- Current rating: 10A
- Wire range:
  - Solid wire(AWG): 16-28
  - Stranded wire(AWG): 16-28
- △ Torque(Lb-In): 1.1
- Screw: M2
- Wire strip length: 5-6mm
- Withstanding Voltage: 1.3KV
- Operating temperature: -30°C to +105°C
- △ Safety Approval:

RoHS Compliant

PART NUMBER:

OSTEHXX2160

- |              |                    |
|--------------|--------------------|
| No. of Poles | COLOR              |
| 02 2 Poles   | 0: Black           |
| 03 3 Poles   | 5: Green           |
| ...          | 6: Blue (Standard) |
| 24 24 Poles  | 8: Grey            |



THESE DRAWINGS AND SPECIFICATIONS ARE THE PROPERTY OF ON-SHORE TECHNOLOGY, INC. AND SHALL NOT BE REPRODUCED, COPIED OR USED IN ANY MANNER WITHOUT THE PRIOR WRITTEN CONSENT OF ON-SHORE TECHNOLOGY, INC.

TITLE		OSTEH - 3.5mm Series	
PART NO.	OSTEHXX2160	DWG NO.	OSTEHXX2160.DWG
APPROVED	CHECKED	DESIGNED	DRAWN
Shi Jun 2006.10.23	Shi Jun 2006.10.23	Shi Jun 2006.01.16	Shi Jun 2006.01.16
UNIT: mm		Tolerance	
SCALE: NONE		X. ±0.50	
SHEET: 01/01		X.X ±0.30	
REV: D		X.XX ±0.10	
		X* ±1*	