

4

3

2

1

THIS DRAWING IS UNPUBLISHED. RELEASED FOR PUBLICATION
 © COPYRIGHT - By - ALL RIGHTS RESERVED.

LOC	DIST	REVISIONS			
P	LTR	DESCRIPTION	DATE	DWN	APVD
	A2	REVISED PER ECO-11-005027	11MAR11	RK	HMR

MATERIALS:
 HOUSING: PA66, UL94V-0, COLOR: GREEN.
 CONTACT: PHOS BRONZE, TIN PLATED.
 WIRE GUARD: STEEL, ZINC CHROMATE.
 CAGE CLAMP: STEEL, ZINC CHROMATE.
 SCREW: STEEL, ZINC PLATED.

ELECTRICAL:
 VOLTAGE RATING: 300V.
 CURRENT RATING: 16A.
 INSULATION RESISTANCE 2000Mohm/DC500V.
 WITHSTANDING VOLTAGE AC2000V MIN
 WIRE RANGE: 14-24 AWG

MECHANICAL:
 SCREW TORQUE: 7.0 IN-LB
 WIRE STRIP LENGTH: 10mm

ENVIRONMENTAL:
 WORKING TEMP.: -40°C TO +105°C.

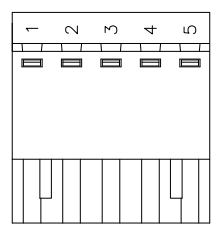

2-1986484-5

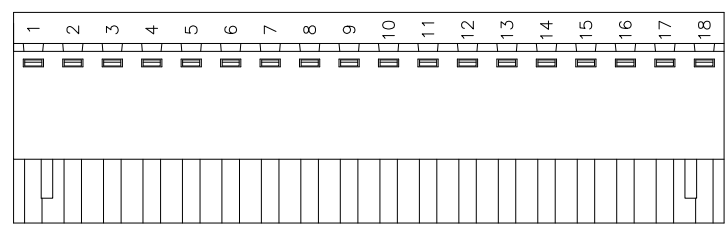

2-1986484-6

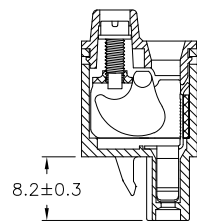
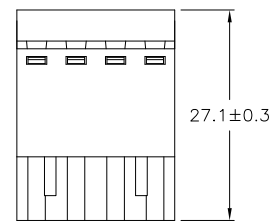
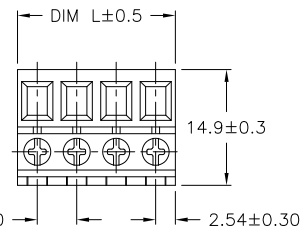

SEE DETAIL	△	DIM L	NO OF POS	PART NUMBER
△	1	121.92±0.5	24	2-1986484-4
△	1	116.84±0.5	23	2-1986484-3
△	1	111.76±0.5	22	2-1986484-2
△	1	106.68±0.5	21	2-1986484-1
△	1	101.60±0.5	20	2-1986484-0
△	1	96.52±0.5	19	1-1986484-9
△	2	91.44±0.5	18	2-1986484-6
△	1	91.44±0.5	18	1-1986484-8
△	1	86.36±0.5	17	1-1986484-7
△	1	81.28±0.5	16	1-1986484-6
△	1	76.20±0.5	15	1-1986484-5
△	1	71.12±0.5	14	1-1986484-4
△	1	66.04±0.5	13	1-1986484-3
△	1	60.96±0.5	12	1-1986484-2
△	1	55.88±0.5	11	1-1986484-1
△	1	50.80±0.5	10	1-1986484-0
△	1	45.72±0.5	9	1986484-9
△	1	40.64±0.5	8	1986484-8
△	1	35.56±0.5	7	1986484-7
△	1	30.48±0.5	6	1986484-6
△	1	25.40±0.5	5	2-1986484-5
△	1	25.40±0.5	5	1986484-5
△	1	20.32±0.5	4	1986484-4
△	1	15.24±0.5	3	1986484-3
△	1	10.16±0.5	2	1986484-2

- 1 PRELIMINARY PART NUMBER
- 2 PART MARKED WITH BLACK PERMANENT MARKING

THIS DRAWING IS A CONTROLLED DOCUMENT.		DWN S SCHLEGEL 17NOV2008	TE Connectivity TERMINAL BLOCK, PLUG, 5.08mm PITCH	
DIMENSIONS: mm		CHK C RICHARD 11/17/08		
TOLERANCES UNLESS OTHERWISE SPECIFIED:		APVD C RICHARD 11/17/08	NAME	
0 PLC ± - 1 PLC ± 0.2 2 PLC ± 0.10 3 PLC ± - 4 PLC ± - ANGLES ± 1°		PRODUCT SPEC		
MATERIAL		APPLICATION SPEC		
FINISH		WEIGHT		
		SIZE A3	CAGE CODE 00779	DRAWING NO C=1986484
		CUSTOMER DRAWING		RESTRICTED TO
		SCALE NTS	SHEET 1 of 1	REV A2