

DATE: 06/27/2007 BY: PACE ELECTRONICS CORPORATION ALL RIGHTS RESERVED

REV	DATE	DESCRIPTION	BY	CHK	APP
00					
01					
02					
03					
04					
05					
06					
07					
08					
09					
10					
11					
12					
13					
14					
15					
16					
17					
18					
19					
20					
21					
22					
23					
24					

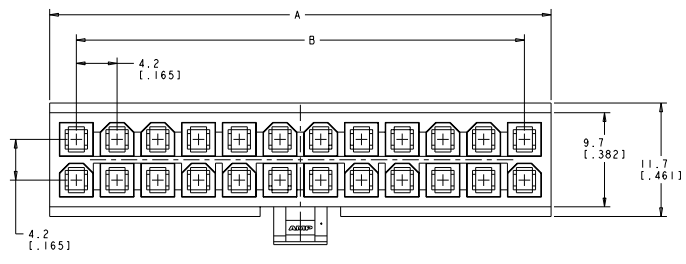

- △ NYLON, UL94V-0, NATURAL.
- 2. DIMENSIONS IN BRACKETS ARE IN INCHES.
- 3. FEMALE CONTACTS MUST BE INSERTED SO THAT THE TOP OF THE WIRE AND INSULATION CRIMPS ARE FACING THE CIRCUIT NUMBER OF THE POSITION INTO WHICH IT IS BEING INSERTED OR 180° FROM THE CIRCUIT NUMBER FOR THAT POSITION.

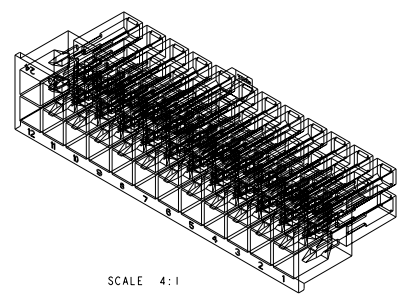
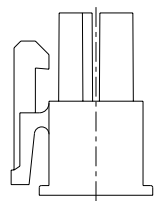
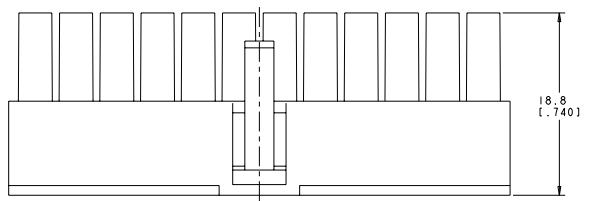

SCALE 4:1

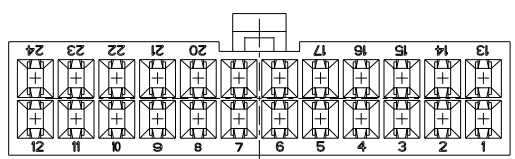

4032.2	24	46.2(1.82)	51.7(2.04)	2-794657-4
3717.6	22	42(1.65)	47.5(1.87)	2-794657-2
3403	20	37.8(1.49)	43.3(1.7)	2-794657-0
3088.5	18	33.6(1.32)	39.1(1.54)	1-794657-8
2774	16	29.4(1.16)	34.9(1.37)	1-794657-6
2459.5	14	25.2(0.99)	30.7(1.21)	1-794657-4
2144.9	12	21(0.83)	26.5(1.04)	1-794657-2
1830.4	10	16.8(0.66)	22.3(0.88)	1-794657-0
1515.9	8	12.6(0.5)	18.1(0.71)	794657-8
1201.3	6	8.4(0.33)	13.9(0.55)	794657-6
886.8	4	4.2(0.17)	9.7(0.38)	794657-4
575.1	2	0(0)	5.5(0.22)	794657-2
VOLUME mm ³	NO OF POSITIONS	B	A±0.2(.01)	PART NUMBER

DATE: 06/27/2007 BY: PACE ELECTRONICS CORPORATION ALL RIGHTS RESERVED	DATE: 27JUN2007 BY: PACE ELECTRONICS CORPORATION ALL RIGHTS RESERVED	AMP Incorporated Harrisburg, PA 17105-3600
METRIC	RECEPTACLE HOUSING, 2 TO 24 POSITION, AMP-DUACTM POWER CONNECTOR	STATE CASE CODE (SEE PAGE 40) REPT: A 00779 ©-794657
CUSTOMER DRAWING	SHEET: 1 OF 1	DRAWN BY:



AMP 000 REV 2/2000
Pace ENGINEER DRAWING