

4

3

2

1

THIS DRAWING IS UNPUBLISHED. RELEASED FOR PUBLICATION. ALL RIGHTS RESERVED.

| LOC | DIST | REVISIONS | | | |
|-----|------|-----------|---------------------------|---------|--------|
| | | REV | DESCRIPTION | DATE | BY |
| CM | 53 | P2 | REVISED PER ECO-11-004917 | 11MAR11 | RK HMR |

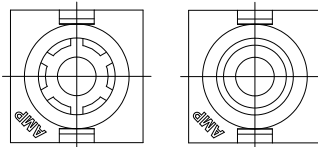
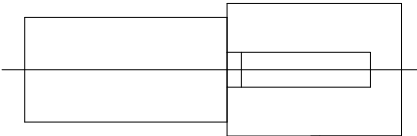
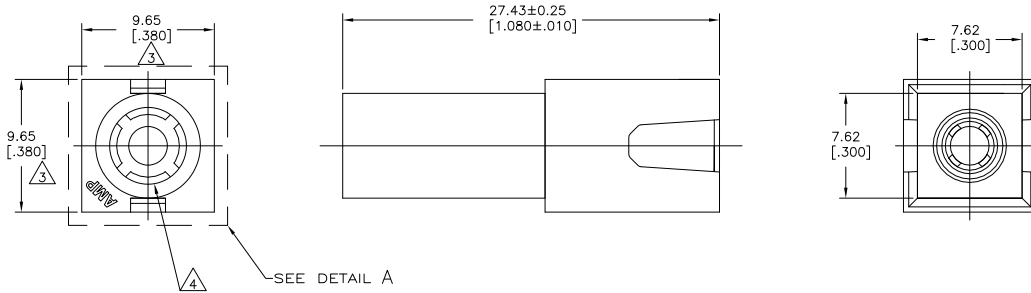

DETAIL A
OPTIONAL CONSTRUCTIONS

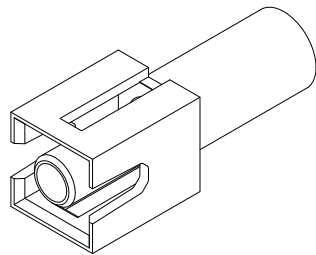

3-DIMENSIONAL MODEL
NTS

- 1 MATES WITH HOUSING 350865.
- 2 DIMENSIONS IN BRACKETS ARE IN INCHES.
- 3 DIMENSION INDICATED IS AS MOLDED. ADDITIONAL GROWTH DUE TO SUBSEQUENT MOISTURE ABSORPTION MAY OCCUR.
- 4 FOUR RIBS EQUALLY SPACED, NO SPECIFIC ORIENTATION. NO RIBS OR SIX RIBS EQUALLY SPACED, NO SPECIFIC ORIENTATION, OPTIONAL.

| | |
|-------|----------|
| RED | 350866-2 |
| - | 350866-1 |
| COLOR | PART NO. |



| | | | |
|--|-----------------|--------------------|-------------------------------|
| THIS DRAWING IS A CONTROLLED DOCUMENT. | | DRW K. WHITAKER | 8-12-91 |
| DIMENSIONS: mm [INCHES] | | CHK D. SWING | 8-12-91 |
| TOLERANCES UNLESS OTHERWISE SPECIFIED: | | APPD D. SELF | 8-12-91 |
| 0 PLG | ± | PRODUCT SPEC | |
| 1 PLG | ± | APPLICATION SPEC | |
| 2 PLG | ± | WEIGHT | |
| 3 PLG | ± 0.13 (0.005) | FINISH | |
| 4 PLG | ± | | |
| ANGLES | ± | | |
| MATERIAL | NYLON, UL 94V-0 | SIZE | A2 |
| | | CAGE CODE | 00779 |
| | | DRAWING NO | C=350866 |
| | | RESTRICTED TO | |
| | | CUSTOMER DRAWING | SCALE 5:1 SHEET 1 of 1 REV P2 |

TE Connectivity

CAP, SINGLE CIRCUIT,
UNIVERSAL MATE-N-LOK™