

4

3

2

1

THIS DRAWING IS UNPUBLISHED. RELEASED FOR PUBLICATION
 © COPYRIGHT - BY TYCO ELECTRONICS CORPORATION. ALL RIGHTS RESERVED.

LOC	DIST	REVISIONS					
FT	0	P	LTR	DESCRIPTION	DATE	DWN	APVD
		O2		REVISED PER ECO-09-016882	21JUL09	HMR	CR

MATERIAL:
 HOUSING: POLYIMIDE 6 UL94V-2.
 COLOR: NATURAL (OFF WHITE).
 TUBULAR CONTACT: BRASS, TIN PLATED.
 SCREW: SEE TABLE
 WIRE PROTECTOR: STAINLESS STEEL

ELECTRICAL:
 CURRENT RATING: 65A, 600V.
 WIRE RANGE: 6-14 UL AND 6-22 AWG FOR (CSA)
 CONTINUOUS WORKING TEMP.: 100°C MAX.

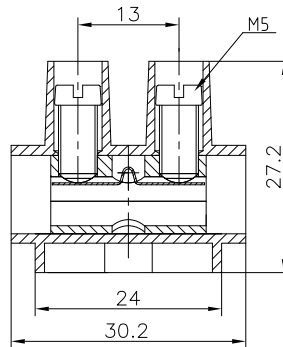
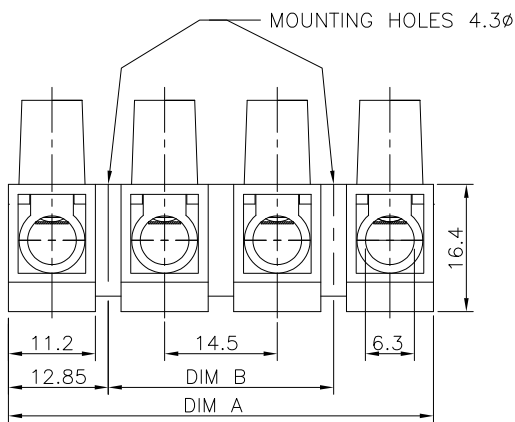

NICKEL PLATED BRASS	14.5	40.2	TSB200003KDS	2-1776315-3
NICKEL PLATED BRASS	-	25.7	TSB200002KDS	2-1776315-2
TRIVALENT ZINC PLATED STEEL	145	170.7	TSB200012KDS	1-1776315-2
TRIVALENT ZINC PLATED STEEL	130.5	156.2	TSB200011KDS	1-1776315-1
TRIVALENT ZINC PLATED STEEL	116	141.7	TSB200010KDS	1-1776315-0
TRIVALENT ZINC PLATED STEEL	101.5	127.2	TSB200009KDS	1776315-9
TRIVALENT ZINC PLATED STEEL	87	112.7	TSB200008KDS	1776315-8
TRIVALENT ZINC PLATED STEEL	72.5	98.2	TSB200007KDS	1776315-7
TRIVALENT ZINC PLATED STEEL	58	83.7	TSB200006KDS	1776315-6
TRIVALENT ZINC PLATED STEEL	43.5	69.2	TSB200005KDS	1776315-5
TRIVALENT ZINC PLATED STEEL	29	54.7	TSB200004KDS	1776315-4
TRIVALENT ZINC PLATED STEEL	14.5	40.2	TSB200003KDS	1776315-3
TRIVALENT ZINC PLATED STEEL	-	25.7	TSB200002KDS	1776315-2
TRIVALENT ZINC PLATED STEEL	-	11.2	TSB200001KDS	1776315-1
SCREW MATERIAL	DIM B	DIM A	T & B PART NUMBER	TE PART NUMBER

THIS DRAWING IS A CONTROLLED DOCUMENT.

DWN S SCHLEGEL 3/21/05

CHK C RICHARD 3/21/05

APVD C RICHARD 3/21/05

NAME

PRODUCT SPEC

APPLICATION SPEC

WEIGHT

CUSTOMER DRAWING

Tyco Electronics Corporation Harrisburg, Pa 17105-3608	
14.5MM PITCH WIRE PROTECTOR 65A HIGH VOLTAGE VERSION	
SIZE A.3	CAGE CODE 00779
DRAWING NO. 1776315	RESTRICTED TO
SCALE NTS	SHEET 1 OF 1
REV 02	

DIMENSIONS:	TOLERANCES UNLESS OTHERWISE SPECIFIED:
mm	
0 PLC	± -
1 PLC	± 0.3
2 PLC	± 0.25
3 PLC	± -
4 PLC	± -
ANGLES	± 2°
MATERIAL	FINISH
-	-