

NOTES:

1. MATERIAL: SEE TABLE
2. FINISHES: SEE TABLE
3. INCH DIMENSIONS ARE IN BRACKETS (XXX).
4. REFER TO SD-38120-001 FOR IMPRINTING OPTIONS 10A AND 11A.
5. REFER TO SD-38120-007 FOR IMPRINTING OPTION 12A.
6. 'XX' REFERS TO THE QUANTITY OF CIRCUITS.
7. ALL COMPONENTS ARE ROHS COMPLIANT.

11	XX	#6-32 WRDY W/WASH SCR (-47,-50)	STEEL	ZN, CLEAR CHROMATE
10	XX	#6-32 PH/SLOT WRDY SCR (OPT -47)	STEEL	ZN, CLEAR CHROMATE
9	XX	#6-32 SLOTTED SCREW (OPT -56)	STAINLESS STEEL	PASSIVATE
8	XX	#6-32 SLOTTED SCREW (OPT -45)	STEEL	ZN, CLEAR CHROMATE
7	XX	#6-32 PH/SL W/WASH SCR (-49,-50)	BRASS	NICKEL
6	XX	#6-32 PH/SL W/WASH SCR (OPT -50)	STEEL	ZN, CLEAR CHROMATE
5	XX	#6-32 PH/SLOTTED SCREW (OPT -49)	BRASS	NICKEL
4	XX	#6-32 PH/SLOTTED SCREW (STD)	STEEL	ZN, CLEAR CHROMATE
3	2	MOUNTING PLATE	BRASS	NICKEL
2	XX	TERMINAL	BRASS	BRT.TIN/CU
1	1	INSULATOR, SINGLE ROW	PBT	BLACK
ITEM	QTY.	DESCRIPTION	MATERIAL	FINISH

ADD MAT. NO. EC NO: ETC2007-0166 DRAWN BY: DRW:NYK 2006/10/19 CHECKED BY: JAC:ELL 2006/10/20 APPR: JAC:ELL 2006/10/20	QUALITY SYMBOLS ▽=0 ▽=0	GENERAL TOLERANCES (UNLESS SPECIFIED)		DIMENSION STYLE MM/IN	SCALE 2:1	DESIGN UNITS INCH	THIRD ANGLE PROJECTION
		4 PLACES ± --- ± --- 3 PLACES ± --- ± .005 2 PLACES ± 0.13 ± .01 1 PLACE ± 0.3 ± --- ANGULAR ± 2 °	DRAWN BY W. HOWARD 2003/10/16 CHECKED BY R. KEMP 2003/10/16 APPROVED BY P. WALTZ 2003/10/16	DATE 2003/10/16 2003/10/16 2003/10/16	TITLE 9.53MM [.375] SR BTS, PC ASSY	MOLEX INCORPORATED	DOCUMENT NO. SD-38720-001
DRAFT WHERE APPLICABLE MUST REMAIN WITHIN DIMENSIONS		MATERIAL NO. SEE SHT. 2		THIS DRAWING CONTAINS INFORMATION THAT IS PROPRIETARY TO MOLEX INCORPORATED AND SHOULD NOT BE USED WITHOUT WRITTEN PERMISSION			

MATERIAL NO. (OPT 12A)	MATERIAL NO. (OPT 11A)	MATERIAL NO. (OPT 10A)	MATERIAL NO. (OPT -59)	MATERIAL NO. (OPT -58)	MATERIAL NO. (OPT -56)	MATERIAL NO. (OPT -50)	MATERIAL NO. (OPT -49,-50)	MATERIAL NO. (OPT -49)	MATERIAL NO. (OPT -47,-50)	MATERIAL NO. (STD)	NUMBER OF CIRCUITS *XX*
		38729-1039		38729-0750	38729-0659	38729-7402	38729-1381	38729-6802		38729-6201	01
		38729-0014			38729-0791	38729-7403				38729-6202	02
38729-0872	38729-0025	38729-0940	38729-0945		38729-0839	38729-7404	38729-1159	38729-6803	38729-8603	38729-6203	03
38729-0256		38729-0346			38729-1253	38729-7405	38729-1382	38729-6804		38729-6204	04
			38729-0400	38729-0386	38729-0980	38729-7406	38729-1383	38729-6805		38729-6205	05
			38729-0423	38729-0407	38729-0435	38729-0420		38729-6806		38729-6206	06
38729-0497					38729-0508	38729-7407		38729-6807		38729-6207	07
					38729-0560	38729-7408		38729-6808		38729-6208	08
					38729-1011	38729-7409		38729-6809		38729-6209	09
			38729-0598		38729-0532	38729-7410		38729-6810		38729-6210	10
						38729-7411				38729-6211	11
					38729-1252	38729-7412		38729-6812		38729-6212	12
					38729-0809	38729-7413				38729-6213	13
					38729-0004	38729-7414		38729-6814		38729-6214	14
										38729-6215	15
										38729-6216	16
										38729-6217	17
										38729-6218	18
										38729-6219	19
										38729-6220	20
										38729-6221	21
										38729-6222	22
										38729-6223	23
										38729-6224	24
										38729-6225	25
										38729-6226	26

NUMBER OF CIRCUITS *XX*	DM. 'A'	DM. 'B'	DM. 'C'	DM. 'D'
01	30.7	121	-	19.1
02	40.1	158	9.53	28.6
03	49.7	196	19.05	38.1
04	59.2	233	28.58	47.6
05	68.7	271	38.10	57.2
06	78.2	308	47.63	66.7
07	87.8	346	57.15	76.2
08	97.3	383	66.68	85.7
09	106.8	421	76.20	95.3
10	116.3	458	85.73	104.8
11	125.9	496	95.25	114.3
12	135.4	533	104.78	123.8
13	144.9	571	114.30	133.4
14	154.4	608	123.83	142.9
15	164.0	646	133.35	152.4
16	173.5	683	142.88	161.9
17	183.0	721	152.40	171.5
18	192.5	758	161.93	181.0
19	202.1	796	171.45	190.5
20	211.6	833	180.98	200.0
21	221.1	871	190.50	209.6
22	230.6	908	200.03	219.1
23	240.2	946	209.55	228.6
24	249.7	983	219.08	238.1
25	259.2	1021	228.60	247.7
26	268.7	1058	238.13	257.2

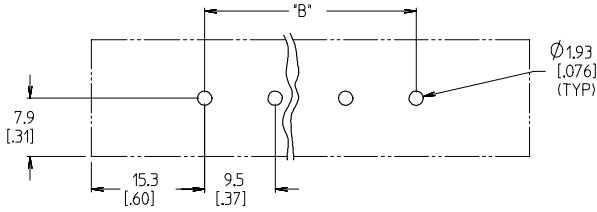

PTH PATTERN

SEE SHEET 1 EC NO: ETC2007-0166 DRAWN BY: CHYCKE MACNEIL CHECKED BY: CHYCKE MACNEIL APPR: JMACNEIL 2006/10/19 2006/10/20 2006/10/20	QUALITY SYMBOLS	GENERAL TOLERANCES (UNLESS SPECIFIED)	DIMENSION STYLE	SCALE	DESIGN UNITS	THIRD ANGLE PROJECTION
	$\nabla=0$ $\sphericalangle=0$	mm INCH 4 PLACES ± --- ± --- 3 PLACES ± --- ± .005 2 PLACES ± 0.13 ± .01 1 PLACE ± 0.3 ± --- ANGULAR ± 2 °	MM/IN	2:1	INCH	
	DRAFT WHERE APPLICABLE MUST REMAIN WITHIN DIMENSIONS					
			DRAWN BY: W. HOWARD CHECKED BY: R. KEMP APPROVED BY: P. WALTZ DATE: 2003/10/16 DATE: 2003/10/16 DATE: 2003/10/16		TITLE: 9.53MM [.375] SR BTS, PC ASSY	
			MATERIAL NO. SEE CHART DOCUMENT NO. SD-38720-001		MOLEX INCORPORATED	STEEL NO. 2 OF 2
			THIS DRAWING CONTAINS INFORMATION THAT IS PROPRIETARY TO MOLEX INCORPORATED AND SHOULD NOT BE USED WITHOUT WRITTEN PERMISSION			