

THIS DRAWING IS UNPUBLISHED. RELEASED FOR PUBLICATION .19  
 © COPYRIGHT 19 BY AMP INCORPORATED. ALL RIGHTS RESERVED.

| LOC | DIST | REVISIONS                |         |     |      |
|-----|------|--------------------------|---------|-----|------|
| P   | LTR  | DESCRIPTION              | DATE    | DWN | APVD |
| D   |      | REVISED PER OS1D-0099-00 | 07NOV00 | AH  | KK   |

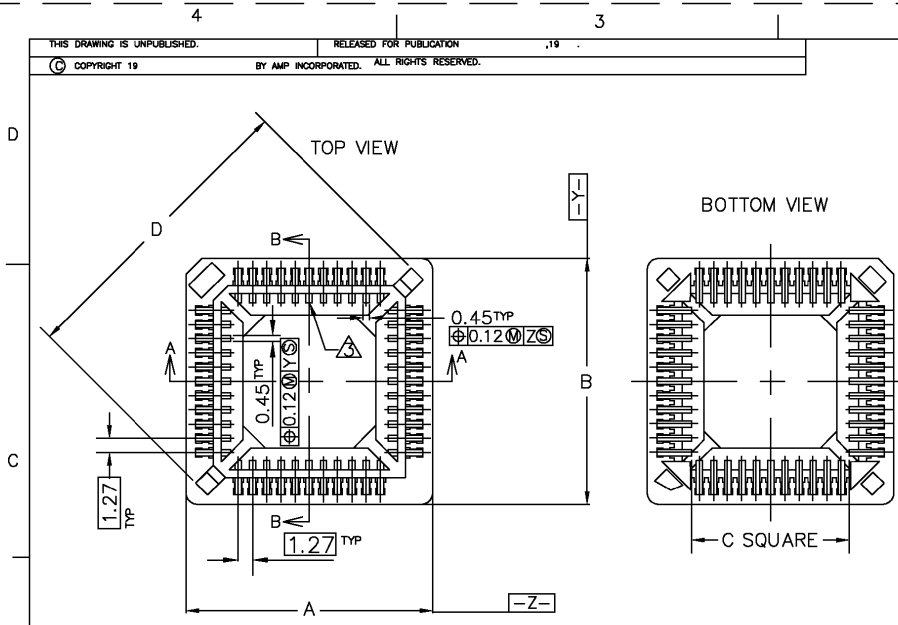

- △ MATERIAL:  
 HOUSING--HIGH TEMPERATURE THERMOPLASTIC, UL94V-0, COLOR: BROWN.  
 CONTACT--PHOSPHOR BRONZE.  
 △ CONTACT FINISH: PLATE 0.00254 MIN. 90/10 TIN-LEAD OVER 0.00127 MIN. NICKEL ; ALL OVER.  
 △ PIN #1  
 △ VIA HOLES NOT RECOMMENDED WITHIN SOCKET SHADOW AREA.
- CURRENT RATING: 1 AMP.
  - VOLTAGE RATING: 250V.
  - CONTACT RESISTANCE: 20 MILLIOHMS, MAXIMUM.
  - INSULATION RESISTANCE: 5,000 MEGOHMS, MINIMUM, INITIAL.
  - DIELECTRIC WITHSTANDING VOLTAGE: 600 VAC RMS, MINIMUM.
  - OPERATING TEMPERATURE: -55 TO +105 C.
  - DURABILITY: 25 CYCLES.
  - PLCC DEVICE MUST CONFORM TO JEDEC MS-018.

44 POSITION SHOWN

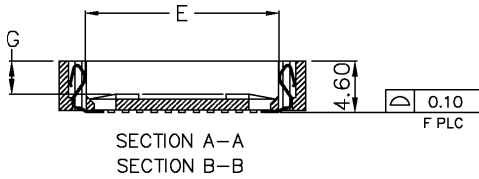

| G    | F  | E     | D     | C     | B     | A     | Part Status | Packaging | AMP P/N    |
|------|----|-------|-------|-------|-------|-------|-------------|-----------|------------|
| 2.75 | 20 | 9.36  | 16.38 | 6.71  | 14.36 | 14.36 | Released    | Tape      | 3-822499-3 |
| 2.75 | 20 | 9.36  | 16.38 | 6.71  | 14.36 | 14.36 | Released    | Tubes     | 822499-3   |
| 2.75 | 28 | 11.90 | 20.00 | 9.25  | 16.90 | 16.90 | Released    | Tape      | 3-822499-2 |
| 2.75 | 28 | 11.90 | 20.00 | 9.25  | 16.90 | 16.90 | Released    | Tubes     | 822499-2   |
| 2.95 | 44 | 16.99 | 27.20 | 14.33 | 22.00 | 22.00 | Released    | Tape      | 3-822499-1 |
| 2.95 | 44 | 16.99 | 27.20 | 14.33 | 22.00 | 22.00 | Released    | Tubes     | 822499-1   |

THIS DRAWING IS A CONTROLLED DOCUMENT.

|                  |  |                  |           |   |
|------------------|--|------------------|-----------|---|
| DIMENSIONS:      | TOLERANCES UNLESS OTHERWISE SPECIFIED: | DWN              | 21FEB00   | AMP Incorporated<br>Harrisburg, PA 17105-3608 |
| MM               | 0 PLC ± -                              | CHK              | 15FEB00   |   |
| ⊕                | 1 PLC ± -                              | APVD             | 15FEB00   |   |
|                  | 2 PLC ± -                              | NAME             |           |   |
|                  | 3 PLC ± 0.2                            | K. KREIDLER      |           | PLCC SURFACE MOUNT                            |
|                  | 4 PLC ± -                              | PRODUCT SPEC     |           |   |
|                  | ANGLES ± -                             | APPLICATION SPEC |           |   |
| MATERIAL         | FINISH                                 | WEIGHT           |           | SIZE CAGE CODE DRAWING NO RESTRICTED TO       |
| △                | △                                      |                  |           | A3 00779 C=822499 -                           |
| CUSTOMER DRAWING |  |                  | SCALE 3:1 | SHEET 1 OF 2 REV D                            |

AMP 1470-19 REV 23FEB95

07NOV00 7:00am omp12184

THIS DRAWING IS UNPUBLISHED. RELEASED FOR PUBLICATION .19  
 © COPYRIGHT 19 BY AMP INCORPORATED. ALL RIGHTS RESERVED.

|     |      |           |     |             |      |     |      |
|-----|------|-----------|-----|-------------|------|-----|------|
| LOC | DIST | REVISIONS |     |             |      |     |      |
| GP  | 00   | P         | LTR | DESCRIPTION | DATE | DWN | APVD |
|     |      | D         |     | SEE SHEET 1 | -    | -   | -    |

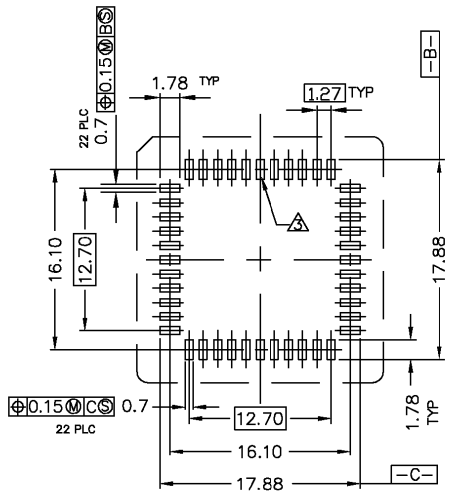

44 POSITION  
822499-1 AND 3-822499-1

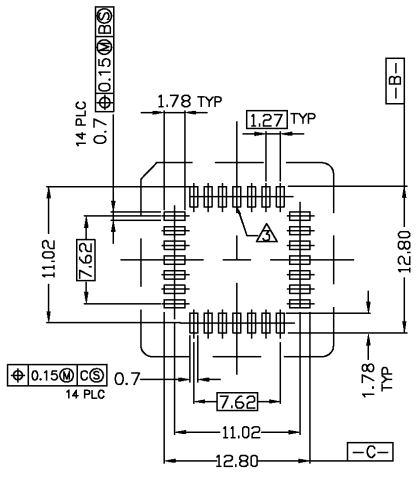

28 POSITION  
822499-2 AND 3-822499-2

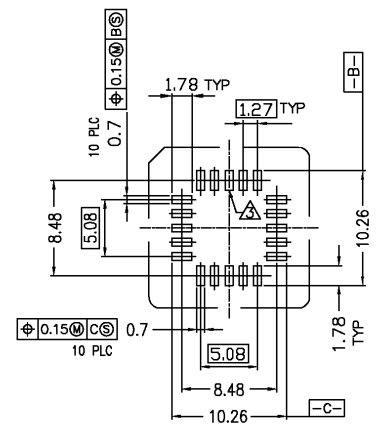

20 POSITION  
822499-3 AND 3-822499-3

RECOMMENDED PCB FOOTPRINTS

|  |  |                                |   |               |
|--|--|--------------------------------|---|---------------|
| THIS DRAWING IS A CONTROLLED DOCUMENT. |  | DWN<br>A. HOLT<br>20MAR00      | AMP Incorporated<br>Harrisburg, PA 17105-3608 |               |
| DIMENSIONS:<br>MM                      | TOLERANCES UNLESS OTHERWISE SPECIFIED: | CHK<br>K. KREIDLER<br>20MAR00  | NAME  |               |
|  |  | APVD<br>K. KREIDLER<br>20MAR00 | PLCC SURFACE MOUNT                            |               |
| MATERIAL                               | FINISH                                 | PRODUCT SPEC                   | SIZE  | CAGE CODE     |
|  |  | APPLICATION SPEC               | A3  | 00779         |
|  |  | WEIGHT                         | DRAWING NO                                    | RESTRICTED TO |
|  |  | CUSTOMER DRAWING               | C=822499                                      | -             |
|  |  |                                | SCALE   | SHEET         |
|  |  |                                | 3:1   | 2 OF 2        |
|  |  |                                | REV   | D             |