

- NOTES:
1. DIMENSIONS GIVEN ACROSS CENTERLINES ARE SYMMETRICAL ABOUT THOSE CENTERLINES WITHIN HALF THE TOTAL TOLERANCE.
  2. MATERIAL: NYLON 6/6, 94V-2, NATURAL COLOR.
  3. THIS PRODUCT COMPLIES WITH MOLEX PRODUCT SPECIFICATION PS-08-50.
  4. FINISH: PER ES-88 (909) \* OVERALL HOT TIN DOP: .00254 MICROMETERS MIN.

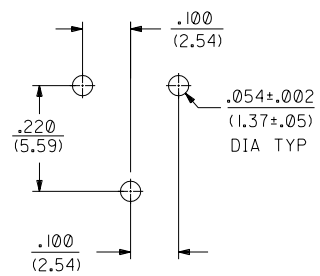

PC BOARD HOLE LAYOUT (.062 THK.)  
 DIMENSIONAL TOLERANCE ±.004/(.10)  
 UNLESS OTHERWISE NOTED

\*THE PRIMARY SHIPPING CARTON WILL BE LABELED "COMPLIANT TO RoHS DIRECTIVE 2002/95/EC AND ELV ANNEX II OF DIRECTIVE 2002/53/EC". CARTONS WITHOUT THIS LABEL MAY CONTAIN PRODUCT WITH TIN-LEAD PLATING.

EDP NO.	ENG. NO.	HOUSING NO.	TERMINAL NO.	DIM. C
09-48-3031	A-2512-3	2512-3-5	2144-A IAA-(P909)B	.145 (3.68)

DIMENSIONS SHOWN (METRIC) INCH		▽ = 0   ▼ = 0   REVISE ONLY ON CAD SYSTEM	
UNLESS OTHERWISE SPECIFIED TOLERANCES: ANGULAR ± 1/2°			
INCH		METRIC	
3 PLACE	± .010	---	
2 PLACE	± .014	± 0.25	
1 PLACE	---	± 0.36	
DRAFT WHERE APPLICABLE MUST REMAIN WITHIN DIMENSIONS			
DRWG. BY: JJS	CHK'D. BY: PATEL	FILE NAME: S2512X1	
APP'D. BY: LENZ	SCALE: :	THIS DRAWING CONTAINS INFORMATION THAT IS PROPRIETARY TO MOLEX INC. AND SHOULD NOT BE USED WITHOUT WRITTEN PERMISSION.	
TITLE: TRANSISTOR SOCKET .200 CENTERS FOR P.C. TAIL TERMINALS		MOLEX INCORPORATED LITTLE ROCK, AR 60932 U.S.A.	
PART NO. SDA-2512		SHEET NO. 1 OF 1 DATE 3/21/94	
SEE CHART		DRWG. NO. SDA-2512	
LTR. REVISIONS		DIV. C SIZE B	