

REV. NO.		DESCRIPTION	DATE	BY	APP'D
AD	00				
E4		REVISED PER ECO-11-004587	11MAR11	RK	HMR

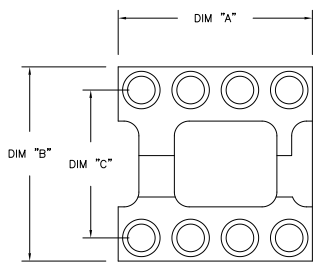

FIG. 1

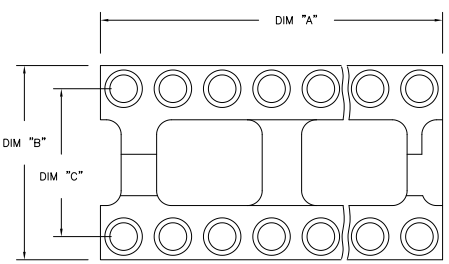

FIG. 2

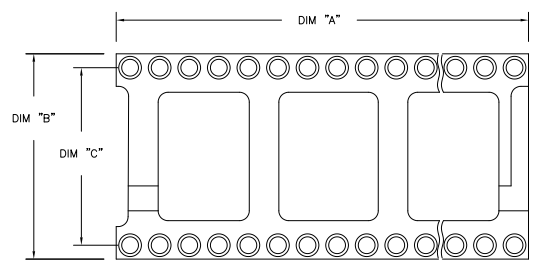
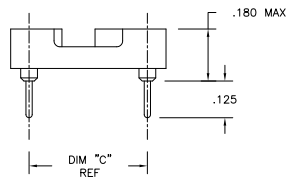
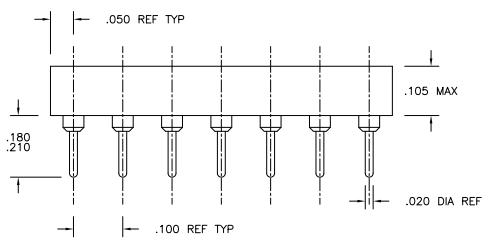
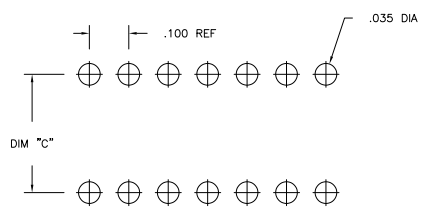

FIG. 3



- 1. INSULATOR MATERIAL - THERMOPLASTIC POLYESTER, PCT, BLACK, UL94 V-0
- △ STAMPED CONTACT - BECU, PLATED WITH 80-200.1" TIN (LEAD FREE) OVER 75-100.1" COPPER.
- △ SLEEVE - COPPER, PLATED WITH 180-340.1" THK TIN (LEAD FREE) OVER 75-125μ" MIN NICKEL.
- △ STAMPED CONTACT-BECU, PLATED WITH GOLD FLASH OVER 50-100.1" NICKEL
- △ STAMPED CONTACT-BECU, PLATED WITH 20μ" MIN GOLD OVER 30-100.1" NICKEL.
- △ ELECTRICAL:
  - CONTACT RESISTANCE: 10 MILLIOHMS MAX
  - CONTACT RATING: 3 AMPS
  - CAPACITANCE: 1.0 pF PER MIL-STD-202, METHOD 305
  - INSULATION RESISTANCE: 5000 OHMS MIN @ 500 VDC PER MIL-STD-1344, METHOD 3003.1
  - DIELECTRIC WITHSTANDING VOLTAGE: 1000 VOLTS (RMS) PER MIL-STD-1344, METHOD 3001.1
- △ MECHANICAL:
  - INSERTION FORCE: 179 GRAMS AVG
  - WITHDRAWAL FORCE: 63 GRAMS AVG
  - \*ACCEPTS IC PIN - .009"X.015" THROUGH .011"X.020", OR .016" TO .021" DIAMETER, .150/.105 LONG"
- △ ENVIRONMENTAL:
  - OPERATING TEMPERATURE: -55°C TO +105°C
- △ OBSOLETE PARTS: OBSOLETE CIS STREAMLINING PER D.RENAUD/D.SINISI



P.C.B. HOLE LAYOUT  
 TOLERANCE ±.003

THIS DRAWING IS A CONTROLLED DOCUMENT.		REV. NO.	00	DATE	11MAR11
DRAWN BY		DESIGNED BY	DATE	TE Connectivity	
CHECKED BY		DATE	OPEN FRAME DIP ECONOMY (STAMPED CONTACT) (REF AUGAT 800 SERIES)		
APPROVED BY		DATE	SIZE	DATE	ISSUED TO
SEE NOTES		SEE NOTES	A1	00779	1571552
CUSTOMER DRAWING		DATE	4.1	REV	1 2 E4

THIS DRAWING IS UNAPPROVED FOR FABRICATION ALL RIGHTS RESERVED

REV	DATE	DESCRIPTION	BY	CHK	APP
AD	00	SEE SHEET 1	-	-	-

REV	DATE	DESCRIPTION	BY	CHK	APP					
△△△	△	OBsolete	GOLD	TIN	.400±.005	.500	1.200	2	24	5-1571552-7
△△△	△		GOLD	TIN	.300±.005	.400	1.200	2	24	5-1571552-6
△△△	△		GOLD	TIN	.900±.005	1.000	3.200	3	64	5-1571552-5
△△△	△		GOLD	TIN	.600±.005	.700	2.400	3	48	5-1571552-4
△△△	△		GOLD	TIN	.600±.005	.700	2.100	3	42	5-1571552-3
△△△	△		GOLD	TIN	.600±.005	.700	2.000	3	40	5-1571552-2
△△△	△		GOLD	TIN	.600±.005	.700	1.800	3	36	5-1571552-1
△△△	△		GOLD	TIN	.600±.005	.700	1.600	3	32	5-1571552-0
△△△	△		GOLD	TIN	.600±.005	.700	1.400	2	28	4-1571552-9
△△△	△		GOLD	TIN	.600±.005	.700	1.200	2	24	4-1571552-8
△△△	△		GOLD	TIN	.400±.005	.500	1.100	2	22	4-1571552-7
△△△	△		GOLD	TIN	.300±.005	.400	1.000	2	20	4-1571552-6
△△△	△		GOLD	TIN	.300±.005	.400	.900	2	18	4-1571552-5
△△△	△		GOLD	TIN	.300±.005	.400	.800	2	16	4-1571552-4
△△△	△		GOLD	TIN	.300±.005	.400	.700	2	14	4-1571552-3
△△△	△		GOLD	TIN	.300±.005	.400	.600	2	12	4-1571552-2
△△△	△	OBsolete	G F	TIN	.400±.005	.500	1.200	2	24	3-1571552-7
△△△	△		G F	TIN	.300±.005	.400	1.200	2	24	3-1571552-6
△△△	△		G F	TIN	.900±.005	1.000	3.200	3	64	3-1571552-5
△△△	△		G F	TIN	.600±.005	.700	2.400	3	48	3-1571552-4
△△△	△		G F	TIN	.600±.005	.700	2.100	3	42	3-1571552-3
△△△	△		G F	TIN	.600±.005	.700	2.000	3	40	3-1571552-2
△△△	△		G F	TIN	.600±.005	.700	1.800	3	36	3-1571552-1
△△△	△		G F	TIN	.600±.005	.700	1.600	3	32	3-1571552-0
△△△	△		G F	TIN	.600±.005	.700	1.400	2	28	2-1571552-9
△△△	△		G F	TIN	.600±.005	.700	1.200	2	24	2-1571552-8
△△△	△		G F	TIN	.400±.005	.500	1.100	2	22	2-1571552-7
△△△	△		G F	TIN	.300±.005	.400	1.000	2	20	2-1571552-6
△△△	△		G F	TIN	.300±.005	.400	.900	2	18	2-1571552-5
△△△	△		G F	TIN	.300±.005	.400	.800	2	16	2-1571552-4
△△△	△		G F	TIN	.300±.005	.400	.700	2	14	2-1571552-3
△△△	△		G F	TIN	.300±.005	.400	.600	2	12	2-1571552-2
△△△	△		TIN	TIN	.400±.005	.500	1.200	2	24	1-1571552-7
△△△	△		TIN	TIN	.300±.005	.400	1.200	2	24	1-1571552-6
△△△	△	OBsolete	TIN	TIN	.900±.005	1.000	3.200	3	64	1-1571552-5
△△△	△	OBsolete	TIN	TIN	.600±.005	.700	2.400	3	48	1-1571552-4
△△△	△	OBsolete	TIN	TIN	.600±.005	.700	2.100	3	42	1-1571552-3
△△△	△	OBsolete	TIN	TIN	.600±.005	.700	2.000	3	40	1-1571552-2
△△△	△	OBsolete	TIN	TIN	.600±.005	.700	1.800	3	36	1-1571552-1
△△△	△		TIN	TIN	.600±.005	.700	1.600	3	32	1-1571552-0
△△△	△		TIN	TIN	.600±.005	.700	1.400	2	28	1571552-9
△△△	△		TIN	TIN	.600±.005	.700	1.200	2	24	1571552-8
△△△	△	OBsolete	TIN	TIN	.400±.005	.500	1.100	2	22	1571552-7
△△△	△		TIN	TIN	.300±.005	.400	1.000	2	20	1571552-6
△△△	△		TIN	TIN	.300±.005	.400	.900	2	18	1571552-5
△△△	△		TIN	TIN	.300±.005	.400	.800	2	16	1571552-4
△△△	△		TIN	TIN	.300±.005	.400	.700	2	14	1571552-3
△△△	△		TIN	TIN	.300±.005	.400	.600	2	12	1571552-2

FINISH CONTACT/SLEEVE	"C" MAX	"B" MAX	"A" MAX	FIG	NO. OF POSN	PART NO.

THIS DRAWING IS A CONTROLLED DOCUMENT. DATE: 01/01/00

TE Connectivity

TE OPEN FRAME DIP ECONOMY (STAMPED CONTACT) (REF AUGAT 800 SERIES)

REV: 001 DATE: 01/01/00 DRAWN BY: A1 007791G-1571552

CUSTOMER DRAWING