

THIS DRAWING IS UNPUBLISHED. RELEASED FOR PUBLICATION. ALL RIGHTS RESERVED.

LOC	DIST	REVISIONS					
AD	0	F	LTR	DESCRIPTION	DATE	OWN	APD
		M1		REVISED PER ECO-11-004587	11MAR11	RK	HMR

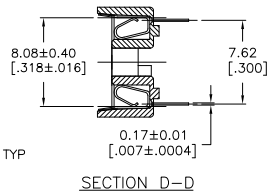
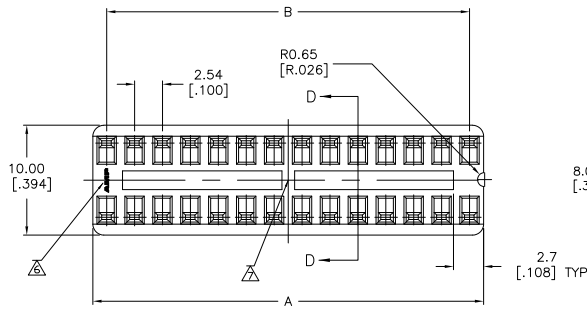

NOTE:

- 1 MATERIAL:
HOUSING: 30% GLASS FILLED PBT, THERMOPLASTIC, BLACK.
CONTACT: PHOS BRONZE.
- 2 FINISH: CONTACT PLATING: TIN-LEAD (60u INCHES MIN.)
SOLDERABILITY :95% COVERAGE MIN.;
TEST TEMPERATURE=230°C±5°C
TEST TIME = 5±5 SECONDS.
3. MECHANICAL SPECS:
DURABILITY: 50 CYCLES MIN.
INSERTION FORCE:300 GRAMS MAX.
WITHDRAWAL FORCE: 20 GRAMS MIN.
CONTACT RETENTION: 500 GRAMS MIN.
ACCEPTS: 0.20-0.30 [.008-.012] LEADS
4. ELECTRICAL SPECS:
VOLTAGE RATING: 250V AC,DC
CONTACT RESISTANCE: 20 MILLOHMS MAX.
CURRENT RATING: 1 AMPERE AC,DC
INSULATION RESISTANCE: 1000 MEGOHMS MIN.
DIELECTRIC WITHSTANDING VOLTAGE: AC 1000 V MIN.
OPERATING TEMPERATURE: -40°C TO +105°C
- 5 AMP LOGO
- 6 LADDER PRESENT FOR 24, 28 & 32 POSITION SOCKETS.
- 7 FINISH: CONTACT PLATING TIN (LEAD FREE); 60 UIN MIN. OVER 30 UIN NI
SOLDERABILITY :95% COVERAGE MIN.;
TEST TEMPERATURE=260°±5°C;
TEST TIME = 5±5 SECONDS.

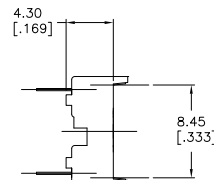
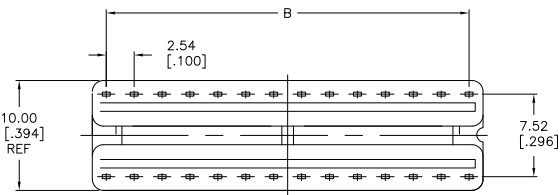
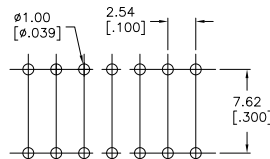
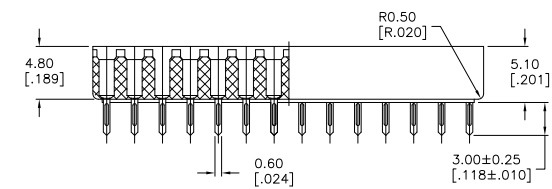

FINISH	POS	A	±0.20 [.008]	B	±0.15 [.006]	PART NO.
△	32	40.64	[1.600]	38.10	[1.500]	2-390261-0
△	28	35.56	[1.400]	33.02	[1.300]	1-390261-9
△	24	30.48	[1.200]	27.94	[1.100]	1-390261-8
△	22	27.94	[1.100]	25.40	[1.000]	1-390261-7
△	20	25.40	[1.000]	22.86	[.900]	1-390261-6
△	18	22.86	[.900]	20.32	[.800]	1-390261-5
△	16	20.32	[.800]	17.78	[.700]	1-390261-4
△	14	17.78	[.700]	15.24	[.600]	1-390261-3
△	8	10.16	[.400]	7.62	[.300]	1-390261-2
△	6	7.62	[.300]	5.08	[.200]	1-390261-1
△	32	40.64	[1.600]	38.10	[1.500]	1-390261-0
△	28	35.56	[1.400]	33.02	[1.300]	390261-9
△	24	30.48	[1.200]	27.94	[1.100]	390261-8
△	22	27.94	[1.100]	25.40	[1.000]	390261-7
△	20	25.40	[1.000]	22.86	[.900]	390261-6
△	18	22.86	[.900]	20.32	[.800]	390261-5
△	16	20.32	[.800]	17.78	[.700]	390261-4
△	14	17.78	[.700]	15.24	[.600]	390261-3
△	8	10.16	[.400]	7.62	[.300]	390261-2
△	6	7.62	[.300]	5.08	[.200]	390261-1

SUPERSEDED BY 2-390261-0
 SUPERSEDED BY 1-390261-9
 SUPERSEDED BY 1-390261-8
 SUPERSEDED BY 1-390261-7
 SUPERSEDED BY 1-390261-6
 SUPERSEDED BY 1-390261-5
 SUPERSEDED BY 1-390261-4
 SUPERSEDED BY 1-390261-3
 SUPERSEDED BY 1-390261-2
 SUPERSEDED BY 1-390261-1

THIS DRAWING IS A CONTROLLED DOCUMENT. DWG: 08SEP2004

DIMENSIONS: mm [INCHES]	TOLERANCES UNLESS OTHERWISE SPECIFIED	DATE	BY	CHK
0 PLG ± .02	0 PLG ± .02	DATE	BY	CHK
1 PLG ± .02	1 PLG ± .02	DATE	BY	CHK
2 PLG ± .02	2 PLG ± .02	DATE	BY	CHK
3 PLG ± .02	3 PLG ± .02	DATE	BY	CHK
ANGLES ± .02	ANGLES ± .02	DATE	BY	CHK

MATERIAL: △

FINISH: △

TE Connectivity
 DIP SOCKET, .300 CENTER LINE
 LADDER STYLE

SIZE: CASE CODE: DRAWING NO: A2 00779 C=390261

RESTRICTED TO: -

CUSTOMER DRAWING SCALE: 4:1 SHEET 1 of 1 REV: M1