

DESCRIPTION: 2MM SHUNT LOW PROFILE, .075" TIN/LEAD

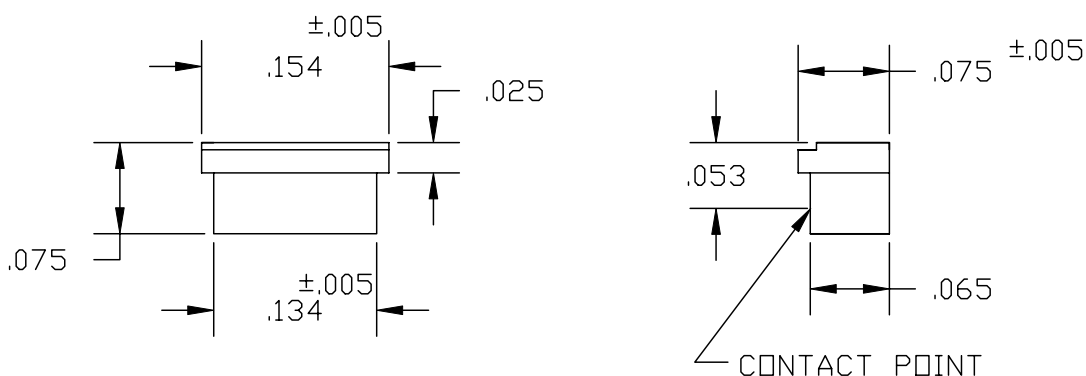

MATERIAL: HOUSING: GLASS FILLED THERMOPLASTIC, UL 94V-0, BLACK- 260°C PROCESS TEMP.

CONTACT: HIGH PERFORMANCE COPPER ALLOY

PLATING: TIN/LEAD ALL OVER

RoHS COMPLIANT

ELECTRICALS: CURRENT RATING: 1.0 AMPERE MAX.

CONTACT RESISTANCE: 30 MILLIOHM MAX.

DMV: 500 V_{rms} MIN.

INSULATION RESISTANCE: 1 X 10⁴ MOHMS

OPERATING TEMP: -55°C TO 105°C



THESE DRAWINGS AND SPECIFICATIONS ARE THE PROPERTY OF NorComp AND SHALL NOT BE REPRODUCED, COPIED OR USED AS THE BASIS FOR THE MANUFACTURE OF SALE OF APPARATUS WITHOUT WRITTEN PERMISSION.

DRAWN:
PAM JENKINS

DATE:
12-13-01

CHECKED:

DATE:

NorComp

SCALE: SHEET 1 OF 1 REV 1

DWG NO. 810-002-LP1R006