

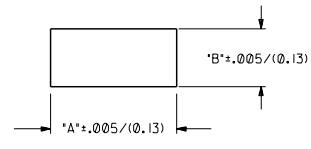

PLUG		
PART NO.	ENG. NO.	
03-12-2026	42179-2P1	
03-12-2025	42179-2P	
03-12-7021	42179-2PBK	<b>OBSOLETE</b>
03-12-7022	42179-2PIRD	<b>OBSOLETE</b>

RECEPTACLE		
PART NO.	ENG. NO.	
03-12-1026	42179-2R1	
03-12-6021	42179-2RIBK	<b>OBSOLETE</b>
03-12-6022	42179-2RIRD	<b>OBSOLETE</b>

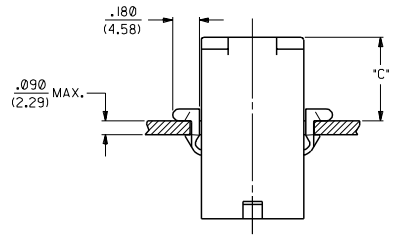

RECOMMENDED HOLE CUTOUT

HOUSING	DIM. "A"	DIM. "B"	DIM. "C"
PLUG	.851/(21.62)	.440/(11.18)	.57/(14.5)

**LEGEND:**

42179-2\*\*\*\*-\*

CIRCUIT SIZE: \_\_\_\_\_

HOUSING TYPE: \_\_\_\_\_

P = PLUG

R = RECEPTACLE

MOUNTING EAR OPTION: \_\_\_\_\_

BLANK = WITH PREBENT EARS, PLUG ONLY

I = WITHOUT EARS

COLOR: \_\_\_\_\_

BLANK = 94V-2; TRANSLUCENT NATURAL COLOR

AM=AMBER BK=BLACK BU=BLUE

BN=BROWN GY=GRAY GN=GREEN

OR=ORANGE RD=RED YW=YELLOW

MATERIAL: \_\_\_\_\_

BLANK = NYLON 6/6, U.L. 94V-2

**NOTES:**

- PART ACCEPTS A MAXIMUM .250/(6.35) INSULATION DIA.
- FOR USE WITH MOLEX .125/(3.17) DIAMETER SERIES TERMINALS EXCEPT THE 1219/1220 SERIES.
- THIS PART IS THE SAME AS 42348-2 EXCEPT FOR POLARIZATION OF FIRST CIRCUIT.

		F2	SEE SHEET I	DIMENSIONS SHOWN IN METRIC INCH		▽ = 0 ▽ = 0		REVISE ONLY ON CAD SYSTEM	
		F1	SEE SHEET I	UNLESS OTHERWISE SPECIFIED		TITLE		.125/(3.17) HOUSING, PLUG AND RECEPTACLE, 2 CKT., .330/(8.38) CTR.	
		F	SEE SHEET I	TOLERANCES ANGULAR 1/2° TO 1°		INCH METRIC		MOLEX INCORPORATED	
		D	SEE SHEET I			2 PLACE ± .007 ---		SHEET NO. 3	
		H	SEE SHEET I			1 PLACE ± .010 ± 0.18		DATE 7/26/88	
		G1	SEE SHEET I			1 PLACE --- ± 0.25		PART NO. SD-42179-2*	
		G	SEE SHEET I			DRAFT WHERE APPLICABLE MUST REMAIN WITHIN DIMENSIONS		DRAWING NO. 68532	
		LTR.	REVISIONS			DRAWN BY GEP		SEE CHART	
		LTR.	REVISIONS			CHECKED BY RW		SD-42179-2*	
						APPROVED BY RAS		SCALE 2 : 1	
						FILE NAME 5421792X3		THIS DRAWING CONTAINS INFORMATION THAT IS PROPRIETARY TO MOLEX INC. AND SHOULD NOT BE USED WITHOUT WRITTEN PERMISSION.	
						SHEET 3		CP C	

42179

A

NO P.S.1