

4

3

2

1

THIS DRAWING IS UNPUBLISHED. RELEASED FOR PUBLICATION BY TYCO ELECTRONICS CORPORATION. ALL RIGHTS RESERVED. COPYRIGHT 20

REVISIONS				
P	LYR	DESCRIPTION	DATE	BY
A		NEW RELEASE	22OCT2008	CR DO

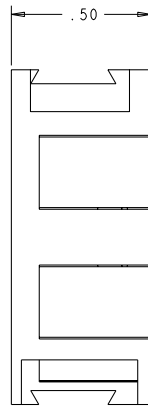
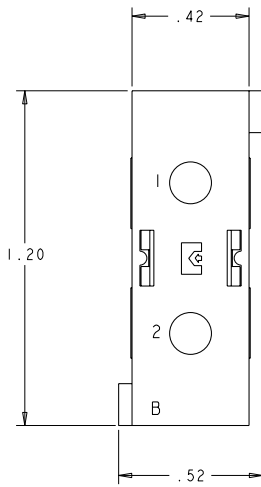

- PART NUMBER CHANGES AND/OR DESIGN CHANGES AFFECTING INTERCHANGEABILITY REQUIRE PRIOR TYCO ELECTRONICS APPROVAL AND AUTHORIZATION BY REVISION TO THIS DRAWING
- ITEMS PROVIDED TO THIS SPECIFICATION TO BE PERMANENTLY IDENTIFIED PER THE FOLLOWING IDENTIFIER LABEL

YEAR  WEEK

TYCO ELECTRONICS P/N      DATE CODE (e.g. 0106)

XXXXXXX-X                  XXXX

**ELCON**    **DOMINO**

AS SHOWN		1648462-1	
DESCRIPTION		PART NO.	
<small>TOP DIMENSIONS CONTROLLING DIMENSIONS UNLESS OTHERWISE SPECIFIED</small> <small>ALL DIMENSIONS IN INCHES UNLESS OTHERWISE SPECIFIED</small>		DWN C. ROHLER 22OCT2008 CBY D. OBRIS 22OCT2008 APTR M. PERCHERKE 22OCT2008 PRODUCT SPEC APPLICATION SPEC WEIGHT MATERIAL FINISH	
DIMENSIONS: INCHES 0 PLC ±.01 1 PLC ±.02 2 PLC ±.010 3 PLC ±.02 4 PLC ±.01 ANGLES ±.5		Tyco Electronics Harrisburg, PA 17105-3608 NAME HOUSING, PIN, MODULE B, MODIFIED DOMINO SIZE CASE CODE DRAWING NO. RESTRICTED TO A200779 ©=1648462 SCALE 4:1 SHEET 1 OF 1 REV A	
CUSTOMER DRAWING			