

4

3

2

1

THIS DRAWING IS UNPUBLISHED. RELEASED FOR PUBLICATION
 BY TYCO ELECTRONICS CORPORATION. ALL RIGHTS RESERVED.

LOC	DIST	REVISIONS					
FT	0	P	L/R	DESCRIPTION	DATE	MIN	APPRO
		J		REVISED PER 0638-0178-05	4/19/05	SS	GS

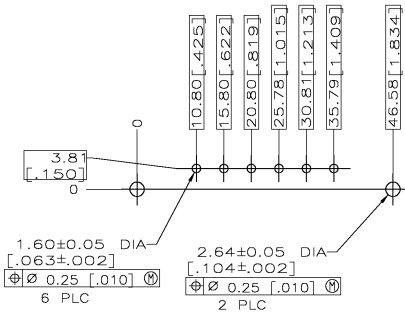
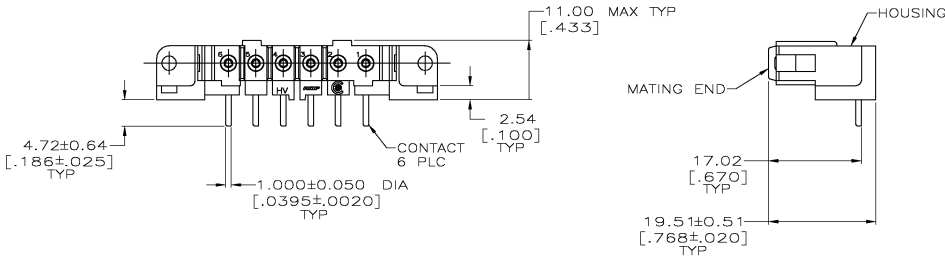
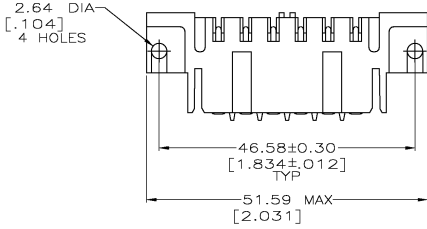

RECOMMENDED PC BOARD LAYOUT

- △ 3.81um [.000150] MIN TIN-LEAD OVER 0.76um [.000030] MIN NICKEL.
- △ 0.76um [.000030] MIN GOLD FOR A LENGTH OF 5.08 [.200] MIN FROM MATING END, 3.81um [.000150] MIN TIN-LEAD FOR A LENGTH OF 5.23 [.206] MIN FROM OPPOSITE END, BOTH OVER 1.27um [.000050] MIN NICKEL.
- △ 3.81um [.000150] MIN TIN OVER 0.76um [.000030] MIN NICKEL.
- △ 0.76um [.000030] MIN GOLD FOR A LENGTH OF 5.08 [.200] MIN FROM MATING END, 3.81um [.000150] MIN TIN FOR A LENGTH OF 5.23 [.206] MIN FROM OPPOSITE END, BOTH OVER 1.27um [.000050] MIN NICKEL.

△	207610-7
△	207610-6
△	207610-3
△	207610-1
CONTACT FINISH	PART NUMBER

THIS DRAWING IS A CONTROLLED DOCUMENT.		DATE: 06/06/92	Tyco Electronics Corporation	
DRAWN: L. SIEPE		CHK: B-11-92	Harrisburg, Pa 17105-3608	
DESIGNED: M. MCCLINTON		APP: B-11-92	Tyco Electronics	
DIMENSIONS: INCHES		PROJECT: 108-10033	SOCKET HEADER ASSEMBLY, 6 POSN, IN-LINE, METRIMATE	
TOLERANCES UNLESS OTHERWISE SPECIFIED:		APPLICATION SPEC: -	SHEET: A2	
0 PLC ± .005	1 PLC ± .005	HEIGHT: -	CASE CODE: 00779	DRAWING NO: 207610
2 PLC ± .005	3 PLC ± .005	FINISH: -	RESTRICTED TO: -	
4 PLC ± .005	5 PLC ± .005	ANGLES: -	SCALE: 2:1	
6 PLC ± .005	FINISH: -	CONTACTS: SEE TBL	SHEET: 1 OF 1	
MATERIAL: HSG: NYLON, RED		CUSTOMER DRAWING	REV: J	