

REV.	DATE	DESCRIPTION	BY	CHKD	APPD
A1	-	NEW DRAWING
A2	-	FOR B18 1890-140 AND B18 1890-120
A3	-	UPDATE DRAWING
A4	-	ACTIVATED

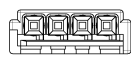
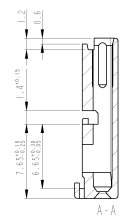
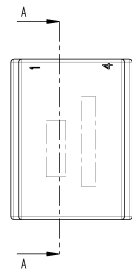
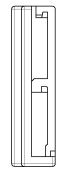
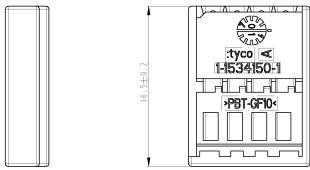
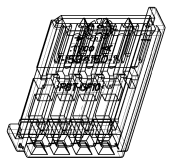
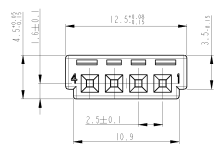

Bemerkungen

- Verwendet mit Verriegelung 1534149
- Gegenstecker nach Zeichnung 114-18491
- Passende Kontakte 1355217 (ØGB 0.14 - 0.22 mm²)
 928998 (ØGB 0.20 - 0.50 mm²)
 963715 (ØGB 0.75 mm²)
- Passender Gegenstecker 1534156

NOTES

- USED WITH RETAINER 1534149
- MATING PART EXECUTION ACC. TO DRAWING 114-18491
- SUITABLE CONTACTS 1355217 (WIRE RANGE 0.14 - 0.22 mm²)
 928998 (WIRE RANGE 0.20 - 0.50 mm²)
 963715 (WIRE RANGE 0.75 mm²)
- SUITABLE MATING PART 1534156

PARTS PROVIDED, BUT TILL NOW NOT ORDERED !
 Teile vorgesehen, aber noch nicht beauftragt !

1-1534150-1	A	A	1	1	PBT-GF10 BLACK/schwarz	REC. HSG. / Bs.-Geh.
1-1534150-1	A	A	1	1	PBT-GF10 BLACK/schwarz	REC. HSG. / Bs.-Geh.

Tyco Electronics AMP GmbH Buchsengehaeuse, 4 pol., MOS	REC. HSG., 4 POSN., MOS Buchsengehaeuse, 4 pol., MOS
MATERIAL: PBT-GF10 BLACK/schwarz DIMENSIONS: 12.5 x 10.9 x 4.5 mm	CUSTOMER DRAWING: 1-1534150 PART NUMBER: 1-1534150