

三角法 (THIRD ANGLE PROJECTION)

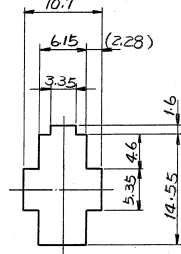
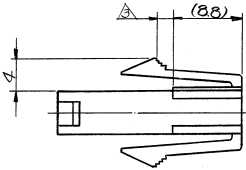
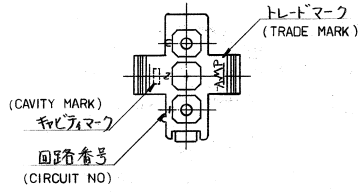
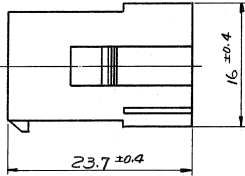
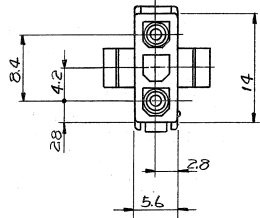

寸法公差は±0.20
(TOLERANCE: ±0.2)
穴取付穴
(DIMENSION OF PANEL)

- NOTES:
1. APPLIED CONTACT P/N: 170359, 170360, 170361, 170362
 2. MATING CONN; PLUG HOUSING P/N 172337
 - △ PANEL THICKNESS: 0.8 ~ 2.0 mm
 4. PRESS DIRECTION OF PANEL MUST BE SAME AS HOUSING INSERTED DIRECTION.
 5. INSTRUCTION SHEET: IS-105J
 6. PRODUCT SPEC: 108-5151
- △ OBSOLETE PARTS: OBSOLETE CIS STREAMLINING PER D.RENAUD/D.SINISI

- 注:
1. 使用端子型番は、170359, 170360, 170361, 170362
 2. 嵌合相手ハウジング型番は、172337
 - △ 適用パネル厚 0.8 ~ 2.0 mm
 4. 取付穴打抜方向とハウジングの挿入方向は同じとする。
 5. 取扱説明書: IS-105J
 6. 適用製品仕様書: 108-5151

黄 (YELLOW)	1- 172329 - 4
黒 (BLACK)	1- - 9
青 (BLUE)	1- - 6
緑 (GREEN)	1- - 5
赤 (RED)	1- - 2
自然色 (NATURAL)	172329 - 1
色 (COLOR)	型番 (P/N)

△ OBSOLETE

A3	REVISED PER ECO-11-005030	RK	HMR	20MAR11
LTR	変更 (REVISION RECORD)	DR	CHK.	DATE

材料 (MATERIAL) 6/6 ナイロン (UL94V-2) (NYLON 6/6 UL94V-2)	一般公差 TOLERANCE ± 0.3 EXCEPT ± 1° AS NOTED	名称 (NAME) MINI-UNIVERSAL MATE-N-LOK CONN. CAP HOUSING 3Pos (UL94V-2)
仕上げ (FINISH) 色: 表参照 HOUSING COLOR: SEE TABLE	DR. <i>R. Yamamoto</i> CHK. <i>K. Taniguchi</i> DE. <i>1/21/81</i> APR.	3極 ミニユニバーサル マテ-N-ロック 型番 サイズ: B, 形状: J, 番号 (NO.): C-172329
	尺 (SCALE) 2:1	REV. A3 SHEET 1

(CUSTOMER DRAWING) 参考図面

単位: 尺 DIMENSIONS IN MM. DO NOT SCALE PRINT