

13 12 11 10 9 8 7 6 5 4 3 2 1

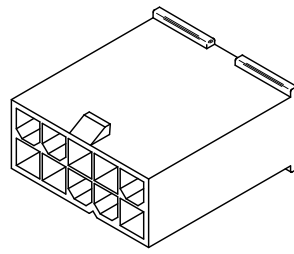

CKT. SIZE	DIM. A	DIM. B
6	.331 (8.40)	.543 (13.80)
8	.496 (12.60)	.709 (18.00)
10	.661 (16.80)	.874 (22.20)
12	.827 (21.00)	1.039 (26.40)
14	.992 (25.20)	1.205 (30.60)
16	1.157 (29.40)	1.370 (34.80)
18	1.323 (33.60)	1.535 (39.00)
20	1.488 (37.80)	1.701 (43.20)
22	1.654 (42.00)	1.866 (47.40)
24	1.819 (46.20)	2.031 (51.60)

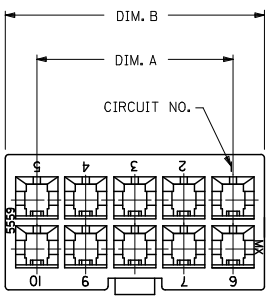
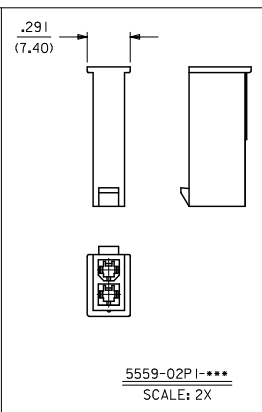
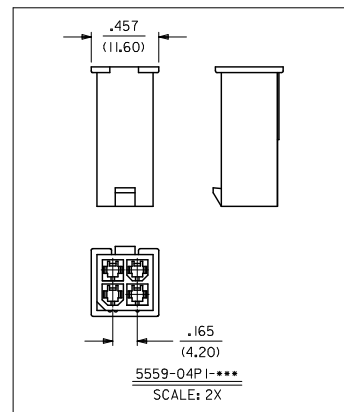
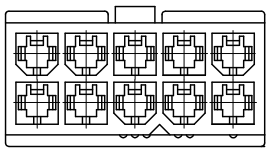
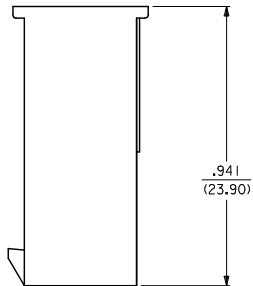
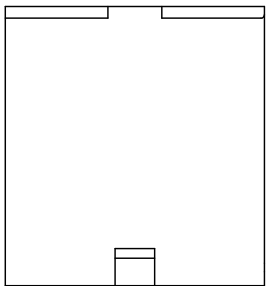

- NOTES:
- MATERIAL: BLANK-NYLON 6/6, UL 94V-2, COLOR: NATURAL
BL-NYLON 6/6, UL94V-2, COLOR: BLACK
210-NYLON 6/6, UL 94V-0, COLOR: NATURAL
220-NYLON 6/6, UL 94V-2, U.V. STABILIZED, COLOR: BLACK
 - FINISH: N/A
 - PRODUCT SPECIFICATION: PS-5556-001
 - PACKAGING SPECIFICATION: SEE CHARTS
 - THIS PART MATES WITH RECEPTACLE #5557
 - THIS PART IS FOR USE WITH MOLEX MALE TERMINAL #5558-*

ADDED PK SPECS EC NO. UCP2009-0724 DRAWN: KLOSTERMAYER 2008/10/01 CHECKED: BELL 2008/10/03 APPROVED: SMITH 2008/10/03	QUALITY SYMBOLS ◻=0 ◻=0	GENERAL TOLERANCES (UNLESS SPECIFIED)		DIMENSION STYLE IN/MM		SCALE 4:1	DESIGN UNITS METRIC	THIRD ANGLE PROJECTION		
		4 PLACES	± .005	± .015	DRAWN BY	DATE	TITLE			
		3 PLACES	± .005	± .015	RJF	1989/09/22	MINI FIT JR SERIES			
		2 PLACES	± 0.38	± .015	BAP	1989/09/22	PLUG W/O MTG. EARS			
1 PLACE	± .005	± .015	APPROVED BY	DATE	MATERIAL NO.		DOCUMENT NO.		SHEET NO.	
ANGULAR ±1/2°		DRAFT WHERE APPLICABLE MUST REMAIN WITHIN DIMENSIONS		SEE CHART		SD-5559-NP1*		1 OF 2		
THIS DRAWING CONTAINS INFORMATION THAT IS PROPRIETARY TO MOLEX INCORPORATED AND SHOULD NOT BE USED WITHOUT WRITTEN PERMISSION										

12 11 10 9 8 7 6 5 4 3 2 1

13	12	11	10	9	8	7	6	5	4	3	2	1
PART NUMBER	ENG. NUMBER	CIRCUIT SIZE	MATERIAL	PACKAGING SPECIFICATION	PART NUMBER	ENG. NUMBER	CIRCUIT SIZE	MATERIAL	PACKAGING SPECIFICATION			
39-01-3023	5559-02P I	2	94V-2	PK-5559-002	39-01-3029	5559-02P I-2 I O	2	94V-0	PK-5559-002			
39-01-3043	5559-04P I	4	94V-2	BULK	39-01-3049	5559-04P I-2 I O	4	94V-0	BULK			
39-01-3063	5559-06P I	6	94V-2	BULK	39-01-3069	5559-06P I-2 I O	6	94V-0	BULK			
39-01-3083	5559-08P I	8	94V-2	BULK	39-01-3089	5559-08P I-2 I O	8	94V-0	BULK			
39-01-3103	5559-10P I	10	94V-2	BULK	39-01-3109	5559-10P I-2 I O	10	94V-0	BULK			
39-01-3123	5559-12P I	12	94V-2	BULK	39-01-3129	5559-12P I-2 I O	12	94V-0	BULK			
39-01-3143	5559-14P I	14	94V-2	BULK	39-01-3149	5559-14P I-2 I O	14	94V-0	BULK			
39-01-3163	5559-16P I	16	94V-2	BULK	39-01-3169	5559-16P I-2 I O	16	94V-0	BULK			
39-01-3183	5559-18P I	18	94V-2	BULK	39-01-3189	5559-18P I-2 I O	18	94V-0	BULK			
39-01-3203	5559-20P I	20	94V-2	BULK	39-01-3209	5559-20P I-2 I O	20	94V-0	BULK			
39-01-3223	5559-22P I	22	94V-2	BULK	39-01-3229	5559-22P I-2 I O	22	94V-0	BULK			
39-01-3243	5559-24P I	24	94V-2	BULK	39-01-3249	5559-24P I-2 I O	24	94V-0	BULK			

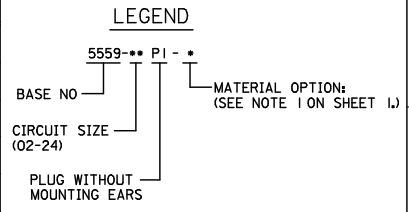

PART NUMBER	ENG. NUMBER	CIRCUIT SIZE	MATERIAL	PACKAGING SPECIFICATION
I5-04-6020	5559-02P I-220	2	94V-2, U.V. STABILIZED	PK-5559-002
NO E.D.P.	5559-04P I-220	4	94V-2, U.V. STABILIZED	BULK
NO E.D.P.	5559-06P I-220	6	94V-2, U.V. STABILIZED	BULK
NO E.D.P.	5559-08P I-220	8	94V-2, U.V. STABILIZED	BULK
NO E.D.P.	5559-10P I-220	10	94V-2, U.V. STABILIZED	BULK
NO E.D.P.	5559-12P I-220	12	94V-2, U.V. STABILIZED	BULK
NO E.D.P.	5559-14P I-220	14	94V-2, U.V. STABILIZED	BULK
NO E.D.P.	5559-16P I-220	16	94V-2, U.V. STABILIZED	BULK
NO E.D.P.	5559-18P I-220	18	94V-2, U.V. STABILIZED	BULK
NO E.D.P.	5559-20P I-220	20	94V-2, U.V. STABILIZED	BULK
NO E.D.P.	5559-22P I-220	22	94V-2, U.V. STABILIZED	BULK
NO E.D.P.	5559-24P I-220	24	94V-2, U.V. STABILIZED	BULK

PART NUMBER	ENG. NUMBER	CIRCUIT SIZE	MATERIAL	PACKAGING SPECIFICATION
39-01-3026	5559-02P I-BL	2	94V-2	PK-5559-002
39-01-3046	5559-04P I-BL	4	94V-2	BULK
39-01-3066	5559-06P I-BL	6	94V-2	BULK
39-01-3086	5559-08P I-BL	8	94V-2	BULK
39-01-3106	5559-10P I-BL	10	94V-2	BULK
39-01-3126	5559-12P I-BL	12	94V-2	BULK
39-01-3146	5559-14P I-BL	14	94V-2	BULK
39-01-3166	5559-16P I-BL	16	94V-2	BULK

ADDED PK SPECS EC NO. UC2009-0724 DRAWN: KLOSTERMEIER 2008/10/01 CHKD: BELL 2008/10/03 APPR: SMITH 2008/10/03	QUALITY SYMBOLS ▽=0 ▽=0	GENERAL TOLERANCES (UNLESS SPECIFIED)		DIMENSION STYLE IN/MM		SCALE 1:1	DESIGN UNITS INCH	THIRD ANGLE PROJECTION		
		4 PLACES ±.005 ±.005	3 PLACES ±.005 ±.005	2 PLACES ±.005 ±.015	1 PLACE ±0.38 ±.005	DRAWN BY RJF	DATE 1989/09/22	TITLE MINI-FIT JR SERIES PLUG W/O MTG. EARS		
		ANGULAR ±1/2°				APPROVED BY BAP	DATE 1989/09/22	MOLEX INCORPORATED		
		DRAFT WHERE APPLICABLE MUST REMAIN WITHIN DIMENSIONS				MATERIAL NO. SEE CHART	DATE 1989/09/22	DOCUMENT NO. SD-5559-NP1*	SHEET NO. 2 OF 2	

THIS DRAWING CONTAINS INFORMATION THAT IS PROPRIETARY TO MOLEX INCORPORATED AND SHOULD NOT BE USED WITHOUT WRITTEN PERMISSION