

THIS DRAWING IS UNPUBLISHED. RELEASED FOR PUBLICATION
 © COPYRIGHT - By - ALL RIGHTS RESERVED.

LOC	DIST	REVISIONS					
FT	60	P	LTR	DESCRIPTION	DATE	DWN	APVD
		B1		REVISED PER ECO-11-004917	11MAR11	RK	HMR

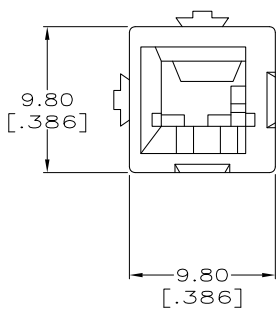
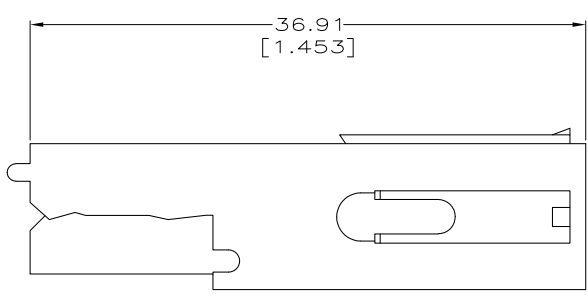

⚠ ALL DIMENSIONS ARE MAXIMUM UNLESS OTHERWISE SPECIFIED.

2. THIS HOUSING IS USED WITH TERMINALS 556135-1,-2 [18-16-14 AWG CU WIRE: (-1) REEL AND (-2) LOOSE PIECE], AND 556136-1,-2 [12 AND 10 AWG CU WIRE: (-1) REEL AND (-2) LOOSE PIECE] AND MOUNTING ADAPTER 557313-1.

GRAY	556137-8
BLUE	556137-6
RED	556137-4
GREEN	556137-3
BLACK	556137-2
WHITE	556137-1
COLOR	PART NUMBER

THIS DRAWING IS A CONTROLLED DOCUMENT.		DWN	M. BINNER	13 MAR 97	TE Connectivity		
		CHK	R. STONE	14 MAR 97			
DIMENSIONS: mm [INCHES]		APVD	M. McALONIS	17 MAR 97	NAME		
TOLERANCES UNLESS OTHERWISE SPECIFIED:		PRODUCT SPEC		HOUSING, SINGLE POSITION, WTW, AMPINNERGY™			
0 PLC	±-	108-1373		APPLICATION SPEC			
1 PLC	±-	114-6051		WEIGHT			
2 PLC	±-			SIZE			
3 PLC	±-			CAGE CODE			
4 PLC	±-			DRAWING NO			
ANGLES	±-			RESTRICTED TO			
MATERIAL: POLYCARBONATE, 94V-0 COLOR: SEE TABLE		FINISH: -		A300779		C=556137	
				CUSTOMER DRAWING		SCALE 4:1 SHEET 1 of 1 REV B1	