

4

3

2

1

THIS DRAWING IS UNPUBLISHED. RELEASED FOR PUBLICATION
 © COPYRIGHT - By - ALL RIGHTS RESERVED.

| LOC | DIST | REVISIONS | | |
|-----|------|---------------------------|---------|--------|
| F | LNK | DESCRIPTION | DATE | BY |
| AD | 00 | | | |
| | V2 | REVISED PER ECO-11-004820 | 11MAR11 | RK HMR |

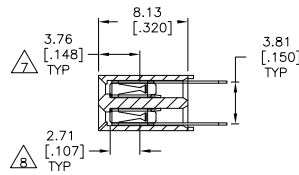
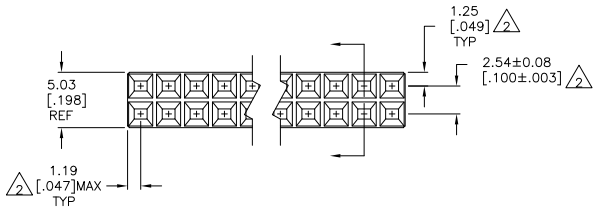
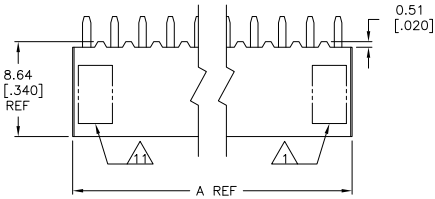

- △ TE CONNECTIVITY LOGO AND CSA LOGO ARE MOLDED INTO THE HOUSING.
- △ TOLERANCE NON-CUMULATIVE.
- △ DUPLEX PLATED: 0.00076 (.000030) GOLD IN CONTACT AREA, .00381-.00762 (.000150-.000300) BRIGHT TIN-LEAD ON LEADS, ALL OVER 0.00127 (.000050) MIN NICKEL.
- △ THESE DIMENSIONS PERTAIN TO CAVITY C/L'S ONLY, NOT TO CONTACT LOCATIONS.
- △ NO PART NUMBER MARKING REQUIRED ON THIS PART NUMBER.
- △ HOUSING: FLAME RETARDANT GLASS FILLED POLYESTER - BLACK. CONTACTS: PHOS. BRONZE.
- △ POINT OF CONTACT DIMENSION.
- △ POINT OF MEASUREMENT FOR PLATING THICKNESS (INSIDE CONTACT BEAMS).
- △ DUPLEX PLATED: 0.00076 (.000030) GOLD DUPLEX IN CONTACT AREA, 0.00381-.00762 (.000150-.000300) MATTE TIN ON LEADS, ALL OVER 0.00127 (.000050) MIN NICKEL.
- △ ROHS 2002/95/EC COMPLIANT
- △ PART NUMBER AND DATE CODE ARE MARKED IN APPROXIMATE LOCATION SHOWN.
- △ OBSOLETE PARTS: OBSOLETE CIS STREAMLINING PER D.RENAUD/D.SINISI

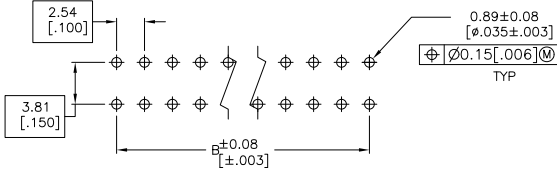

RECOMMENDED HOLE LAYOUT FOR TOP ENTRY

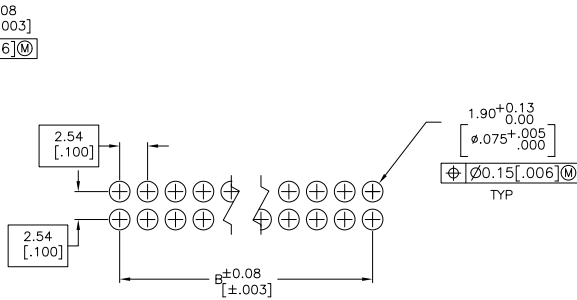

RECOMMENDED HOLE LAYOUT FOR BOTTOM ENTRY OR PASS THROUGH APPLICATIONS

| | | | |
|--|------------|---|--|
| THIS DRAWING IS A CONTROLLED DOCUMENT. | | DR R. BOLES 19-11-92 | |
| | | CHK T. KINSEY 19-11-92 | |
| DIMENSIONS: mm [INCHES] | | APPC - | NAME |
| TOLERANCES UNLESS OTHERWISE SPECIFIED: | | PRODUCT SPEC 108-25026 | ASSEMBLY, MOD II DOUBLE ROW, .100 X .100 C/L, VERTICAL MOUNTED, CLOSED ENTRY, SHORT PT. CONTACTS |
| 0 PLG ± . | 1 PLG ± . | APPLICATION SPEC 114-25018 | RESTRICTED TO |
| 2 PLG ± .005 | 3 PLG ± . | SIZE CAGE CODE (DRAWING NO) A2 00779 C=534236 | |
| 4 PLG ± . | ANGLES ± . | WEIGHT - | |
| MATERIAL | FINISH | CUSTOMER DRAWING | SCALE 4:1 SHEET 1 of 2 REV V2 |

4

3

2

1

THIS DRAWING IS UNPUBLISHED. RELEASED FOR PUBLICATION. ALL RIGHTS RESERVED.

| LOC | DIST | F | LN# | DESCRIPTION | DATE | BY | APPD |
|-----|------|---|-----|-------------|------|----|------|
| AD | 00 | - | - | SEE SHEET 1 | - | - | - |

| FINISH | A | B | NO OF POSN | PART NO. |
|------------|-------|-------|------------|--------------|
| △ OBSOLETE | 1.300 | 1.200 | 26 | △ 9-534236-1 |
| △ OBSOLETE | 4.000 | 3.900 | 80 | △ 9-534236-0 |
| △ OBSOLETE | 3.900 | 3.800 | 78 | △ 8-534236-9 |
| △ OBSOLETE | 3.800 | 3.700 | 76 | △ 8-534236-8 |
| △ OBSOLETE | 3.700 | 3.600 | 74 | △ 8-534236-7 |
| △ OBSOLETE | 3.600 | 3.500 | 72 | △ 8-534236-6 |
| △ OBSOLETE | 3.500 | 3.400 | 70 | △ 8-534236-5 |
| △ OBSOLETE | 3.400 | 3.300 | 68 | △ 8-534236-4 |
| △ OBSOLETE | 3.300 | 3.200 | 66 | △ 8-534236-3 |
| △ OBSOLETE | 3.200 | 3.100 | 64 | △ 8-534236-2 |
| △ OBSOLETE | 3.100 | 3.000 | 62 | △ 8-534236-1 |
| △ OBSOLETE | 3.000 | 2.900 | 60 | △ 8-534236-0 |
| △ OBSOLETE | 2.900 | 2.800 | 58 | △ 7-534236-9 |
| △ OBSOLETE | 2.800 | 2.700 | 56 | △ 7-534236-8 |
| △ OBSOLETE | 2.700 | 2.600 | 54 | △ 7-534236-7 |
| △ OBSOLETE | 2.600 | 2.500 | 52 | △ 7-534236-6 |
| △ OBSOLETE | 2.500 | 2.400 | 50 | △ 7-534236-5 |
| △ OBSOLETE | 2.400 | 2.300 | 48 | △ 7-534236-4 |
| △ OBSOLETE | 2.300 | 2.200 | 46 | △ 7-534236-3 |
| △ OBSOLETE | 2.200 | 2.100 | 44 | △ 7-534236-2 |
| △ OBSOLETE | 2.100 | 2.000 | 42 | △ 7-534236-1 |
| △ OBSOLETE | 2.000 | 1.900 | 40 | △ 7-534236-0 |
| △ OBSOLETE | 1.900 | 1.800 | 38 | △ 6-534236-9 |
| △ OBSOLETE | 1.800 | 1.700 | 36 | △ 6-534236-8 |
| △ OBSOLETE | 1.700 | 1.600 | 34 | △ 6-534236-7 |
| △ OBSOLETE | 1.600 | 1.500 | 32 | △ 6-534236-6 |
| △ OBSOLETE | 1.500 | 1.400 | 30 | △ 6-534236-5 |
| △ OBSOLETE | 1.400 | 1.300 | 28 | △ 6-534236-4 |
| △ OBSOLETE | 1.300 | 1.200 | 26 | △ 6-534236-3 |
| △ OBSOLETE | 1.200 | 1.100 | 24 | △ 6-534236-2 |
| △ OBSOLETE | 1.100 | 1.000 | 22 | △ 6-534236-1 |
| △ OBSOLETE | 1.000 | .900 | 20 | △ 6-534236-0 |
| △ OBSOLETE | .900 | .800 | 18 | △ 5-534236-9 |
| △ OBSOLETE | .800 | .700 | 16 | △ 5-534236-8 |
| △ OBSOLETE | .700 | .600 | 14 | △ 5-534236-7 |
| △ OBSOLETE | .600 | .500 | 12 | △ 5-534236-6 |
| △ OBSOLETE | .500 | .400 | 10 | △ 5-534236-5 |
| △ OBSOLETE | .400 | .300 | 8 | △ 5-534236-4 |
| △ OBSOLETE | .300 | .200 | 6 | △ 5-534236-3 |
| △ OBSOLETE | .200 | .100 | 4 | △ 5-534236-2 |
| △ OBSOLETE | .100 | - | 2 | △ 5-534236-1 |

| FINISH | A | B | NO OF POSN | PART NO. |
|------------|-------|-------|------------|--------------|
| △ OBSOLETE | 1.300 | 1.200 | 26 | △ 4-534236-1 |
| △ OBSOLETE | 4.000 | 3.900 | 80 | △ 4-534236-0 |
| △ OBSOLETE | 3.900 | 3.800 | 78 | △ 3-534236-9 |
| △ OBSOLETE | 3.800 | 3.700 | 76 | △ 3-534236-8 |
| △ OBSOLETE | 3.700 | 3.600 | 74 | △ 3-534236-7 |
| △ OBSOLETE | 3.600 | 3.500 | 72 | △ 3-534236-6 |
| △ OBSOLETE | 3.500 | 3.400 | 70 | △ 3-534236-5 |
| △ OBSOLETE | 3.400 | 3.300 | 68 | △ 3-534236-4 |
| △ OBSOLETE | 3.300 | 3.200 | 66 | △ 3-534236-3 |
| △ OBSOLETE | 3.200 | 3.100 | 64 | △ 3-534236-2 |
| △ OBSOLETE | 3.100 | 3.000 | 62 | △ 3-534236-1 |
| △ OBSOLETE | 3.000 | 2.900 | 60 | △ 3-534236-0 |
| △ OBSOLETE | 2.900 | 2.800 | 58 | △ 2-534236-9 |
| △ OBSOLETE | 2.800 | 2.700 | 56 | △ 2-534236-8 |
| △ OBSOLETE | 2.700 | 2.600 | 54 | △ 2-534236-7 |
| △ OBSOLETE | 2.600 | 2.500 | 52 | △ 2-534236-6 |
| △ OBSOLETE | 2.500 | 2.400 | 50 | △ 2-534236-5 |
| △ OBSOLETE | 2.400 | 2.300 | 48 | △ 2-534236-4 |
| △ OBSOLETE | 2.300 | 2.200 | 46 | △ 2-534236-3 |
| △ OBSOLETE | 2.200 | 2.100 | 44 | △ 2-534236-2 |
| △ OBSOLETE | 2.100 | 2.000 | 42 | △ 2-534236-1 |
| △ OBSOLETE | 2.000 | 1.900 | 40 | △ 2-534236-0 |
| △ OBSOLETE | 1.900 | 1.800 | 38 | △ 1-534236-9 |
| △ OBSOLETE | 1.800 | 1.700 | 36 | △ 1-534236-8 |
| △ OBSOLETE | 1.700 | 1.600 | 34 | △ 1-534236-7 |
| △ OBSOLETE | 1.600 | 1.500 | 32 | △ 1-534236-6 |
| △ OBSOLETE | 1.500 | 1.400 | 30 | △ 1-534236-5 |
| △ OBSOLETE | 1.400 | 1.300 | 28 | △ 1-534236-4 |
| △ OBSOLETE | 1.300 | 1.200 | 26 | △ 1-534236-3 |
| △ OBSOLETE | 1.200 | 1.100 | 24 | △ 1-534236-2 |
| △ OBSOLETE | 1.100 | 1.000 | 22 | △ 1-534236-1 |
| △ OBSOLETE | 1.000 | .900 | 20 | △ 1-534236-0 |
| △ OBSOLETE | .900 | .800 | 18 | △ 534236-9 |
| △ OBSOLETE | .800 | .700 | 16 | △ 534236-8 |
| △ OBSOLETE | .700 | .600 | 14 | △ 534236-7 |
| △ OBSOLETE | .600 | .500 | 12 | △ 534236-6 |
| △ OBSOLETE | .500 | .400 | 10 | △ 534236-5 |
| △ OBSOLETE | .400 | .300 | 8 | △ 534236-4 |
| △ OBSOLETE | .300 | .200 | 6 | △ 534236-3 |
| △ OBSOLETE | .200 | .100 | 4 | △ 534236-2 |
| △ OBSOLETE | .100 | - | 2 | △ 534236-1 |

THIS DRAWING IS A CONTROLLED DOCUMENT.

| | | | |
|----------------------------|---|---|--|
| DIMENSIONS: mm [INCHES] | TOLERANCES UNLESS OTHERWISE SPECIFIED: 0 PLZ ± .01 1 PLZ ± .01 2 PLZ ± .005 3 PLZ ± .005 4 PLZ ± .01 ANGLES ± .1° | DWG R. BOLES 19-11-92 CHK T. KINSEY 19-11-92 DATE PRODUCT SPEC 108-25026 APPLICATION SPEC 114-25018 WEIGHT CUSTOMER DRAWING | TE Connectivity ASSEMBLY, MOD II DOUBLE ROW, .100 X .100 C/L, VERTICAL MOUNTED, CLOSED ENTRY, SHORT PT. CONTACTS SIZE ONE CODE (DRAWING NO) A2 00779 C=534236 RESTRICTED TO SCALE 4:1 SHEET 2 of 2 REV V2 |
|----------------------------|---|---|--|

534236

A