

THIS DRAWING IS UNPUBLISHED  
 © 2005 BY TYS ELECTRONICS CORPORATION. ALL RIGHTS RESERVED.

REV	DATE	DESCRIPTION	BY	CHK	APP
00					
01		REVISED PER ECO-09-024649	DMONVO	HMR	JQ

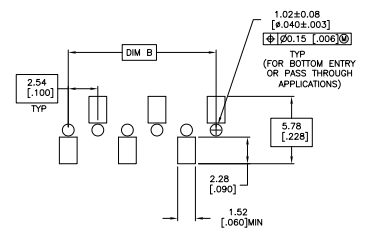
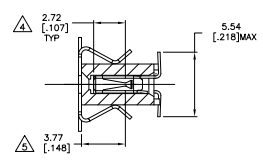
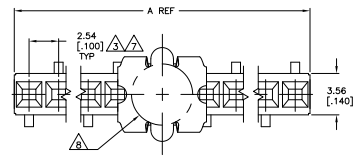
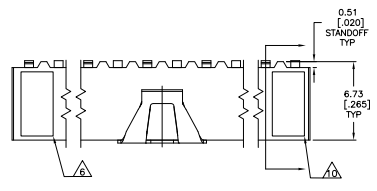

RECOMMENDED PC BOARD PAD PATTERN  
 0.20[0.008] THICK STENCIL

NO	DESCRIPTION	QTY	UNIT	PRICE	TOTAL	REV	DATE	BY	CHK	APP
99.06	3.900	101.6	4.000	40	40	AA	AA	AA	AA	3-147728-9
96.52	3.800	99.06	3.900	39	39	AA	AA	AA	AA	3-147728-8
93.98	3.700	96.52	3.800	38	38	AA	AA	AA	AA	3-147728-7
91.44	3.600	93.98	3.700	37	37	AA	AA	AA	AA	3-147728-6
88.90	3.500	91.44	3.600	36	36	AA	AA	AA	AA	3-147728-5
86.34	3.400	88.90	3.500	35	35	AA	AA	AA	AA	3-147728-4
83.82	3.300	86.34	3.400	34	34	AA	AA	AA	AA	3-147728-3
81.28	3.200	83.82	3.300	33	33	AA	AA	AA	AA	3-147728-2
78.74	3.100	81.28	3.200	32	32	AA	AA	AA	AA	3-147728-1
76.20	3.000	78.74	3.100	31	31	AA	AA	AA	AA	3-147728-0
73.66	2.900	76.20	3.000	30	30	AA	AA	AA	AA	2-147728-9
71.12	2.800	73.66	2.900	29	29	AA	AA	AA	AA	2-147728-8
68.58	2.700	71.12	2.800	28	28	AA	AA	AA	AA	2-147728-7
66.04	2.600	68.58	2.700	27	27	AA	AA	AA	AA	2-147728-6
63.5	2.500	66.04	2.600	26	26	AA	AA	AA	AA	2-147728-5
60.96	2.400	63.5	2.500	25	25	AA	AA	AA	AA	2-147728-4
58.42	2.300	60.96	2.400	24	24	AA	AA	AA	AA	2-147728-3
55.88	2.200	58.42	2.300	23	23	AA	AA	AA	AA	2-147728-2
53.34	2.100	55.88	2.200	22	22	AA	AA	AA	AA	2-147728-1
50.8	2.000	53.34	2.100	21	21	AA	AA	AA	AA	2-147728-0
48.26	1.900	50.8	2.000	20	20	AA	AA	AA	AA	1-147728-9
45.72	1.800	48.26	1.900	19	19	AA	AA	AA	AA	1-147728-8
43.18	1.700	45.72	1.800	18	18	AA	AA	AA	AA	1-147728-7
40.64	1.600	43.18	1.700	17	17	AA	AA	AA	AA	1-147728-6
38.1	1.500	40.64	1.600	16	16	AA	AA	AA	AA	1-147728-5
35.56	1.400	38.1	1.500	15	15	AA	AA	AA	AA	1-147728-4
33.02	1.300	35.56	1.400	14	14	AA	AA	AA	AA	1-147728-3
30.48	1.200	33.02	1.300	13	13	AA	AA	AA	AA	1-147728-2
27.94	1.100	30.48	1.200	12	12	AA	AA	AA	AA	1-147728-1
25.4	1.000	27.94	1.100	11	11	AA	AA	AA	AA	1-147728-0
22.86	.900	25.4	1.000	10	10	AA	AA	AA	AA	147728-9
20.32	.800	22.86	.900	9	9	AA	AA	AA	AA	147728-8
17.78	.700	20.32	.800	8	8	AA	AA	AA	AA	147728-7
15.24	.600	17.78	.700	7	7	AA	AA	AA	AA	147728-6
12.7	.500	15.24	.600	6	6	AA	AA	AA	AA	147728-5
10.16	.400	12.7	.500	5	5	AA	AA	AA	AA	147728-4
7.62	.300	10.16	.400	4	4	AA	AA	AA	AA	147728-3
5.08	.200	7.62	.300	3	3	AA	AA	AA	AA	147728-2
2.54	.100	5.08	.200	2	2	AA	AA	AA	AA	147728-1
OBSOLETE										
EIA TAPE WIDTH	B		A		NO OF POSN	FINISH	PART NUMBER			

THIS DRAWING IS A CONTROLLED DOCUMENT. SEE SECTION 1.1.1 FOR DETAILS.

DESIGNED BY: J. OLSON  
 DRAWN BY: J. OLSON  
 CHECKED BY: J. OLSON  
 DATE: 108-25026  
 SIZE: 114-25018  
 CUSTOMER DRAWING: A100779 (S=147728)

REPT. ASSY., MOD IV, SINGLE ROW, 100 CL.  
 SURFACE MOUNT, VERTICAL, DUAL ENTRY  
 CLOSED ENTRY

DATE: 6.1 SHEET: 1 OF 2

THIS DRAWING IS UNPUBLISHED  
 ALL RIGHTS RESERVED

REV	DATE	DESCRIPTION	BY	CHK	APP
00		SEE SHEET 1			

- △ HOUSING: FLAME RETARDANT, GLASS FILLED, POLYESTER, COLOR: BLACK.  
CONTACT: PHOSPHOR BRONZE  
VACUUM COVER: STAINLESS STEEL
- △ CONTACT: DUPLEX PLATED 0.25μm[.000010] GOLD IN CONTACT AREA, 3.81-7.62μm[.000150-.000300] BRIGHT TIN-LEAD ON LEADS, ALL OVER 1.27μm[.000050] MINIMUM NICKEL
- △ THESE DIMENSIONS PERTAIN TO CAVITY CENTERLINES ONLY NOT TO CONTACT LOCATIONS
- △ POINT OF MEASUREMENT DIMENSION FOR PLATING THICKNESS (INSIDE CONTACT BEAM).
- △ POINT-OF-CONTACT DIMENSION.
- △ TE PART NUMBER AND DATE CODE ARE MARKED IN APPROXIMATE LOCATION SHOWN.
- △ TOLERANCE IS NON-CUMULATIVE.
- △ 5.2[.205] MIN TARGET AREA FOR VACUUM PICK UP. COVER TO BE REMOVED AFTER SOLDERING.
- △ FOR 2 POSITION DATE CODE IS MARKED OPPOSITE SIDE OF TE LOGO.
- △ TE TRADEMARK AND CSA LOGO ARE MOLDED INTO HOUSING.
- △ NO PART NUMBER MARKING REQUIRED ON THIS PART.
- △ CONTACT: DUPLEX PLATED 0.25μm[.000010] GOLD IN CONTACT AREA, 3.81-7.62μm[.000150-.000300] MATTE TIN ON LEADS, ALL OVER 1.27μm[.000050] MINIMUM NICKEL.
- △ ROHS 2002/95/EC COMPLIANT.
- △ OBSOLETE PARTS: OBSOLETE CIS STREAMLINING PER D.RENAUD/D.SINISI

Dimension	Value	Tolerance	Value	Tolerance	Rev	Part No
120mm	99.06	[.3.000]	101.6	[.4.000]	40	8-147728-9
	96.52	[.3.800]	99.06	[.3.900]	39	8-147728-8
	93.98	[.3.700]	96.52	[.3.800]	38	8-147728-7
	91.44	[.3.600]	93.98	[.3.700]	37	8-147728-6
	88.90	[.3.500]	91.44	[.3.600]	36	8-147728-5
	86.34	[.3.400]	88.90	[.3.500]	35	8-147728-4
	83.82	[.3.300]	86.34	[.3.400]	34	8-147728-3
	81.28	[.3.200]	83.82	[.3.300]	33	8-147728-2
	78.74	[.3.100]	81.28	[.3.200]	32	8-147728-1
	76.20	[.3.000]	78.74	[.3.100]	31	8-147728-0
88mm	73.66	[.2.900]	76.20	[.3.000]	30	7-147728-9
	71.12	[.2.800]	73.66	[.2.900]	29	7-147728-8
	68.58	[.2.700]	71.12	[.2.800]	28	7-147728-7
	66.04	[.2.600]	68.58	[.2.700]	27	7-147728-6
	63.5	[.2.500]	66.04	[.2.600]	26	7-147728-5
	60.96	[.2.400]	63.5	[.2.500]	25	7-147728-4
	58.42	[.2.300]	60.96	[.2.400]	24	7-147728-3
	55.88	[.2.200]	58.42	[.2.300]	23	7-147728-2
	53.34	[.2.100]	55.88	[.2.200]	22	7-147728-1
	50.8	[.2.000]	53.34	[.2.100]	21	7-147728-0
72mm	48.26	[.1.900]	50.8	[.2.000]	20	6-147728-9
	45.72	[.1.800]	48.26	[.1.900]	19	6-147728-8
	43.18	[.1.700]	45.72	[.1.800]	18	6-147728-7
	40.64	[.1.600]	43.18	[.1.700]	17	6-147728-6
	38.1	[.1.500]	40.64	[.1.600]	16	6-147728-5
	35.56	[.1.400]	38.1	[.1.500]	15	6-147728-4
	33.02	[.1.300]	35.56	[.1.400]	14	6-147728-3
	30.48	[.1.200]	33.02	[.1.300]	13	6-147728-2
	27.94	[.1.100]	30.48	[.1.200]	12	6-147728-1
	25.4	[.1.000]	27.94	[.1.100]	11	6-147728-0
44mm	22.86	[.900]	25.4	[.1.000]	10	5-147728-9
	20.32	[.800]	22.86	[.900]	9	5-147728-8
	17.78	[.700]	20.32	[.800]	8	5-147728-7
	15.24	[.600]	17.78	[.700]	7	5-147728-6
	12.7	[.500]	15.24	[.600]	6	5-147728-5
	10.16	[.400]	12.7	[.500]	5	5-147728-4
	7.62	[.300]	10.16	[.400]	4	5-147728-3
	5.08	[.200]	7.62	[.300]	3	5-147728-2
	2.54	[.100]	5.08	[.200]	2	5-147728-1
	24mm					
EIA TAPE WIDTH	B	A	NO OF POSN	FINISH	PART NUMBER	

△ OBSOLETE

THIS DRAWING IS A CONTROLLED DOCUMENT.

DESIGNED BY: J. OLSON  
 DRAWN BY: J. OLSON  
 CHECKED BY: J. OLSON  
 DATE: 108-25026  
 114-25018  
 100779

Two Electronics Corporation  
 Harrisburg, Pa 17105-3608

RECPY. ASSY., MOD IV, SINGLE ROW, 100 CL.  
 SURFACE MOUNT, VERTICAL, DUAL ENTRY  
 CLOSED ENTRY

CUSTOMER DRAWING

DATE: 11/11  
 SHEET: 2/2