

4

3

2

1

THIS DRAWING IS UNPUBLISHED. RELEASED FOR PUBLICATION JUL. 2005.
 COPYRIGHT 2005 BY TYCO ELECTRONICS CORPORATION. ALL INTERNATIONAL RIGHTS RESERVED.

LOC	DIST	REVISIONS			
P	LTR	DESCRIPTION	DATE	DWN	APVD
IR	-				
D1		ECR-10-000262	19APR2010	SRE	PCH

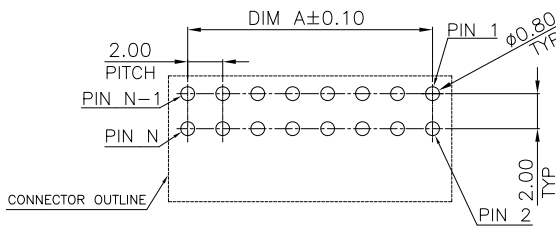
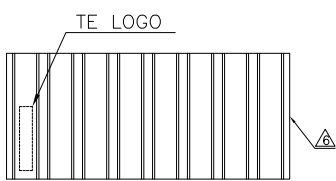

OBSOLETE	DIM A	DIM B	POSITION NUMBER	PART NUMBER
	78.00	80.20	80	8-0
	76.00	78.20	78	7-8
	74.00	76.20	76	7-6
	72.00	74.20	74	7-4
	70.00	72.20	72	7-2
	68.00	70.20	70	7-0
	66.00	68.20	68	6-8
	64.00	66.20	66	6-6
	62.00	64.20	64	6-4
	60.00	62.20	62	6-2
	58.00	60.20	60	6-0
	56.00	58.20	58	5-8
	54.00	56.20	56	5-6
	52.00	54.20	54	5-4
OBSOLETE	50.00	52.20	52	5-2
	48.00	50.20	50	5-0
	46.00	48.20	48	4-8
	44.00	46.20	46	4-6
	42.00	44.20	44	4-4
	40.00	42.20	42	4-2
	38.00	40.20	40	4-0
	36.00	38.20	38	3-8
	34.00	36.20	36	3-6
	32.00	34.20	34	3-4
	30.00	32.20	32	3-2
	28.00	30.20	30	3-0
	26.00	28.20	28	2-8
	24.00	26.20	26	2-6
	22.00	24.20	24	2-4
	20.00	22.20	22	2-2
	18.00	20.20	20	2-0
	16.00	18.20	18	1-8
	14.00	16.20	16	1-6
	12.00	14.20	14	1-4
	10.00	12.20	12	1-2
	8.00	10.20	10	1-0
	6.00	8.20	8	1734531-8
	4.00	6.20	6	1734531-6
	2.00	4.20	4	1734531-4
DIM A	DIM B	POSITION NUMBER	PART NUMBER	

RECOMMENDED PCB LAYOUT TOLERANCE ± 0.05 (TOP VIEW)

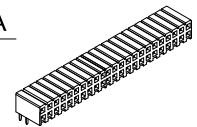
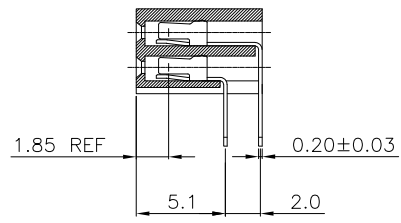
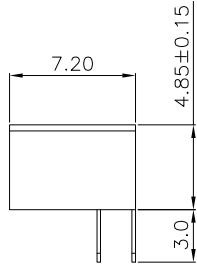
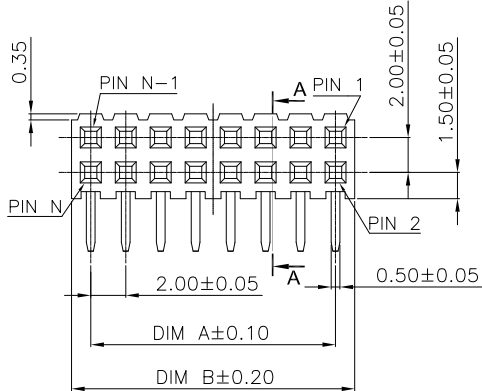

- NOTE :
- 1 MATERIAL : HOUSING : THERMOPLASTIC, UL94V-0, BLACK COLOR CONTACT : PHOSPHOR BRONZE, THICKNESS=0.20mm.
 - 2 FINISH : CONTACT: 0.254mm [10m"] MIN. GOLD PLATED ON CONTACT AREA 2.54mm [100m"] MIN. BRIGHT TIN PLATED ON SOLDER TAIL, 1.27mm [50m"] MIN. NICKEL UNDERPLATED OVER ALL
 - 3. APPLICATION : SOLDER TAIL LENGTH 2.6 FOR PCB THICKNESS 1.6 ± 0.1
 - 4. WAVE SOLDER CAPABLE TO 265°C PER TE SPEC 109-202, CONDITION B
 - 5 NO CUMULATIVE TOLERANCE
 - 6 DATECODE: YY WW D * ASS'Y LINE NO. DAY WEEK CODE YEAR
 - 7. QUALIFICATION TEST REPORT: 501-57197

THIS DRAWING IS A CONTROLLED DOCUMENT.		DWN 05.JUL.2005 O.HU	Tyco Electronics Corporation Bangalore, India.	
DIMENSIONS: mm		CHK 05.JUL.2005 S.HOU	NAME AMPMODU 2.0mm PITCH, RCPT CONN., RIGHT-ANGLE, MOUNT TYPE	
TOLERANCES UNLESS OTHERWISE SPECIFIED:		APVD 05.JUL.2005 W.J.KE	PRODUCT SPEC 108-57197	
0 PLC ± 0.5		APPLICATION SPEC		
1 PLC ± 0.2		SIZE A3		
2 PLC ± 0.1		CAGE CODE 00779		
3 PLC ± 0.05		DRAWING NO C-1734531		
4 PLC ± -		RESTRICTED TO		
ANGLES ± 3°		CUSTOMER DRAWING		
MATERIAL 1		SCALE 1:1		
FINISH 2		SHEET 1 OF 3		
		REV D1		

4

3

2

1

THIS DRAWING IS UNPUBLISHED. RELEASED FOR PUBLICATION JUL, 2005.
 COPYRIGHT 2005 BY TYCO ELECTRONICS CORPORATION. ALL INTERNATIONAL RIGHTS RESERVED.

LOC	DIST	REVISIONS			
P	LTR	DESCRIPTION	DATE	DWN	APVD
IR	-	SEE SHEET 1	-	-	-

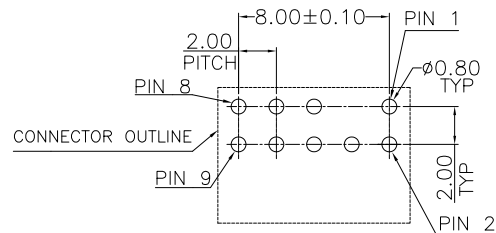
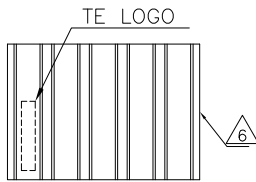

RECOMMENDED PCB LAYOUT
 TOLERANCE ± 0.05 (TOP VIEW)

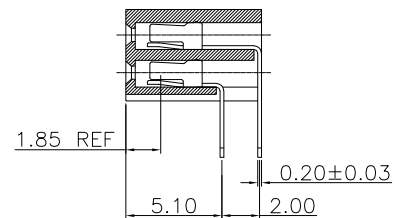
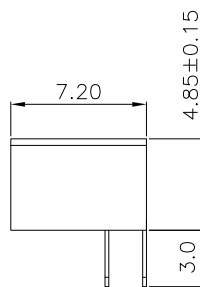
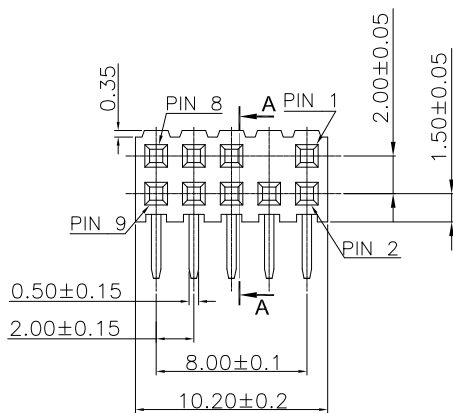

SECTION A-A

9	1734531-9
POSITION NUMBER	PART NUMBER

THIS DRAWING IS A CONTROLLED DOCUMENT.		DWN O.HU 05.JUL.2005	Tyco Electronics Corporation Bangalore, India.	
DIMENSIONS: mm		CHK S.HOU 05.JUL.2005	NAME	
TOLERANCES UNLESS OTHERWISE SPECIFIED:		APVD W.J.KE 05.JUL.2005	AMPMODU 2.0mm PITCH, RCPT CONN., RIGHT-ANGLE, MOUNT TYPE	
0 PLC ± 0.5 1 PLC ± 0.2 2 PLC ± 0.1 3 PLC ± 0.05 4 PLC ± - ± 3° ANGLES ± - ± 3°		PRODUCT SPEC 108-57197	SIZE A3	CAGE CODE 00779
MATERIAL SEE SHEET 1	FINISH SEE SHEET 1	APPLICATION SPEC -	DRAWING NO C-1734531	RESTRICTED TO -
CUSTOMER DRAWING		WEIGHT -	SCALE 1:1	SHEET 2 OF 3
				REV D1

4

3

2

1

THIS DRAWING IS UNPUBLISHED. RELEASED FOR PUBLICATION JUL, 2005.
 COPYRIGHT 2005 BY TYCO ELECTRONICS CORPORATION. ALL INTERNATIONAL RIGHTS RESERVED.

LOC	DIST	REVISIONS			
P	LTR	DESCRIPTION	DATE	DWN	APVD
-	-	SEE SHEET 1	-	-	-

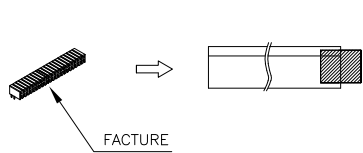

TUBE
635mm(L)X12mm(W)X11mm(H)

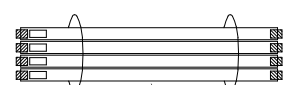
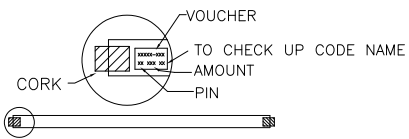

TEN PACKAGES OF ONE BUNCH
 CARTON
660mm(L)X220mm(W)X140mm(H)

QTY	TUBE/ CARTON	PCS/ TUBE	POSITION NUMBER	PART NUMBER		
OBSOLETE	1050	150	7	80	8	-0
	1050	150	7	78	7	-8
	1050	150	7	76	7	-6
	1200	150	8	74	7	-4
	1200	150	8	72	7	-2
	1200	150	8	70	7	-0
	1200	150	8	68	6	-8
	1350	150	9	66	6	-6
	1350	150	9	64	6	-4
	1350	150	9	62	6	-2
	1500	150	10	60	6	-0
	1500	150	10	58	5	-8
	1500	150	10	56	5	-6
	1650	150	11	54	5	-4
	1650	150	11	52	5	-2
OBSOLETE	1800	150	12	50	5	-0
	1800	150	12	48	4	-8
	1950	150	13	46	4	-6
	1950	150	13	44	4	-4
	2100	150	14	42	4	-2
	2100	150	14	40	4	-0
	2250	150	15	38	3	-8
	2400	150	16	36	3	-6
	2550	150	17	34	3	-4
	2700	150	18	32	3	-2
	2850	150	19	30	3	-0
	3150	150	21	28	2	-8
	3300	150	22	26	2	-6
	3600	150	24	24	2	-4
	3900	150	26	22	2	-2
	4350	150	29	20	2	-0
	4800	150	32	18	1	-8
	5400	150	36	16	1	-6
	6150	150	41	14	1	-4
	7200	150	48	12	1	-2
	8550	150	57	10	1	-0
	8550	150	57	9	1734531	-9
	10650	150	72	8	1734531	-8
	14400	150	96	6	1734531	-6
	21600	150	144	4	1734531	-4

THIS DRAWING IS A CONTROLLED DOCUMENT.

DWN O.HU 05.JUL.2005	Tyco Electronics Corporation Bangalore, India.
CHK S.HOU 05.JUL.2005	
APVD W.J.KE 05.JUL.2005	
NAME	
DIMENSIONS: mm	PRODUCT SPEC 108-57197
TOLERANCES UNLESS OTHERWISE SPECIFIED: 0 PLC ± 0.5 1 PLC ± 0.2 2 PLC ± 0.1 3 PLC ± 0.05 4 PLC ± 0.1 ANGLES ± 3'	APPLICATION SPEC
MATERIAL SEE SHEET 1	FINISH SEE SHEET 1
CUSTOMER DRAWING	

SIZE A3	CAGE CODE 00779	DRAWING NO C-1734531	RESTRICTED TO
SCALE 1:1		SHEET 3 OF 3	REV D1