

REV	DATE	DESCRIPTION	BY	CHK	APP
00					
M		REVISED PER EC 0038-1094-04		OPFERES	KW SR

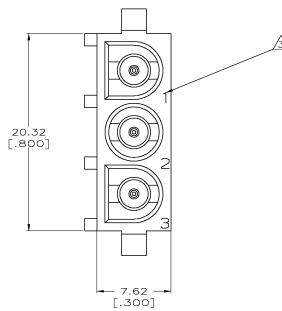

- PARTS COMPLY TO AMP SOLDERABILITY SPECIFICATION 109-11-3.
- CONTACT IS PLATED OVERALL WITH 0.00127 [.000050] NICKEL, THEN 0.00076 [.000030] GOLD OVER CONTACT LENGTH INDICATED AND MATTE TIN LEAD ON SOLDER TAIL END.
- CIRCUIT IDENTIFICATION CHARACTERS ARE ADJACENT TO THE INDICATED CAVITIES, BUT LOCATION AND ORIENTATION MAY DIFFER FROM PRINT.
- DIMENSIONS IN BRACKETS ARE IN INCHES.
- CONTACT IS PLATED OVERALL WITH 0.00127 [.000050] NICKEL, THEN 0.00076 [.000030] GOLD OVER CONTACT LENGTH INDICATED AND MATTE TIN LEAD ON SOLDER TAIL END.

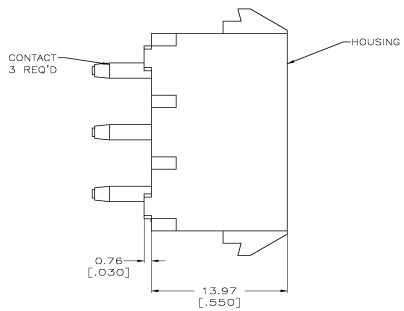
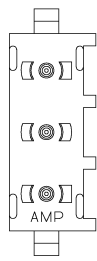
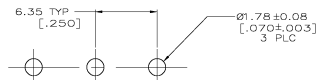
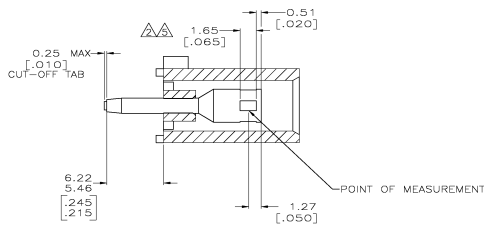

RECOMMENDED MOUNTING HOLE PATTERN
 FOR 3.18 [.125] THICK P.C. BOARD

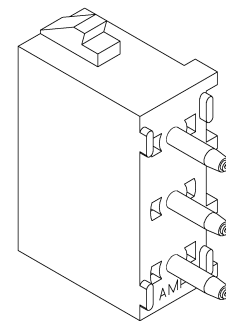

3-DIMENSIONAL MODEL
 NTS

PHOSPHOR BRONZE, GOLD	NYLON,UL94V-0,WHITE	350832-4
PHOSPHOR BRONZE, GOLD	NYLON,UL94V-0,WHITE	350832-2
PHOSPHOR BRONZE, PRE-TIN	NYLON,UL94V-0,WHITE	350832-1
CONTACT MATERIAL AND FINISH	HOUSING MATERIAL	PART NUMBER

METRIC

THIS DRAWING IS A CONTROLLED DOCUMENT		REV	DATE	BY	CHK	APP
ISSUING	ISSUING	00				
REVISED	REVISED					
DATE	DATE					
BY	BY					
CHK	CHK					
APP	APP					
DESCRIPTION	DESCRIPTION	SOCKET HEADER ASSEMBLY, 3 CIRCUIT, UNIVERSAL MATE-IN-LOCK(TM)				
DATE	DATE	A1 007798 350832				
REVISED	REVISED					
DATE	DATE					
BY	BY					
CHK	CHK					
APP	APP					