

REV	DATE	DESCRIPTION	BY	CHK	APP
CM	00				
		REVISED PER EC 0038-0300-00			

- PARTS COMPLY TO AMP SOLDERABILITY SPECIFICATION 109-11-3.
- CIRCUIT IDENTIFICATION CHARACTERS ARE ADJACENT TO THE INDICATED CAVITIES, BUT LOCATION AND ORIENTATION MAY DIFFER FROM PRINT.
- DIMENSIONS IN BRACKETS ARE IN INCHES.
- △ DRAIN HOLES LOCATED AS SHOWN, OPTIONAL CONSTRUCTION- ALL DRAIN HOLES LOCATED 90° AS SHOWN IN DETAIL A.

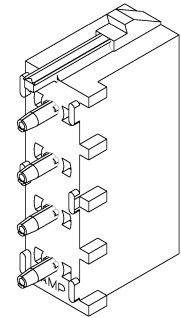

3-DIMENSIONAL MODEL NTS

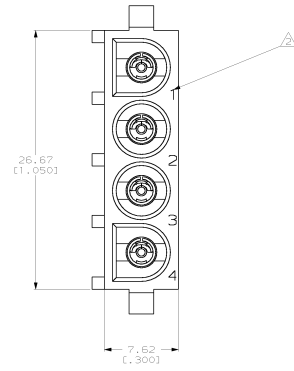
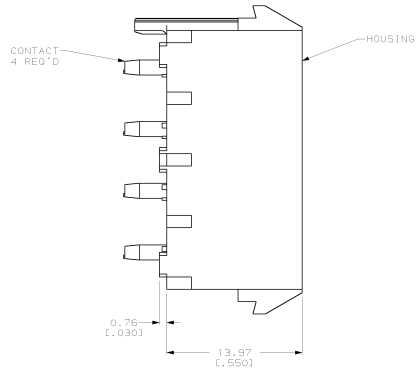
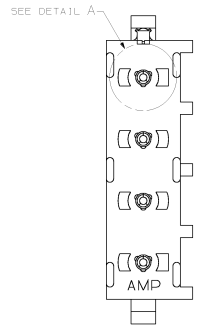
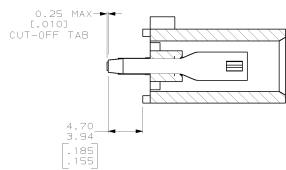

DETAIL A
 OPTIONAL CONSTRUCTION △

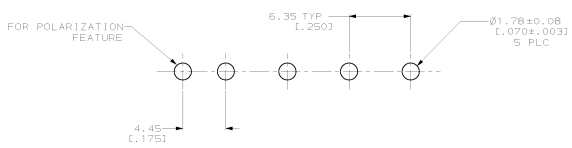

RECOMMENDED MOUNTING HOLE PATTERN FOR 1.57 (1.052) THICK P.C. BOARD

PHOSPHOR BRONZE, PRE-TIN	NYLON, UL94V-2, NATURAL	643415-1
PIN CONTACT MATERIAL AND FINISH		HOUSING MATERIAL PART NO

THIS DRAWING IS A CONTROLLED DOCUMENT.		REV	DATE	DESCRIPTION	BY	CHK	APP
REV	DATE	DESCRIPTION	BY	CHK	APP		
01	07/20/2001	INITIAL RELEASE					
02	07/20/2001	REVISED PER EC 0038-0300-00					

AMP Incorporated
 Horsholm, PA 17105-3608

**SOCKET HEADER ASSEMBLY,
 POLARIZED 4-CIRCUIT
 UNIVERSAL MATE-N-LOK™**

REV: 00100779 C: 643415

