

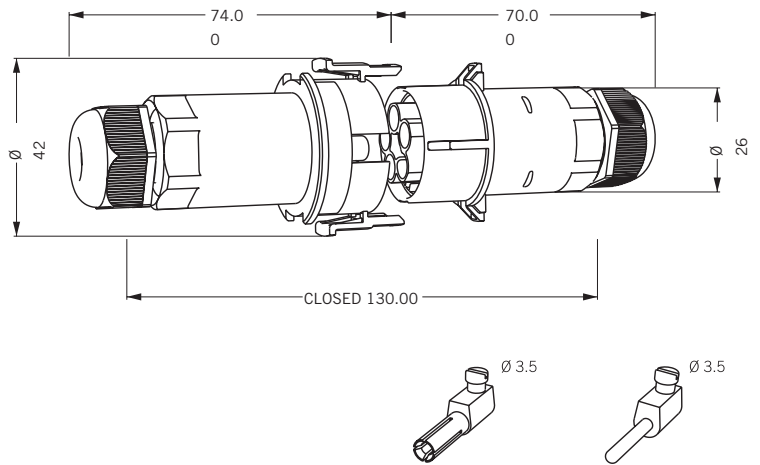

# TH404

PATENTED IP65

## 5 poli



Connessione presa-spina 5 poli. Grado di protezione IP65.  
Facilità di cablaggio. Connessione a bussola o faston.  
Kit di fornitura: frutti non inseriti.

*Connection socket-plug 5 poles.  
IP 65 protection. Easy wiring.  
Supply kit: fruits not inserted.*

### Dati tecnici - Technical data(\*)

16 A    1,5<sup>2</sup>    400V ~    IP 65

Materia plastica - Plastic Material

PA66 UL94 V2 GWT 850°C    -20°C

■ Nero - Black    +125°C

Ottone nichelato  
Nickled brass

Acciaio zincato passivato  
Zinc passivated steel

Rated current                    16 A  
Rated impulse voltage        6 KV  
Impulse withstand voltage    7,3 KV  
Range of temperature        0 -85°C  
Cable max                        5G1,5<sup>2</sup>H07RN-F

(\*)EN 61984-2001-1999



Solo per THB...  
Only for THB...

IP65

Per faston cilindrici universali Ø2  
For universal cylindrical faston Ø2



### Codice - Part number

T H B . 4 0 4 . X X X

Diametro cavo - Cable diameter

PLUG



THB.404.A1A    Ø 9÷14 mm

THB.404.A2A\*    Ø 5÷14 mm



POWER-SOCKET



THB.404.B1A    Ø 9÷14 mm

THB.404.B2A\*    Ø 5÷14 mm



\*gommino doppio - double seal



Diametro cavo - Cable diameter

PLUG

THF.404.A1A    Ø 9÷14 mm

THF.404.A2A\*    Ø 5÷14 mm



POWER-SOCKET

THF.404.B1A    Ø 9÷14 mm

THF.404.B2A\*    Ø 5÷14 mm



\*gommino doppio - double seal



I dati tecnici possono essere modificati senza preavviso - The technical data can be changed without notice  
Techno S.r.l. - technology & innovation - tel. +39.031.976445 - www.techno.it - info@techno.it

## Accessori - Accessories

	<b>6DB000800</b>	<b>Double Yellow Seal</b> Ø <sub>e</sub> 15,5 - Ø <sub>i</sub> 8 Ø 5÷14mm		<b>6000092CC</b> <b>6000143CE</b>	Nero - Black Grigio- Grey 7035 Foro - Hole Ø 14 CH  <b>24mm</b>
	<b>604001400</b>	<b>Guarnizione rossa - Red Seal</b> □ Ø <sub>e</sub> 28 - Ø <sub>i</sub> 25 - SP.2		<b>6000087LF</b>	Riduzione per dado <b>Adapter for nut</b> Foro - Hole Ø 9 CH  <b>24mm</b>
	<b>604001500</b>	<b>Guarnizione rossa - Red Seal</b> OR Ø 23,52 x 1,78		<b>600009600</b>	Chiave per agganciare i frutti <b>Modules adapter</b> 5 poli - 5 poles

## Istruzioni di montaggio - Assembling Instructions

- 1** Spelatura cavi.  
*Cables stripping.*

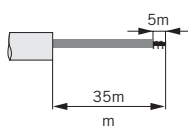
- 2** Preparazione frutto.  
*Plug-in module preparation.*

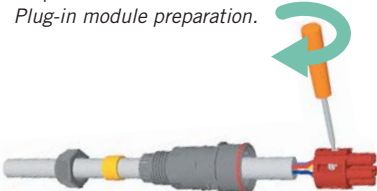

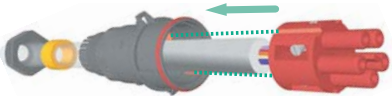
- 3** Inserimento frutto nel corpo rispettando i riferimenti.  
*Fitting of the plug-in module inside the body in accordance with the reference marks.*



- 4** Il bloccaggio del frutto nel corpo può essere fatto:  
a) Ruotando il cavo in senso orario fino al CLICK  
b) Ruotando il frutto in senso antiorario fino al CLICK  
*The modules clamping in the body can be done by:*  
a) Turning the cable in clockwise (CLICK)  
b) Turning modules in anticlockwise (CLICK)

**(a)** Con un cacciavite  
*With screwdriver*

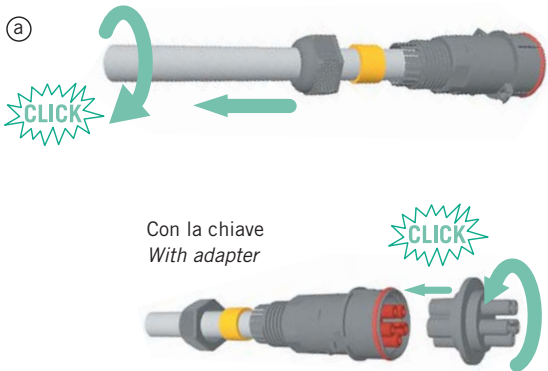

**(b)** Con la chiave  
*With adapter*

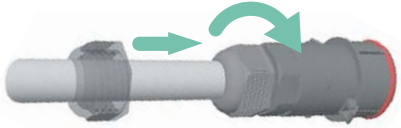
- 5** Posizionare la guarnizione e avvitare il dado.  
*Position the seal then block the cable with the nut.*

- 6** Intercambiabilità frutto maschio con frutto femmina.  
*Interchangeability between plug and socket modules.*

- 7** Connessione rispettando la polarizzazione.  
*Connection in accordance with the polarization.*

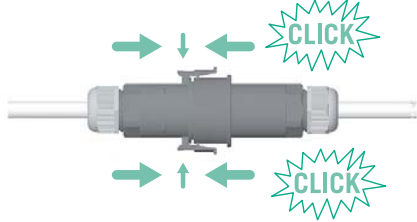
- 8** Per disconnettere sollevare le due alette. Attenzione: essendo una connessione a tenuta d'acqua, gli accoppiamenti devono necessariamente frizionare.  
*To disconnect lift the two wings. Attention: being a watertight device, the connections would be necessary frictional.*

