

# Miniature Banana Plug Insulated Solder Type

## SPECIFICATIONS

**Plug Body:** Brass per QQ-B-626D

**Plug Spring:** Beryllium copper per QQ-C-533

**Finish:** Nickel

**Insulated Handle:** Nylon 6/6 per ASTM D4066

## RATINGS

**Current:** 10 amps

**Breakdown Voltage:** 3500 Vrms minimum +

**Contact Resistance:** 0.010 ohms maximum

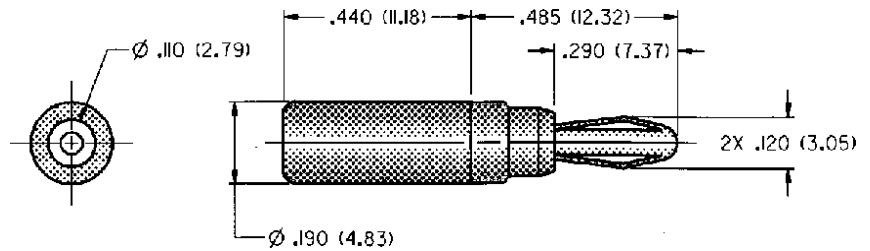

| NICKEL PLATING |     |
|----------------|-----|
| 108-1002-001   | Red |

**For Miniature Banana Jack: .104 (2.64) Diameter**

## FEATURES:

- Small size for limited space
- Solder terminal accepts up to 18 gauge wire
- Nylon UL approved for self extinguishing