

SD-19142-001

MATERIAL NUMBER	ENGINEERING NUMBER	STUD SIZE	"S" ±.005/(0.13)	"W" ±.010/(0.25)	"C" MIN	"L" MAX	PACKAGING
I91420019	B-207-04X	4	.119/(3.02)	.245/(6.22)	.209/(5.31)	.834/(21.18)	LOOSE PIECE
I91420020	B-207-06X	6	.146/(3.71)	.245/(6.22)	.209/(5.31)	.834/(21.18)	
I91420022	B-224-04X	4	.119/(3.02)	.295/(7.49)	.211/(5.36)	.831/(21.11)	
I91420024	B-224-06X	6	.146/(3.71)	.295/(7.49)	.211/(5.36)	.831/(21.11)	
I91420027	B-224-08X	8	.173/(4.39)	.295/(7.49)	.211/(5.36)	.831/(21.11)	
I91420029	B-227-06X	6	.146/(3.71)	.362/(9.19)	.269/(6.83)	.966/(24.54)	
I91420030	B-227-08X	8	.173/(4.39)	.388/(9.85)	.269/(6.83)	.966/(24.54)	
I91420032	B-227-10X	10	.198/(5.03)	.388/(9.85)	.269/(6.83)	.966/(24.54)	
I91420069	B-207-04XT	4	.119/(3.02)	.245/(6.22)	.209/(5.31)	.834/(21.18)	TAPE MOUNTED
I91420021	B-207-06XT	6	.146/(3.71)	.245/(6.22)	.209/(5.31)	.834/(21.18)	
I91420071	B-224-04XT	4	.119/(3.02)	.295/(7.49)	.211/(5.36)	.831/(21.11)	
I91420025	B-224-06XT	6	.146/(3.71)	.295/(7.49)	.211/(5.36)	.831/(21.11)	
I91420072	B-224-08XT	8	.173/(4.39)	.295/(7.49)	.211/(5.36)	.831/(21.11)	
I91420073	B-227-06XT	6	.146/(3.71)	.362/(9.19)	.269/(6.83)	.966/(24.54)	
I91420031	B-227-08XT	8	.173/(4.39)	.388/(9.85)	.269/(6.83)	.966/(24.54)	
I91420033	B-227-10XT	10	.198/(5.03)	.388/(9.85)	.269/(6.83)	.966/(24.54)	

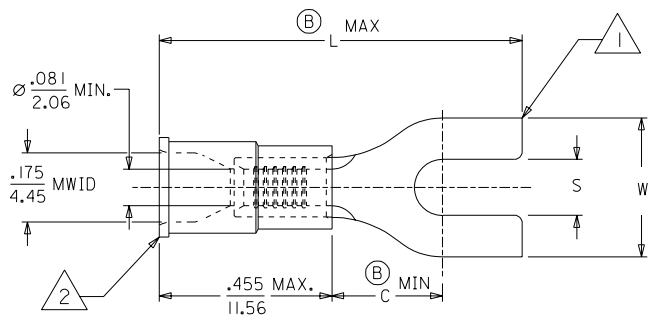
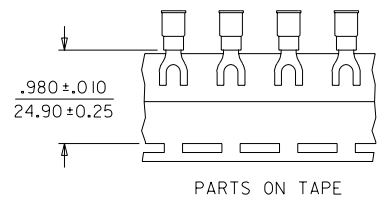

SALES DRAWING

- NOTES:
- MATERIAL: COPPER .031/(.79) THICK.
  - PLATING: ELECTRO-TIN.
  - INSULATION: MOLDED PVC (BLUE)
  - MWID=MAXIMUM WIRE INSULATION DIAMETER.

REVISED "L" EC NO. E1C2004-0133 DRAWN BY: HEB CHK: HEB APPR: RWD	QUALITY SYMBOLS MAJOR CRITICAL	GENERAL TOLERANCES: (UNLESS SPECIFIED)	SCALE 4:1	DESIGN UNITS <input type="checkbox"/> mm <input checked="" type="checkbox"/> INCH	THIRD ANGLE PROJECTION	DIMENSIONS: <input type="checkbox"/> mm <input checked="" type="checkbox"/> INCH	SHT REV									
		<table border="1"> <tr><td>4 PLACES</td><td>±0.</td><td>±.</td></tr> <tr><td>3 PLACES</td><td>±0.</td><td>±.</td></tr> <tr><td>2 PLACES</td><td>±0.</td><td>±.</td></tr> <tr><td>1 PLACE</td><td>±0.</td><td>±.</td></tr> </table>	4 PLACES	±0.	±.	3 PLACES	±0.	±.	2 PLACES	±0.	±.	1 PLACE	±0.	±.	DRAWN BY & DATE HEB 99/11/12	TITLE: SPADE TONGUE TERMINAL 16-14 AWG INSULKRIMP, 200 SERIES
4 PLACES	±0.	±.														
3 PLACES	±0.	±.														
2 PLACES	±0.	±.														
1 PLACE	±0.	±.														
B	REV	ANGULARS ± 1/2 °	APPROVED BY & DATE RWD 99/11/12	CAD FILENAME SD-19142-001.DGN	MATERIAL NO. SEE CHART	DRAWING NO. SD-19142-001	SHEET NO. B									
DRAFT WHERE APPLICABLE MUST REMAIN WITHIN DIMENSIONS		THIS DRAWING CONTAINS INFORMATION THAT IS PROPRIETARY TO MOLEX INCORPORATED AND SHOULD NOT BE USED WITHOUT WRITTEN PERMISSION.														