

MATERIAL NUMBER	ENGINEERING NUMBER	S ±.007/.178	K REF	MATERIAL
190760001	SRA-529-06	.146/3.71	.236/5.99	BRASS
190760003	SRA-529-08	.173/4.40	.263/6.68	BRASS
190760005	SRA-529-10	.198/5.03	.288/7.32	BRASS
190760013	SRB-529-06	.146/3.71	.236/5.99	BRASS
190760015	SRB-529-08	.173/4.40	.263/6.68	BRASS
190760017	SRB-529-10	.198/5.03	.288/7.32	BRASS
190760007	SRA-S-529-06	.146/3.71	.236/5.99	STEEL
190760009	SRA-S-529-08	.173/4.40	.263/6.68	STEEL
190760011	SRA-S-529-10	.198/5.03	.288/7.32	STEEL
190760019	SRB-S-529-06	.146/3.71	.236/5.99	STEEL
190760021	SRB-S-529-08	.173/4.40	.263/6.68	STEEL
190760023	SRB-S-529-10	.198/5.03	.288/7.32	STEEL

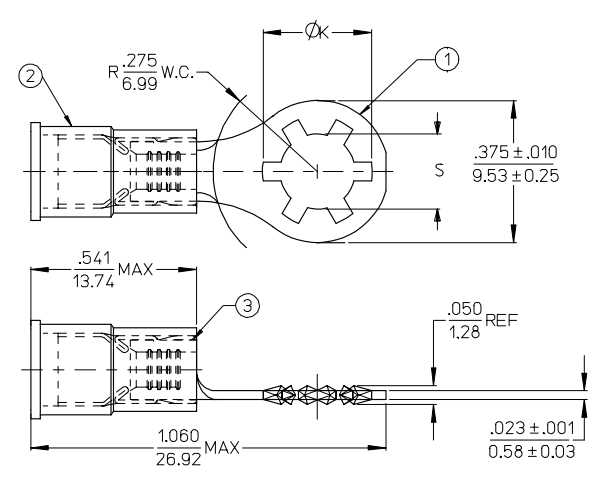

SALES DRAWING

ITEM	QTY	DESCRIPTION	MATERIAL	FINISH
3	1	FERRULE PLATED	BRASS	TIN PLATING
2	1	RED 600V AVIK MLD INS	NYLON	RED
1	1	STAR RING KRIMPTITE	SEE CHART	TIN PLATING

NOTES:

1. MATERIAL: SEE CHART
2. FINISH: SEE CHART
3. ALL COMPONENTS OF THIS ASSEMBLY ARE RoHS COMPLIANT

REVISED / REDRAWN EC NO: ETC2006-0323 DRAWN BY: DRINKASAYDEH 2006/03/15 CHECKED BY: CHYKROBEROSS 2006/03/17 APPROVED BY: RDEROSS 2006/03/17	QUALITY SYMBOLS ▽=0 ▽=0	GENERAL TOLERANCES (UNLESS SPECIFIED)		DIMENSION STYLE IN/MM	SCALE 4:1	DESIGN UNITS INCH	THIRD ANGLE PROJECTION	
		mm	INCH	DRAWN BY ASAYDEH	DATE 06/03/15	TITLE STAR RING TERMINAL AVIKRIMP		
		4 PLACES ± .005	± .005	CHECKED BY RDEROSS	DATE 06/03/15	MOLEX INCORPORATED		
		3 PLACES ± .013	± .01	APPROVED BY RDEROSS	DATE 06/03/15			
ANGULAR ±1/2°		MATERIAL NO. SEE CHART		DOCUMENT NO. SD-19076-001	STEEY NO. 1 OF 1			
DRAFT WHERE APPLICABLE MUST REMAIN WITHIN DIMENSIONS				SIZE B THIS DRAWING CONTAINS INFORMATION THAT IS PROPRIETARY TO MOLEX INCORPORATED AND SHOULD NOT BE USED WITHOUT WRITTEN PERMISSION				