

FOR 0.8mm
TAB THICKNESS

1) PER LE VERSIONI A NASTRO
VEDERE DISEGNO 160301.
(FOR STRIP FORM VERSION SEE DRAWING 160301).

2) OBSOLETE PARTS: OBSOLETE CIS STREAMLINING PER
D.RENAUD/D.SINISI

SEZIONE A-A
SECTION A-A

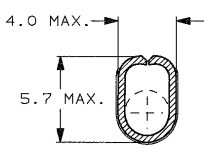

SEZIONE B-B
SECTION B-B

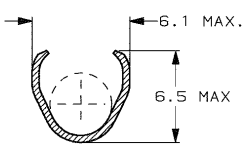

2) OBSOLETE

STAGNATO (TIN PLATED)	BRONZO FOS. (PHOS. BRONZE)	1-160305-9	R
ARGENTATO (SILVER PLATED)	BRONZO FOS. (PHOS. BRONZE)	1-160305-8	R
STAGNATO (TIN PLATED)	OTTONE (BRASS)	1-160305-6	R
NUDO (UNPLATED)	BRONZO FOS. (PHOS. BRONZE)	1-160305-4	R
NUDO (UNPLATED)	OTTONE (BRASS)	1-160305-3	R
FINITURA / COLORE (FINISH / COLOUR)	MATERIALE (MATERIAL)	NUMERO (PART NUMBER)	REV

CUSTOMER DWG. FOR REFERENCE ONLY

THIS DRAWING IS UNPUBLISHED		RELEASE FOR PUBLICATION		19
© COPYRIGHT 19 BY AMP INCORPORATED, HARRISBURG, PA. ALL INTERNATIONAL RIGHT RESERVED. AMP PRODUCTS MAY BE COVERED BY U.S. AND FOREIGN PATENT AND/OR PATENT PENDING.				
TOLLERANZE, SE NON DIVERSAMENTE SPECIFICATO	DIAM. ISOLANTE (INS. DIA. RANGE)	RANGO FILO (WIRE RANGE)	mm2	SCALA (SCALE)
± 0.3	3.8-5.0	4.0-6.0		4:1
ANGOLI (ANGLES)	± 2°		AMP AMP ITALIA S.p.A. Corso F.lli Cervi, 15 COLLENO (TORINO)	
DIS. H. YAALI (DR.) 08 AUG 2000	DESCRIZIONE (DESCRIPTION)		FASTON® Connector, .250" sr. REC. CONTACT (LOOSE PIECE VERSION)	
R1 REVISED PER ECO-09-022178	KK	CONT. C. TARTARI (CHK) 08 AUG 2000	LOC. SIZE NUMERO (DWG NO)	REV. FOGLIO (SHEET)
R OBSOLETE PARTS & REDRAWN ETDC-0245-00	H. Y.	APP. (APP.)	I A3 C-160305	R1 1 01
REV. REVISIONI (REVISION RECORD)	DTS. DATA (DRS) DATE			1

DISTRIBUZIONE
PRINTING LIST