



ALL RIGHTS RESERVED. NO PORTION OF THIS PUBLICATION, WHETHER IN WHOLE OR IN PART, CAN BE REPRODUCED WITHOUT THE EXPRESS WRITTEN CONSENT OF SPC TECHNOLOGY.

SPC-F005.DWG

REVISIONS

DOC. NO. SPC-F005 \* Effective: 7/8/02 \* DCP No: 1398

DCP #	REV	DESCRIPTION	DRAWN	DATE	CHECKD	DATE	APPRVD	DATE
1116	B	Drawing was CRS-DY-****	JWM	6/11/01	JC	6/20/01	JC	6/20/01
1369	C	Bulk items added	JWM	6/25/04	JC	6/25/04	JC	6/25/04

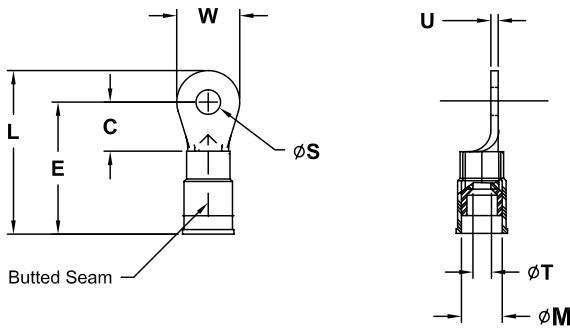

NOTES:

- MATERIAL: ELECTRO-TIN PLATED COPPER WITH NYLON 6/6 SLEEVE  
FLAMMABILITY: UL94V-2
- CONTINUOUS OPERATING TEMPERATURE:  
-40°F (-40°C) TO 167°F (75°C)
- VOLTAGE RATING: 600 V
- TO BE FREE OF BURRS.

SPC Type No.	Pack Qty	SPC Type No.	Pack Qty	RANGE (AWG)	STUD SIZE	L	W	E	C	S	T	M	U	COLOR
CRS-DY-1008	50	SPC3798	500	12 - 10	#8 .164	1.03	.38	.84	.29	.174	.135	.250	.040	YELLOW
CRS-DY-1010	50	SPC3799	500	12 - 10	#10 .190	1.03	.38	.84	.29	.200	.135	.250	.040	YELLOW
CRS-DY-1025	50	SPC3800	500	12 - 10	1/4" .250	1.26	.53	.99	.44	.265	.135	.250	.040	YELLOW
CRS-DY-1406	100	SPC3795	1000	16 - 14	#6 .138	.91	.33	.75	.29	.148	.090	.170	.030	BLUE
CRS-DY-1408	100	SPC3796	1000	16 - 14	#8 .164	.94	.31	.79	.33	.174	.090	.170	.030	BLUE
CRS-DY-1410	100	SPC3797	1000	16 - 14	#10 .190	.92	.31	.79	.33	.200	.090	.170	.030	BLUE
CRS-DY-1804	100	SPC3790	1000	22 - 18	#4 .112	.79	.25	.66	.22	.120	.070	.175	.030	RED
CRS-DY-1806	100	SPC3791	1000	22 - 18	#6 .138	.79	.25	.66	.22	.148	.070	.145	.030	RED
CRS-DY-1808	100	SPC3792	1000	22 - 18	#8 .164	.92	.31	.77	.33	.174	.070	.145	.030	RED
CRS-DY-1810	100	SPC3793	1000	22 - 18	#10 .190	.92	.31	.77	.33	.200	.070	.145	.030	RED
CRS-DY-1825	100	SPC3794	1000	22 - 18	1/4 .250	1.07	.47	.84	.40	.265	.070	.145	.030	RED
† CRS-DY-2202	100	† SPC3788	1000	26 - 22	#2 .086	.47	.14	.40	.12	.095	.030	.093	.020	YELLOW
† CRS-DY-2206	100	† SPC3789	1000	26 - 22	#6 .138	.60	.20	.49	.21	.148	.030	.093	.020	YELLOW



† NOT UL LISTED OR CSA CERTIFIED

DISCLAIMER: ALL STATEMENTS AND TECHNICAL INFORMATION CONTAINED HEREIN ARE BASED UPON INFORMATION AND/OR TESTS WE BELIEVE TO BE ACCURATE AND RELIABLE. SINCE CONDITIONS OF USE ARE BEYOND OUR CONTROL, THE USER SHALL DETERMINE THE SUITABILITY OF THE PRODUCT FOR THE INTENDED USE AND ASSUME ALL RISK AND LIABILITY WHATSOEVER IN CONNECTION THEREWITH.

TOLERANCES:  
Tolerances: Unless Otherwise Specified:  
.X = ±.015  
.XX = ±.010  
.XXX = ±.005

DRAWN BY:	DATE:
JC	3/6/91
CHECKED BY:	DATE:
JOHN COLE	11/21/91
APPROVED BY:	DATE:
J Liska	11/21/91

DRAWING TITLE: <b>Nylon Insulated ring Tongue Terminals</b>			
SIZE	DWG. NO.	ELECTRONIC FILE	REV
A	TA-370	TA-370.dwg	C
SCALE: NTS	U.O.M.: INCHES [mm]	SHEET: 1 OF 1	