



Scotchlok™

Moisture Resistant Self-Stripping Electrical Tap Connector 804



Data Sheet

Application

Use Scotchlok™ Tap Connector 804 to electrically connect a (tap) wire end to a through (run) wire, insulate and provide a moisture resistant seal for the connection.

Wire Range

18-16 AWG (0,75-1,0 mm²) solid and stranded, 14 AWG (1,5 mm²) stranded tinned or untinned copper insulated conductors. For use with common thermoplastic insulated wires with a maximum insulation diameter of .145 inches (3,5 mm).

Maximum recommended current for general purpose applications: 18 AWG - 7 Amps, 16 AWG - 10 Amps, 14 AWG - 15 Amps

Construction

U-Contact - Tin plated brass, .03 in. (8mm) thick

Insulator - Polypropylene
Color - Blue

Sealant - Mineral Oil Base
Dielectric Grease

Weight

.0042 lb. (1,90 gm)

Recommended Installation Tools

3M™ Crimping Tool No. E-9BM
9" Linemans Pliers
8" Mechanics (slip joint) pliers

Engineering Specification

Self-Stripping Electrical Tap Connector (as manufactured by 3M, part No. 804) capable of connecting a tap wire to a run wire and providing a moisture seal, in the wire range of 18-16 AWG (0,75-1,0 mm²) solid or stranded, and 14 AWG (1,5 mm²) stranded, tinned or untinned copper insulated wire, with a maximum insulation diameter, of .145 inches (3,5 mm). The connector shall be rated 600 volts and have an insulation temperature rating of 90°C (194°F).

Regulatory Agencies

UL Listed as a Pressure Cable Connector
Tested per UL Standard 486C
UL File No. E23438

Operating Temperature: 90°C (194°F)
Voltage Rating: 600 volts max. building wire;
1000 volts max. signs and fixtures
Flammability Rating: UL94 V-2

CSA Certified-CSA Standard C22.2 No. 0, 188-M1983
CSA File No. LR15503

Operating Temperature: 105°C (221°F)
Voltage Rating: 600 volts max. building wire
1000 volts max. signs and luminaires.
Flammability Rating: C22.2 No. 0.6 V-2

Federal Specification W-S-610:

"Commercial package only"

Type	Class	Kind	Style
1	1	cu	G

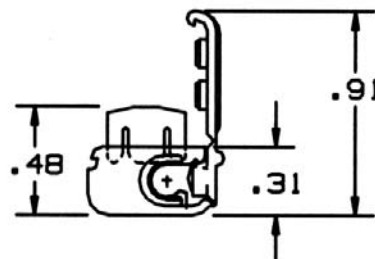
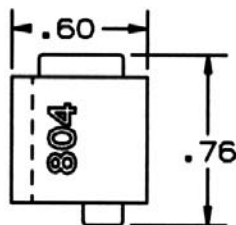

Installation Instructions

⚠ WARNING

Turn power off before installing or removing terminal. All electrical work should be done according to appropriate electrical codes.

1. Open hinged side wall.

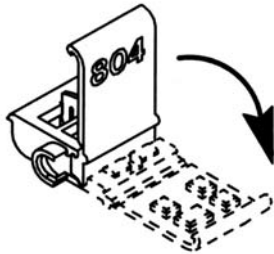

2. Place unstripped run wire inside run channel and close hinged side wall.

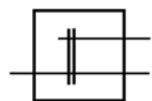
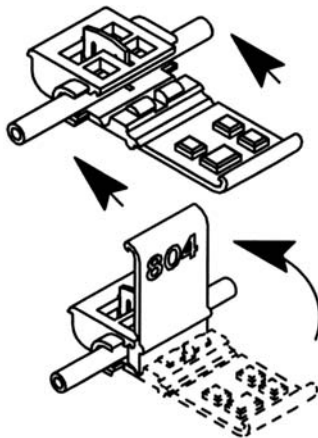

Tap Connector

3. Insert unstripped tap wire completely into tap port.

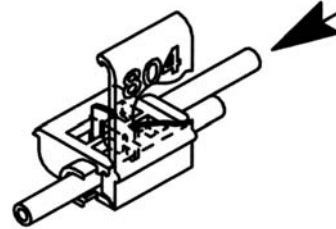

4. Hold tool perpendicular to the wire and make the connection by crimping the u-contact down flush with the top of the insulator.

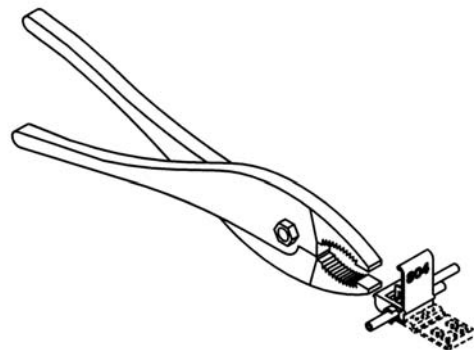

5. Close cover until latched.

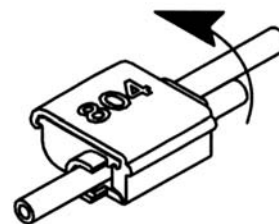

3M and Scotchlok are trademarks of 3M Company.

 is a trademark of Underwriters Laboratories.

 is a trademark of Canadian Standards Association.

IMPORTANT NOTICE

Before using this product, you must evaluate it and determine if it is suitable for your intended application. You assume all risks and liability associated with such use.

Warranty; Limited Remedy; Limited Liability. This product will be free from defects in material and manufacture as of the date of purchase. **3M MAKES NO OTHER WARRANTIES INCLUDING, BUT NOT LIMITED TO, ANY IMPLIED WARRANTY OF MERCHANTABILITY OR FITNESS FOR A PARTICULAR PURPOSE.** If this product is defective within the warranty period stated above, your exclusive remedy shall be, at 3M's option, to replace or repair the 3M product or refund the purchase price of the 3M product. **Except where prohibited by law, 3M will not be liable for any loss or damage arising from this 3M product, whether direct, indirect, special, incidental or consequential regardless of the legal theory asserted.**

3M

Electrical Products Division

6801 River Place Blvd.
Austin, TX 78726-9000
www.3M.com/elpd

Litho in USA
©3M 2003 78-8126-5923-9-A