

ALL RIGHTS RESERVED. NO PORTION OF THIS PUBLICATION, WHETHER IN WHOLE OR IN PART CAN BE REPRODUCED WITHOUT THE EXPRESS WRITTEN CONSENT OF SPC TECHNOLOGY.

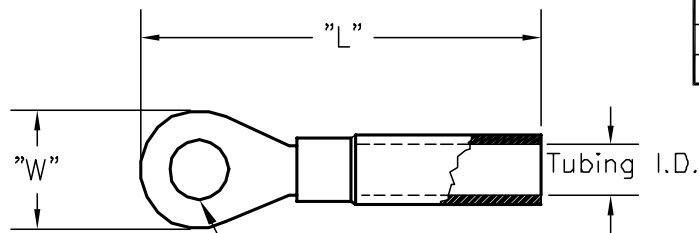

NOTES:

Bare Part:

1. Material: Copper
2. Finish: Electro-Tin Plate
3. Brazed Seam

Tubing:

1. Multiple wall Polyolefin
2. Meltable, integral inner wall
3. 275°F [135°C] shrink temp.
4. -67°F (-55°C) to 230°F (110°C)
Continuous Operating Temp .
5. Tensile Strength: 2,200 PSI
6. Ultimate Elongation: 500 %
7. Secant Modulus, 2 %: 27,000 PSI
8. Specific Gravity: 1.00 Max.
9. Longitudinal Change: 5 %
10. Dielectric strength: 1000V/Mil
11. Volume Resistivity: $10^{15} \Omega/\text{cm}$
12. Non-corrosive
13. Water Absorption: <0.1 %

Stud Size

REVISIONS

DOC. NO. SPC-F005 • Effective: 12/21/88 • DCP No: 680

DCP #	REV	DESCRIPTION	DRAWN	DATE	CHECKD	DATE	APPRVD	DATE
B52	A	RELEASED	JWM	2/24/00	JC	5/3/00	DJC	6/5/00

SPC Type No.	Wire Size (AWG)	Stud Size	Tubing I.D.	L ±.06 Dimension	W ±.02 Dimension	Tubing Color	Pkg Qty
3967	10-12	#10	.300	1.230	.375	Yellow	100
3981	10-12	#10	.300	1.230	.375	Yellow	25
3968	10-12	1/4"	.300	1.450	.611	Yellow	100
3982	10-12	1/4"	.300	1.450	.611	Yellow	25
3954	10-12	3/8"	.300	1.450	.611	Yellow	100
1670	10-12	3/8"	.300	1.450	.611	Yellow	25
3952	14-16	#6	.235	1.200	.311	Blue	100
1668	14-16	#6	.235	1.200	.311	Blue	25
3953	14-16	#8	.235	1.200	.311	Blue	100
1669	14-16	#8	.235	1.200	.311	Blue	25
3964	14-16	#10	.235	1.241	.311	Blue	100
3977	14-16	#10	.235	1.241	.311	Blue	25
3965	14-16	1/4"	.235	1.411	.530	Blue	100
3979	14-16	1/4"	.235	1.411	.530	Blue	25
3966	14-16	3/8"	.235	1.475	.530	Blue	100
3980	14-16	3/8"	.235	1.475	.530	Blue	25
3949	18-20	#6	.215	1.200	.311	Red	100
1665	18-20	#6	.215	1.200	.311	Red	25
3950	18-20	#8	.215	1.200	.311	Red	100
1666	18-20	#8	.215	1.200	.311	Red	25
3951	18-20	#10	.215	1.200	.311	Red	100
1667	18-20	#10	.215	1.200	.311	Red	25

DISCLAIMER

ALL STATEMENTS AND TECHNICAL INFORMATION CONTAINED HEREIN ARE BASED UPON INFORMATION AND/OR TESTS WE BELIEVE TO BE ACCURATE AND RELIABLE. SINCE CONDITIONS OF USE ARE BEYOND OUR CONTROL, THE USER SHALL DETERMINE THE SUITABILITY OF THE PRODUCT FOR THE INTENDED USE AND ASSUME ALL RISK AND LIABILITY WHATSOEVER IN CONNECTION THEREWITH.



SPC TECHNOLOGY

UNLESS OTHERWISE SPECIFIED, DIMENSIONS ARE FOR REFERENCE PURPOSES ONLY.

DRAWN BY:	DATE:
Jeff McVicker	2/24/00
CHECKED BY:	DATE:
JOHN COLE	5/30/00
APPROVED BY:	DATE:
Daniel Carey	6/5/00

DRAWING TITLE:

Ring Terminals

SIZE	DWG. NO.	ELECTRONIC FILE	REV
A	TA-213	TA-213.dwg	A

SCALE: NTS U.O.M.: INCHES [mm] SHEET: 1 OF 1

SPC-F005.DWG