

REVISIONS		
ISS	ZONE	DESCRIPTION\PER REQUEST\DATE

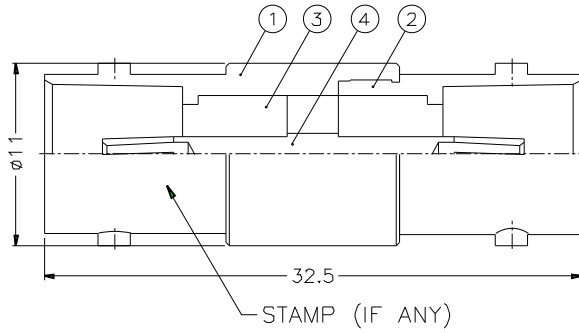

NOTES: FINISH (PLATING THICKNESS IN MICRO-INCHES)
 1. BRASS PER QQ-B-626
 2. NICKEL PL. 100 MIN. THICK OVER COPPER STRIKE
 3. PHOSPHOR BRONZE PER QQ-B-750
 4. GOLD PL. 3 MIN. THICK OVER NICKEL PL. 100 MIN. THICK OVER COPPER STRIKE

DIMENSIONS ARE IN MILLIMETERS		PART NO.	B7071A1-ND3G-75
UNLESS OTHERWISE SPECIFIED TOLERANCES		APPROVED	DATE
0.5-6	= ±0.2		10-11-01'
6-30	= ±0.4	CHECKED	DATE
30-120	= ±0.6		10-11-01'
120-315	= ±1	DRAWN	DATE
315-1000	= ±1.6		10-11-01'
1000-2000	= ±2.4		
NO.	DESCRIPTION	MATERIAL	FINISH
4	CONTACT PIN	NOTE 3	NOTE 4
3	INSULATOR	DELTRIN	NATURAL
2	BODY	NOTE 1	NOTE 2
1	HOUSING	NOTE 1	NOTE 2

<h1 style="text-align: center;">Amphenol</h1>			
		TITLE	BNC FEMALE TO FEMALE ADAPTOR
		DRAWING NO.	KJ-B7071A1-ND3G-75
		ITEM NO.	

NO.	DESCRIPTION	MATERIAL	FINISH	Q'TY	DRAWING NO.	SCALE	3/1	ISSUE	A	FILE NO.
-----	-------------	----------	--------	------	-------------	-------	-----	-------	---	----------