

© COPYRIGHT 1997 BY SPC TECHNOLOGY. ALL RIGHTS RESERVED. NO PORTION OF THIS PUBLICATION, WHETHER IN WHOLE OR IN PART CAN BE REPRODUCED WITHOUT THE EXPRESS WRITTEN CONSENT OF SPC TECHNOLOGY.

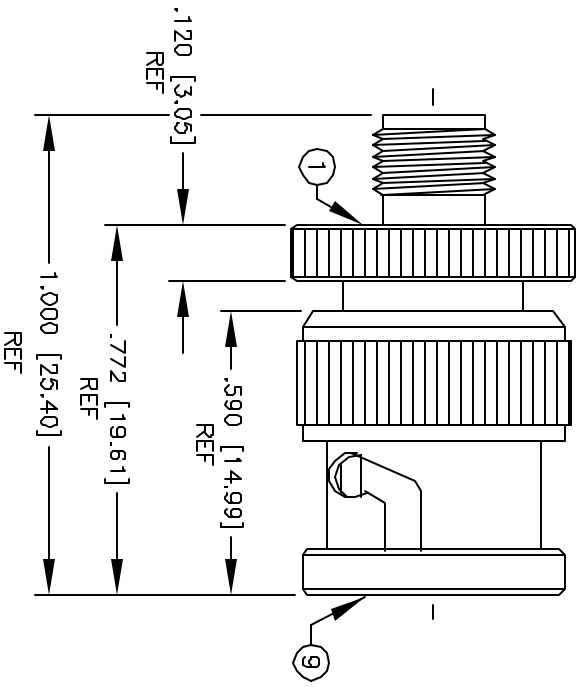

REVISONS		DOC. NO. SPC-FD05, Total Pages: 2
DWG #	REV	Effective: 3/3/97, DCP No: 103 Supersedes DCP No: 97
428	B	CHANGE ELECTRONIC FILE NAME
668	C	CORRECT TITLE
		DRAWN DATE CHECKD DATE APPRVD DATE
		DJC 2/12/98 JJC 2/17/98 JJC 2/17/98
		DJC 11/16/98 JJC 11/17/98 JJC 11/17/98

SPECIFICATIONS:

IMPEDANCE: 50 OHMS
 WORKING VOLTAGE: 335 VRMS @ SEA LEVEL
 FREQUENCY RANGE: 0-4 GHz

ITEM	DESCRIPTION	QTY	MATERIAL	FINISH
8	SHELL	1	BRASS	NICKEL
7	WASHER	1	BRASS	NICKEL
6	SPRING	1	SK-5	NONE
5	SPLIT LOCK WASHER	1	BRASS	NICKEL
4	GASKET	1	S.I. RUBBER	BRT ORANGE
3	DIELECTRIC	1	TEFLON	NONE
2	CONTACT	1	PHOSPHOR BRONZE	GOLD
1	BODY	1	BRASS	NICKEL

DISCLAIMER
 ALL DIMENSIONS AND TECHNICAL INFORMATION CONTAINED HEREIN ARE BASED UPON INFORMATION AND/OR TESTS WE BELIEVE TO BE ACCURATE AND RELIABLE. SOME CONDITIONS OF USE ARE NOT INTENDED USE AND ASSURE ALL RISK AND LIABILITY WHATSOEVER IN CONNECTION THERETHIN.

SPC TECHNOLOGY
 2072400, LL 60040-4198

DRAWING TITLE: **SMA FEMALE TO BNC MALE ADAPTER**

SCALE: NTS

DRAWN BY: DANIEL CAREY DATE: 4/2/97

CHECKED BY: JOHN COLE DATE: 4/8/97

APPROVED BY: BRETT BRAATZ DATE: 4/16/97

SIZE DWG. NO. CAD FILE REV

A 8589-0858 16N2740.DWG C