

| REV. | DATE | DESCRIPTION |
|------|----------|-----------------|
| NC | 03/21/04 | INITIAL RELEASE |

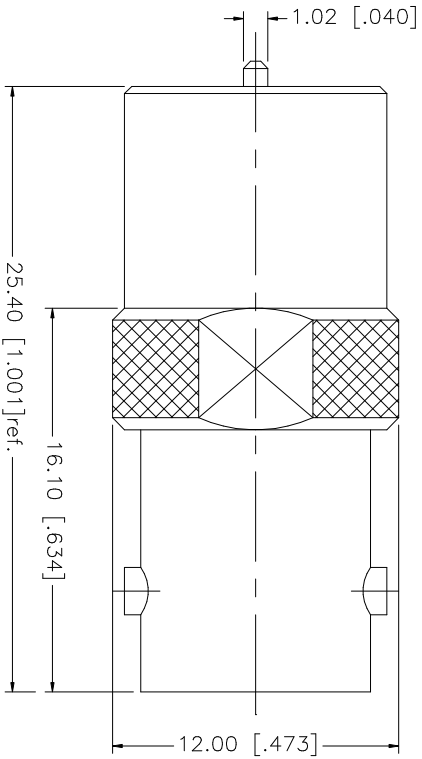

| QTY | FINISH | MATERIAL | DESCRIPTION |
|-----|---------|--------------|-------------|
| 1 | NICKEL | BRASS | BODY |
| 1 | NATURAL | TEFLON | INSULATOR |
| 1 | GOLD | PHOS. BRONZE | CONTACT PIN |

| UNLESS OTHERWISE SPECIFIED DIMENSIONS ARE IN MILLIMETERS DIMENSIONS IN [] ARE IN INCHES AND FOR CUSTOMER REFERENCE ONLY. | UNLESS OTHERWISE SPECIFIED TOLERANCES FOR MILLIMETERS ARE: | UNLESS OTHERWISE SPECIFIED TOLERANCES FOR INCHES ARE: |
|---|--|---|
| | 0.5 - 8mm ± 0.20mm | .020 - .315 = ± 0.007" |
| | 8 - 30mm ± 0.40mm | .315 - 1.180 = ± 0.015" |
| | 30 - 120mm ± 0.50mm | 1.180 - 4.724 = ± 0.020" |

| APPROVALS | DATE |
|--------------|----------|
| DRAWN G.R.S. | 03/21/04 |
| CHECKED | |
| ISSUED | |
| SHEET 1 OF 1 | |

| PART DESCRIPTION | PART NO. | DWG. NO. | REV. | SIZE | SCALE |
|------------------------|----------------------------|------------|------|------|-------|
| Amphenol Connex | BNC JACK TO F PLUG ADAPTER | 242199.DWG | NC | A | NA |
| | 242199 | | | | |