

ALL RIGHTS RESERVED. NO PORTION OF THIS PUBLICATION, WHETHER IN WHOLE OR IN PART CAN BE REPRODUCED WITHOUT THE EXPRESS WRITTEN CONSENT OF SPC TECHNOLOGY.

REVISIONS		DOC. NO.	SPC-FD05	Effective:	12/21/98	Doc No:	880
DOP #	REV	DESCRIPTION	DRAWN	DATE	CHECKD	DATE	APPRVD
	A	RELEASED	J.C.	07/31/91			
755	B	REDRAW	SAS	06/25/99	J.C.	06/25/99	J.C.

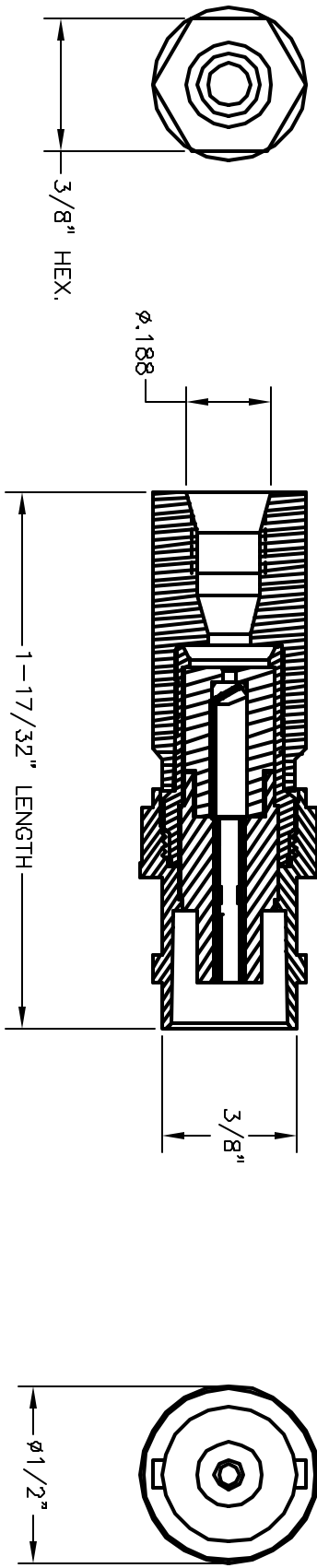

MATERIALS:
 BODY - ZINC
 CONTACT - BRASS
 SPRING WASHER - BERYLLIUM COPPER
 INSULATOR - TPX
 PLATING: BODY - NICKEL
 CONTACT - GOLD

DISCLAIMER
 ALL STATEMENTS AND TECHNICAL INFORMATION CONTAINED HEREIN ARE BASED UPON INFORMATION AND/OR TESTS WE BELIEVE TO BE ACCURATE AND RELIABLE. SINCE CONDITIONS OF USE ARE BEYOND OUR CONTROL, THE USER SHALL DETERMINE THE SUITABILITY OF THE PRODUCT FOR THE INTENDED USE AND ASSUME ALL RISK AND LIABILITY WHATSOEVER IN CONNECTION THEREWITH.

TOLERANCES:	
DECIMALS	ANGLES
.X ± .020	X ± 1'
.XX ± .010	
.XXX ± .005	X'X ± 0'.30'

SPC TECHNOLOGY

DRAWING TITLE: **BNC FEMALE JACK TWIST-ON FOR RG-58**

DWG. NO.: **CPFI-UG89-1**

SCALE: **NTS**

ELECTRONIC FILE: **81N5437.DWG**

REV: **B**

SHEET: **1 OF 1**