

ISS	ZONE	DESCRIPTION\PER	REQUEST\DATE
1			

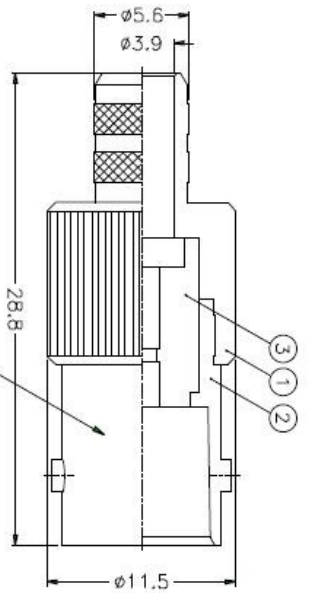
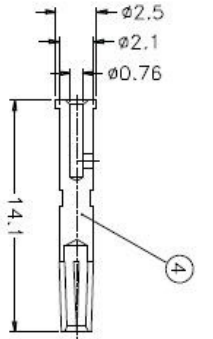
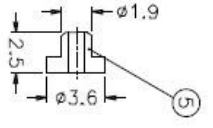
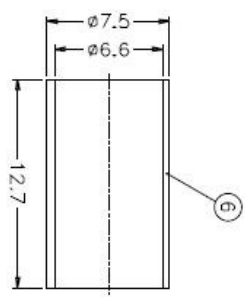
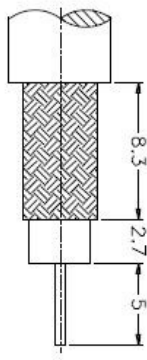

- NOTES: FINISH (PLATING THICKNESS IN MICRO-INCHES)
1. BRASS PER QQ-B-626
  2. NICKEL, P.L. 100 MIN. THICK OVER COPPER STRIKE
  3. PHOSPHOR BRONZE PER QQ-B-750
  4. HARDENED STEEL OVER NICKEL, P.L. 100 MIN. THICK
  5. PTFE MIL-P-19468
  6. JIS H3250, C 2700

1. CRIMPED FERRULE  
HEX CRIMP SIZE .255"
2. CRIMPED CONTACT PIN  
HEX CRIMP SIZE .068"

NO.	DESCRIPTION	MATERIAL	FINISH	QTY	DRAWING NO.	SCALE	3/1	ISSUE	A	FILE NO.
6	FERRULE	NOTE 6	NOTE 2	1	FR-75/66X127					
5	INSULATOR	DELFIN	NATURAL	1	B50000-11-36/1					
4	CONTACT PIN	NOTE 3	NOTE 4	1	B74000-8-25/ 078					
3	INSULATOR	NOTE 5	NATURAL	1	B74000-31-75					
2	BODY	NOTE 1	NOTE 2	1	B74000-2					
1	HOUSING	NOTE 1	NOTE 2	1	B70000-1-56/39					

UNLESS OTHERWISE SPECIFIED	TOLERANCES
0.5-8	±0.2
6-30	±0.4
30-120	±0.5
120-515	±1
315-1000	±1.5
1000-2000	±2.4

PART NO.	DATE
B6121A1-NT3G-3-75	10-11-01*
APPROVED	DATE
CHECKED	DATE
DRAWN	DATE

TITLE	DRAWING NO.	ITEM NO.
<b>Amphenol</b>	KJ-B6121A1-NT3G-62AV-75	
BNC CRIMP JACK		