

**RIGHT ANGLE PLUG CRIMP-TYPE**

**R161A.182.000**

**FOR CABLE 5/50S**

Series : **ECO N 50**

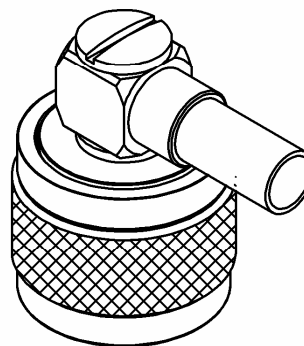
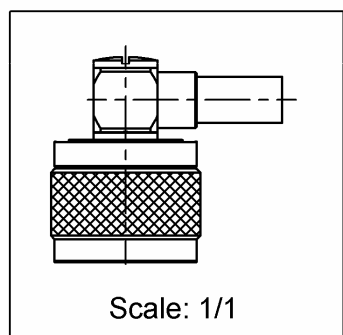
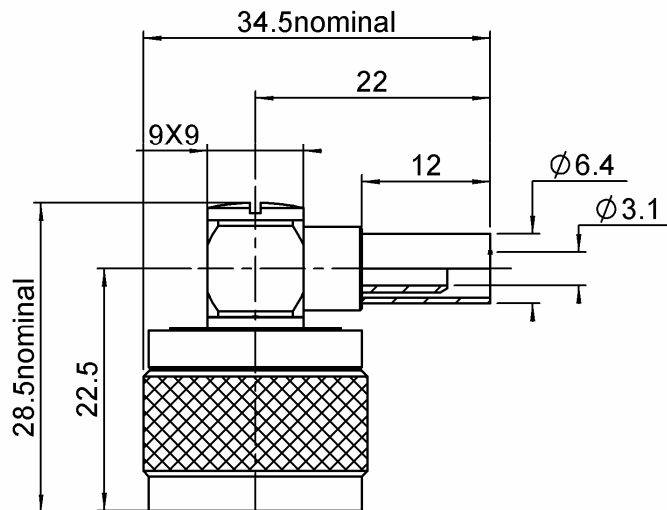

All dimensions are in mm.

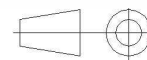

COMPONENTS	MATERIALS	PLATING (µm)
BODY	BRASS	BBR
CENTER CONTACT	BRASS	GOLD
OUTER CONTACT	BRASS	BBR
INSULATOR	PTFE	
GASKET	SILICONE RUBBER	
OTHERS PARTS	BRASS	BBR
-	-	-
-	-	-

**Issue : 0933 A**

In the effort to improve our products, we reserve the right to make changes judged to be necessary.



**RIGHT ANGLE PLUG CRIMP-TYPE**

**R161A.182.000**

**FOR CABLE 5/50S**

Series : **ECO N 50**

**PACKAGING**

Standard	Unit	Other
<b>50</b>	<b>'W' option</b>	<b>Contact us</b>

**SPECIFICATION**

**ELECTRICAL CHARACTERISTICS**

Impedance	<b>50</b> Ω
Frequency	<b>0-6</b> GHz
VSWR	<b>1.35 + 0.0000</b> x F(GHz) Maxi
Insertion loss	<b>0.1</b> √F(GHz) dB Maxi
RF leakage	- ( <b>NA</b> - F(GHz)) dB Maxi
Voltage rating	<b>850</b> Veff Maxi
Dielectric withstanding voltage	<b>1500</b> Veff mini
Insulation resistance	<b>5000</b> MΩ mini

**CABLE ASSEMBLY**

Stripping	a	b	c	d	e	f
mm	3.50	7.00	18.0	0.00	14.5	0.00

Assembly instruction : **Crimp 07**

Recommended cable(s)  
 RG 58  
 KX 15  
 RG 141  
 BSSM 742

**MECHANICAL CHARACTERISTICS**

Center contact retention	
Axial force – Mating end	<b>27</b> N mini
Axial force – Opposite end	<b>27</b> N mini
Torque	<b>NA</b> N.cm mini

Characteristics indicated on this data sheet are those that can be achieved with the highest performance cable. Intrinsic limitations of the cable may diminish the performance of the assembly

Cable retention  
 - pull off **150** N mini  
 - torque **NA** N.cm

Recommended torque	
Mating	<b>130</b> N.cm
Panel nut	<b>NA</b> N.cm
Clamp nut	<b>NA</b> N.cm
A/F clamp nut	<b>0.0000</b> mm
Mating life	<b>100</b> Cycles mini
Weight	<b>36.2</b> g

**TOOLING**

Part Number	Description	Hexagon
R282.223.000	CRIMPING TOOL	5.41
R282.235.011	CRIMPING DIES M22520/5-11	5.41
R282.293.000	CRIMPING TOOL M22520/5-01	

**ENVIRONMENTAL**

Operating temperature	<b>-40/+85</b> ° C
Hermetic seal	<b>NA</b> Atm.cm3/s
Panel leakage	<b>NA</b>

**OTHER CHARACTERISTICS**

-

**Issue : 0933 A**

In the effort to improve our products, we reserve the right to make changes judged to be necessary.

