

DATA CONTAINED IN THIS DOCUMENT IS UNCLASSIFIED EXCEPT WHERE SHOWN OTHERWISE. IT IS THE PROPERTY OF TROMPETER ELECTRONICS, INC. AND SHALL NOT BE DISTRIBUTED OUTSIDE THE COMPANY OR FOR REPRODUCTION OR TRANSMISSION IN ANY FORM OR BY ANY MEANS, ELECTRONIC OR MECHANICAL, INCLUDING PHOTOCOPYING, RECORDING, OR BY ANY INFORMATION STORAGE AND RETRIEVAL SYSTEM.

| REVISIONS | | | |
|-----------|-----------------------|---------|----------|
| REV | DESCRIPTION | DATE | APPROVED |
| U | REVISED PER ECO 14778 | 11-5-02 | W |

| DASH NO. | CABLES ACCOMMODATED | A DIM | B DIM | C FLATS | D FLATS | E DIA | ASSEMBLE PER |
|----------|---|-------|-------|---------|---------|-------|--------------|
| -7 | TRC-50-2 TRC-75-2 | 1.135 | .096 | .438 | .438 | .500 | TAI-189 |
| -8 | B227, BELDEN | 1.716 | .130 | .625 | .688 | .750 | TAI-103 |
| -9 | TWC-78-2 TWC-124-2 | 1.135 | .096 | .438 | .438 | .500 | TAI-102 |
| -A9 | BL782, TIMES BL802, TIMES BL1242, TIMES | | | △ | △ | | |
| -10 | R6-22 754E, AT&T | | | | | | TAI-103 |
| -11 | 760A, AT&T | 1.716 | .130 | .625 | .688 | .750 | TAI-128 |
| -12 | 16 PEVL, AT&T V1-AL, GENERAL | | | | | | TAI-129 |
| -13 | TRF-50, TIMES | | | | | | TAI-129 |
| -13A | B232, BELDEN | | | | | | TAI-129 |
| -14 | B233, BELDEN | | | | | | TAI-129 |
| -23 | 250-3884, MICRODOT | | | | | | TAI-189 |
| -24 | 202-3934, MICRODOT | | | | | | TAI-102 |
| -24A | 9530A5117, RAYCHEM | | | | | | TAI-189 |
| -25 | T-43M, GENERAL | | | | | | TAI-102 |
| -25A | S021H5311, RAYCHEM | | | | | | TAI-189 |
| -26 | 7028A5116, RAYCHEM T187PSJ2618EN, MOVEN | | | | | | TAI-189 |
| -27 | 202-3927, MICRODOT 202-3942, MICRODOT | | | | | | TAI-102 |
| -29 | TWC-78-1/TWC-124-1A 761A, AT&T B441, BELDEN | 1.135 | .096 | .438 | .438 | .500 | TAI-102 |
| -30 | | | | | | | |
| -32 | TRC-50-1 | | | | | | TAI-189 |
| -33 | TRC-75-1 | | | | | | TAI-189 |
| -42 | 21-204, ESSEX 4493, CONSOLIDATED | | | | | | TAI-189 |
| -43 | 250-4044/250-4045 293-3930, MICRODOT | | | | | | TAI-102 |
| -45 | M27500-22TE214 1100-66F, STANDARD | | | | | | TAI-103 |
| -46 | B860, BELDEN | 1.716 | .130 | .625 | .688 | .750 | TAI-103 |
| -47 | M17176-00002 | 1.135 | .096 | .438 | .438 | .500 | TAI-102 |
| -49 | TWAC-78-1F2 | 1.716 | .130 | .625 | .688 | .750 | TAI-102 |
| -54 | B9207, BELDEN | | | | | | TAI-189 |
| -55 | B9272, BELDEN | | | | | | TAI-189 |
| -56 | GC875G1, GRUMMAN | 1.135 | .096 | .438 | .438 | .500 | TAI-102 |
| -57 | GC875G1, GRUMMAN | | | | | | TAI-102 |
| -59 | GC875T244, GRUMMAN | | | | | | TAI-189 |
| -59 | GC875L1, GRUMMAN | | | | | | TAI-189 |
| -60 | M17177, THERMATICS 380-10045, BOEING | | | | | | TAI-189 |
| -64 | 7528A5314, RAYCHEM | | | | | | TAI-189 |

FIG 1 △
-9 SHOWN

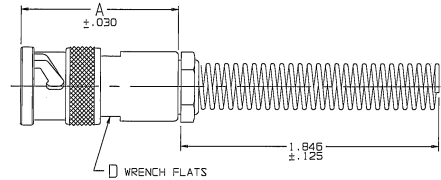
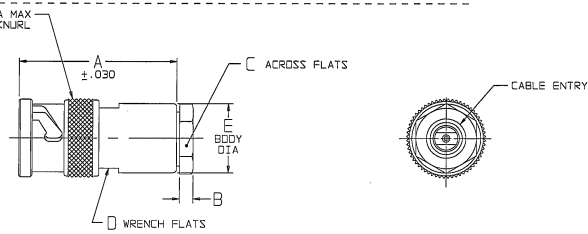

FIG 2 △
-9 SHOWN



| CABLE ENTRY | | | |
|-------------|------|----------|------|
| DASH NO. | DIA | DASH NO. | DIA |
| -7 | .274 | -29 | .191 |
| -8 | .345 | -30 | .235 |
| -9 | | -32 | .191 |
| -A9 | .285 | -33 | .217 |
| -10 | .455 | -42 | .300 |
| -11 | .347 | -43 | .200 |
| -12 | .485 | -45 | .193 |
| -13 | .352 | -46 | .475 |
| -13A | .352 | -47 | .164 |
| -14 | .490 | -49 | .132 |
| -23 | .183 | -54 | .323 |
| -24 | .191 | -55 | .250 |
| -24A | .200 | -56 | .191 |
| -25 | .285 | -57 | |
| -25A | | -58 | .198 |
| -26 | .191 | -59 | .217 |
| -27 | .145 | -60 | .217 |
| | | -64 | .183 |

RED INDICATES ORIGINAL

6. EXAMPLE OF A COMPLETE MODEL NO.
PL74 -47 △

BASIC MODEL NO. DASH NO.
IF BEND RELIEF SPRING REQD (SEE FIG 1)
ADD SUFFIX "BR" TO MODEL NO.
(NOT AVAILABLE WITH CABLE GROUPS -8, -10, -11, -12, -13, -13A, -14, -46 & -54)

- △ CLAMP NUT OMITTED
- △ 2-LUG BAYONET CONCENTRIC TWINAX/TRIAX TRB CABLE PLUG
- 2. FINISH: TFS-1A (NICKEL)
- 1. ALL DIM ARE IN INCHES

| TYPE | DASH NO./CABLE GROUP | | | | | | | | | | | | | | | | |
|--------|----------------------|-----|------|-----|-----|------|------|-----|-----|-----|-----|-----|-----|-----|-----|-----|-----|
| TWINAX | -8 | -9 | -A9 | -10 | -11 | -12 | -24 | -25 | -27 | -29 | -30 | -45 | -46 | -47 | -49 | -54 | -55 |
| TRIAX | -7 | -13 | -13A | -14 | -23 | -24A | -25A | -26 | -32 | -33 | -42 | -43 | -56 | -57 | -59 | -60 | -64 |
| QUADAX | -58 | | | | | | | | | | | | | | | | |

| | | | |
|---|--|-----------------------------|--|
| INTERPRET DRAWING PER REVISIONS DRAWING AS IN INCHES NO DIMENSIONS SPECIFIED UNLESS OTHERWISE SPECIFIED | DATE: 11-4-02 DRAWN: AAH CHECKED: JLN DATE: 11-5-02 DRAWN: JLN CHECKED: JLN | SCALE: 1:1 DATE: 3/27/78 | <p>TROMPETER ELECTRONICS, INC.</p> <p>PL74/PL74BR</p> <p>SIZE: B CASE CODE: 14949 DRAWING NO.: 310-0025 REV.: U</p> <p>SCALE: NONE DATE: 3/27/78 SHEET: 1C</p> |
|---|--|-----------------------------|--|