

SUGGESTED STRIPPING INSTRUCTIONS
SUGGESTED CRIMP: .213
PIN TO BE SOLDERED

REVISIONS		DDC. NO. SPC-FD05, Total Pages: 2						
DCP #	REV	DESCRIPTION	DRAWN	DATE	CHECKD	DATE	APPRVD	DATE
18	A	RELEASED	D.J.C.	4/2/97	J.C.	4/8/97	B.B.	4/16/97
428	B	CHANGE ELECTRONIC FILE NAME	DJC	2/12/98	JC	2/17/98	JC	2/17/98

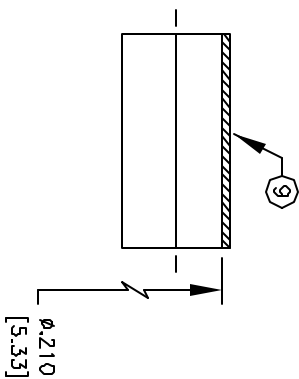

SPECIFICATIONS:

IMPEDANCE: 50 OHMS
WORKING VOLTAGE: 500V PEAK @ SEA LEVEL
FREQUENCY RANGE: 0-12.4 GHz
INSERTION LOSS: \leq -.2 dB @ 6 GHz
VSWR MAXIMUM: 1.3:1 @ 6 GHz
FOR RG-58, 58A, 58C, 141, 141A, 400/U, BELDEN 8240,
8259, 8262, 9201, 9203, 9310, 9311 CABLE

ITEM	DESCRIPTION	QTY	MATERIAL	FINISH
9	FERRULE	1	BRASS	NICKEL
8	END CAP	1	BRASS	NICKEL
7	FERRULE STUD	1	BRASS	NICKEL
6	SHELL	1	BRASS	NICKEL
5	RETAINING RING	1	BERILLIUM COPPER	NONE
4	GASKET	1	S.I. RUBBER	BRIGHT ORANGE
3	DIELECTRIC	1	TEFLON	NONE
2	PIN	1	BRASS	GOLD
1	BODY	1	BRASS	NICKEL

DISCLAIMER
ALL STATEMENTS AND TECHNICAL INFORMATION CONTAINED HEREIN ARE BASED UPON INFORMATION AND/OR TESTS WE BELIEVE TO BE ACCURATE AND RELIABLE. SINCE CONDITIONS OF USE ARE BEYOND OUR CONTROL, THE USER SHALL DETERMINE THE SUITABILITY OF THE PRODUCT FOR THE INTENDED USE AND ASSUME ALL RISK AND LIABILITY WHATSOEVER IN CONNECTION THEREWITH.



SPC TECHNOLOGY
CORPORA, IL 60940-4498

DIMENSIONS ARE FOR REFERENCE PURPOSES ONLY.

DRAWN BY:	DATE:
DANIEL CAREY	4/2/97
CHECKED BY:	DATE:
JOHN COLE	4/8/97
APPROVED BY:	DATE:
BRETT BRAATZ	4/16/97

DRAWING TITLE:		SMA MALE RIGHT ANGLE CRIMP	
SIZE	DWG. NO.	CAD FILE	REV
A	8589-0838	16N2720.DWG	B
SCALE:	NTS	U.O.M.: INCHES [mm]	SHEET: 1 OF 1