

© COPYRIGHT 1997 BY SPC TECHNOLOGY. ALL RIGHTS RESERVED. NO PORTION OF THIS PUBLICATION, WHETHER IN WHOLE OR IN PART CAN BE REPRODUCED WITHOUT THE EXPRESS WRITTEN CONSENT OF SPC TECHNOLOGY.

REVISIONS		DOC. NO. SPC-FD05, Total Pages: 2						
DCP #	REV	DESCRIPTION	DRAWN	DATE	CHECKD	DATE	APPRVD	DATE
565	C	REMOVED FLATS FROM ITEM 1	DJC	7/2/98	JC	7/6/98	JC	7/8/98
590	D	Added Heat Shrink, Changed Ferrule	DJC	8/10/98	JC	8/11/98	JC	8/11/98

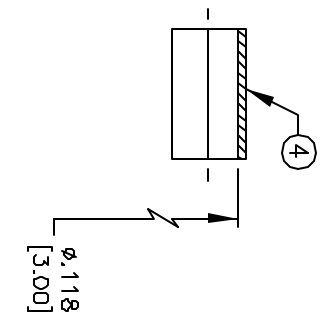
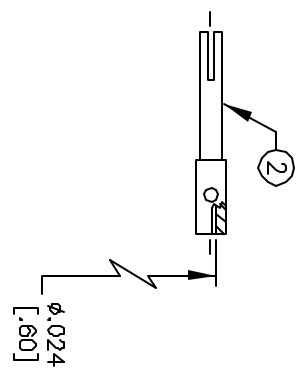
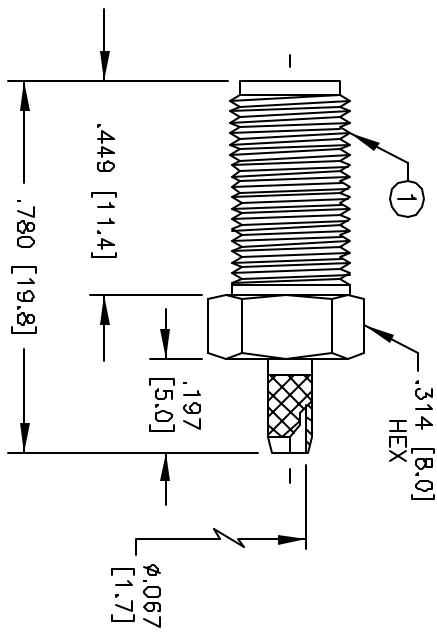

SPECIFICATIONS:

IMPEDANCE: 50 OHMS
 WORKING VOLTAGE: 375V PEAK @ SEA LEVEL
 FREQUENCY RANGE: 0-12.4 GHz
 INSERTION LOSS: 5-.2 dB @ 5 GHz
 VSWR MAXIMUM: 1.3:1 @ 12 GHz
 FOR RG-174, 188, 188A, 316/U, ALPHA 9174, 9316, BELDEN 8216, 83269, 84316 & TIMES LMR-100 CABLE INTERFACE PER MIL-STD-348A, SECTION 310.2

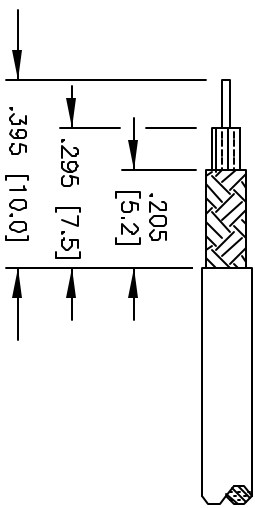
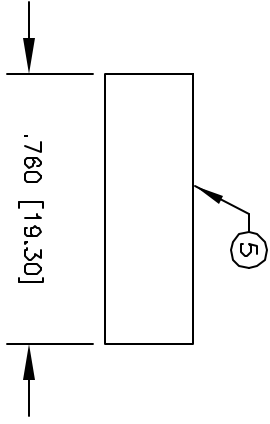

SUGGESTED STRIPPING INSTRUCTIONS
SUGGESTED CRIMP: .130
CONTACT TO BE SOLDERED

ITEM	DESCRIPTION	QTY	MATERIAL	FINISH
5	TUBING	1	HEAT SHRINK	BLACK
4	FERRULE	1	BRASS	NICKEL
3	DIELECTRIC	1	TEFLON	NONE
2	CONTACT	1	BERYLLIUM COPPER	GOLD
1	BODY	1	BRASS	NICKEL

DISCLAIMER
 ALL STATEMENTS AND TECHNICAL INFORMATION CONTAINED HEREIN ARE BASED UPON INFORMATION AND/OR TESTS WE BELIEVE TO BE ACCURATE AND RELIABLE. SPC TECHNOLOGY OF ILLINOIS ACCEPTS NO LIABILITY FOR THE USE OF THIS PRODUCT IN CONNECTION WITH OTHER PRODUCTS OR SYSTEMS. THE USER SHALL DETERMINE THE SUITABILITY OF THE PRODUCT FOR THE INTENDED USE AND ASSUME ALL RISK AND LIABILITY WHATSOEVER IN CONNECTION THEREWITH.



DRAWING TITLE: **SMA FEMALE CRIMP**

DRAWN BY: DANIEL CAREY	DATE: 4/1/97	SIZE: A	DWG. NO.: 8589-0835	CAD FILE: 16N2717.DWG	REV: D
CHECKED BY: JOHN COLE	DATE: 4/8/97	SCALE: NTS	U.O.M.: INCHES [mm]	SHEET: 1	OF 1
APPROVED BY: BRETT BRAATZ	DATE: 4/16/97	DIMENSIONS ARE FOR REFERENCE PURPOSES ONLY.			