

ALL RIGHTS RESERVED. NO PORTION OF THIS PUBLICATION, WHETHER IN WHOLE OR IN PART CAN BE REPRODUCED WITHOUT THE EXPRESS WRITTEN CONSENT OF SPC TECHNOLOGY.

REVISIONS				DOC. NO. SPC-F005	Effective: 12/21/98			DCP No. 860
DCP #	REV	DESCRIPTION	DRAWN	DATE	CHECKD	DATE	APPRVD	DATE
129	A	RELEASED	DJC	7/15/98	JJC	7/15/98	JMM	7/15/98
718	B	CHANGED DIMENSIONS	DJC	3/8/99	JJC	3/9/99	JJC	3/9/99

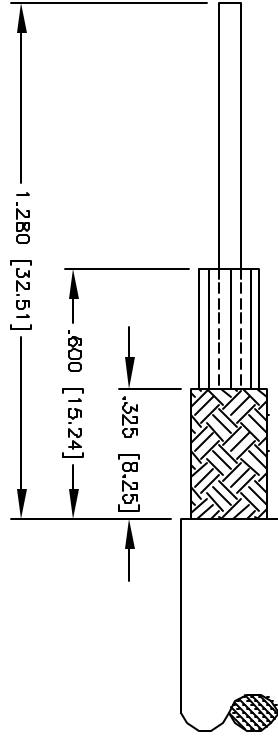
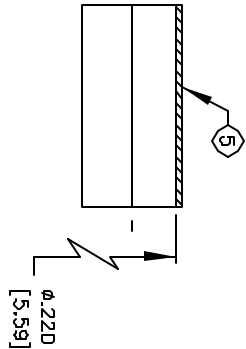
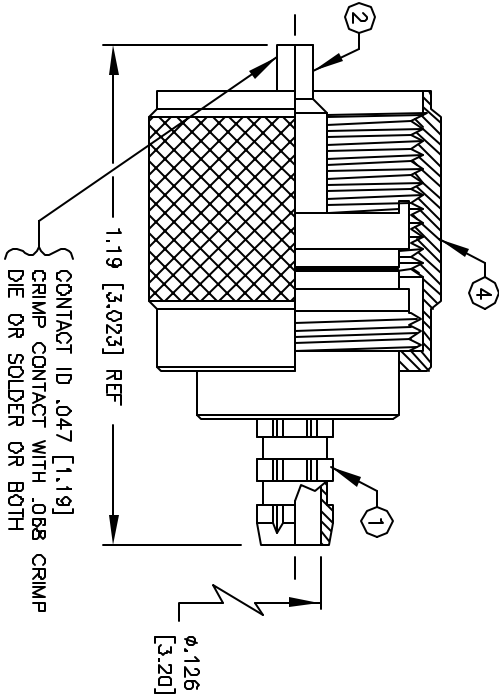

### SPECIFICATIONS:

IMPEDANCE: NON CONSTANT  
WORKING VOLTAGE: 500 VRMS @ SEA LEVEL  
FREQUENCY RANGE: 0-300 MHz  
FOR RG-58, 58A, 58C, 141, 141A, 400/U, BELDEN  
B240, B259, B262, 9201, 9203, 9310, 9311,  
COMM/SCOPE 0268 & CUSHCRAFT ULTRALINK TL92463E  
FOR TIMES LMR-200, LMR-200 ULTRAFLEX, ALPHA 9848 & MSI-22

5	FERRULE	1	BRASS	SILVER
4	SHELL	1	BRASS	SILVER
3	DIELECTRIC	1	TEFLON	NONE
2	CONTACT	1	BRASS	SILVER
1	BODY	1	BRASS	SILVER
ITEM	DESCRIPTION	QTY	MATERIAL	FINISH

DISCLAIMER  
ALL STATEMENTS AND TECHNICAL INFORMATION CONTAINED HEREIN ARE BASED UPON INFORMATION AND/OR TESTS WE BELIEVE TO BE ACCURATE AND RELIABLE. SINCE CONDITIONS OF USE ARE BEYOND OUR CONTROL, THE USER SHALL DETERMINE THE SUITABILITY OF THE PRODUCT FOR THE INTENDED USE AND ASSUME ALL RISK AND LIABILITY WHATSOEVER IN CONNECTION THEREWITH.



DRAWING TITLE:				UHF MALE CRIMP			
DRAWN BY:		DATE:		SIZE		DWG. NO.	
DANIEL CAREY		7/15/98		A		1534	
CHECKED BY:		DATE:		ELECTRONIC FILE		92N3380.DWG	
JOHN COLE		7/15/98		REV		B	
APPROVED BY:		DATE:		SCALE:		NTS	
JEFF MCVICKER		7/15/98		U.O.M.: INCHES [mm]		SHEET: 1 OF 1	