

Customer Information Sheet

DRAWING No. - D26XX-XX

SHEET 2 OF 2

IF IN DOUBT - ASK

©

NOT TO SCALE

THIRD ANGLE PROJECTION

ALL DIMENSIONS IN mm

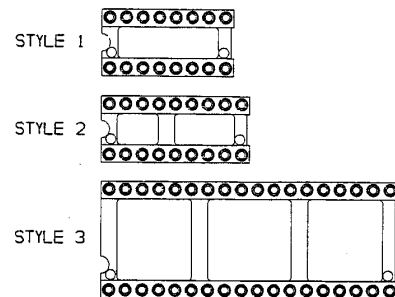
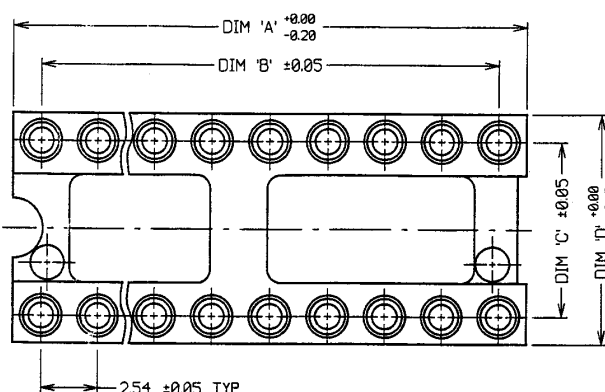
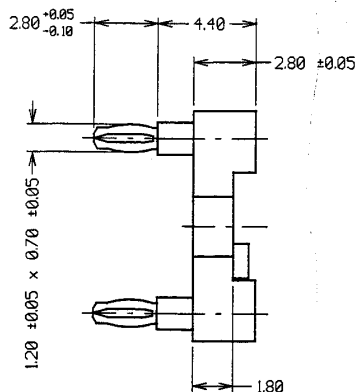

ORDER CODE:

D26XX-XX

No. OF WAYS (SEE TABLE)

FINISH:

01 - TIN/LEAD SHELL, GOLD CLIP

T6 - TIN/LEAD SHELL, TIN/LEAD CLIP

HARWIN PART No.	No. OF WAYS	STYLE	DIM 'A'	DIM 'B'	DIM 'C'	DIM 'D'
D2606-XX	6	1	7.6	5.08	7.62	10.02
D2608-XX	8	1	10.1	7.62	7.62	10.02
D2614-XX	14	1	17.17	15.24	7.62	10.02
D2616-XX	16	1	20.3	17.78	7.62	10.02
D2618-XX	18	2	22.8	20.32	7.62	10.02
D2620-XX	20	2	25.3	22.86	7.62	10.02
D2622-XX	22	2	27.8	25.40	10.16	12.56
D2624-XX	24	2	30.4	27.94	15.24	17.64
D2628-XX	28	2	35.5	33.02	15.24	17.64
D2632-XX	32	2	40.6	38.10	15.24	17.64
D2640-XX	40	3	50.6	48.26	15.24	17.64

NOTES:

- 1. RECOMMENDED HOLE SIZE = $\varnothing 1.09-0.94mm$.
- RECOMMENDED BOARD THICKNESS = 1.5 TO 2.0mm.

SPECIFICATIONS:

MATERIAL:

- MOULDING - GLASS-FILLED POLYESTER UL94V-0
- CONTACT SHELL - BRASS
- CONTACT CLIP - BERYLLIUM COPPER

FINISH:

- 01 - SHELL = 5 μ 90/10 TIN/LEAD OVER 2-3 μ NICKEL
CLIP = 0.25 μ GOLD OVER 2-3 μ NICKEL
- T6 - SHELL = 5 μ 90/10 TIN/LEAD OVER 2-3 μ NICKEL
CLIP = 5 μ 90/10 TIN/LEAD OVER 2-3 μ NICKEL

ELECTRICAL:

- CURRENT RATING = 1 AMP
- VOLTAGE RATING = 100V AC, 150V DC
- CONTACT RESISTANCE = 10 MILLIOHMS MAX
- INSULATION RESISTANCE = 10,000 MEGOHMS MIN
- DIELECTRIC WITHSTANDING = 1000V AC MIN

MECHANICAL:

- INSERTION FORCE = 3.0N MAX ($\varnothing 0.46mm$ GAUGE)
- WITHDRAWAL FORCE = 0.3N MIN ($\varnothing 0.46mm$ GAUGE)
- SOLDERABILITY = 260°C FOR 5 SECONDS
- DURABILITY = 100 CYCLES

ENVIRONMENTAL:

- TEMPERATURE RANGE = -55°C TO +125°C

PACKING:

TUBE

FOR COMPLETE SPECIFICATION, SEE COMPONENT SPECIFICATION C004XX (LATEST ISSUE).

2	03.12.97	4185
1	27.08.97	----
ISS.	DATE	C/N
APPROVED: <i>W.S.S.</i>		
CHECKED: <i>D. Beck</i>		
DRAWN: D. BECK		
CUSTOMER REF.		
ASSEMBLY DRG.		

HARWIN			TOLERANCES X = $\pm 1mm$ XX = $\pm 0.25mm$ XXX = $\pm 0.10mm$ XXXX = $\pm 0.01mm$ ANGLES = $\pm 1^\circ$ UNLESS STATED	MATERIAL: SEE ABOVE FINISH: SEE ABOVE S/AREA: mm ²	TITLE: DIL IC SOCKET OPEN FRAME, PRESS-FIT DRAWING NUMBER: D26XX-XX	SHT 2 OF 2
HARWIN INC U.S.A. TEL: (812) 285 0055 FAX: (812) 285 0056	HARWIN PLC UK. TEL: 01785 370451 FAX: 01785 314598	HARWIN PTE SINGAPORE TEL: 65 7794989 FAX: 65 7793868				