

**PRODUCT NUMBER**  
98424-X52-XX-XXXLF

PLATING \_\_\_\_\_ WHEN REQUIRED, ADD SUFFIX LETTER "LF"  
INDICATES THE PRODUCT IS RoHS  
COMPATIBLE, SEE NOTE 8

S = 0.38µm GOLD/GXT ON CONTACT AREA  
3.81µm TIN LEAD ON TAIL

G = 0.76µm GOLD/GXT ON CONTACT AREA  
3.81µm TIN LEAD ON TAIL

F = GOLD FASH ON CONTACT AREA  
3.81µm TIN LEAD ON TAIL

\_\_\_\_\_ POLARIZATION (SEE NOTE 7)

\_\_\_\_\_ PACKAGING OPTIONAL LETTER (SEE NOTE 5)

\_\_\_\_\_ TOTAL NB OF POSITIONS, 04 TO 50

**NOTES:**

- MATERIAL HOUSING: HIGH TEMP. THERMOPLASTIC  
UL 94V-0, COLOR CREAM
- MATERIAL TERMINAL: COPPER ALLOY
- TO DETERMINE DIMENSIONS:  
N = NUMBER OF POSITIONS PER ROW
- 7N MIN. PIN RETENTION IN EITHER DIRECTION.
- PACKAGING:  
= PLASTIC BOX  
- = PLASTIC BOX WHEN POLARISATION FEATURE APPLICABLE  
U = TUBE AVAILABLE FROM 08 TO 50 POS  
A = TAPE AND REEL WITH PICK UP CAP INSTALLED IN THE CENTER OF THE PRODUCT FOR PICK AND PLACE, SEE TA884 FOR AVAILABILITY.  
K = TAPE AND REEL WITHOUT PICK UP CAP  
C = TAPE AND REEL WITH SPECIAL LARGE CAP, ONLY FOR 98424-Y52-06CLF FOR ALL SPECIAL PACKAGING, FCI TO BE CONTACTED

- DIM "C" = (N x 2) + 1.4  
EXAMPLE: N = 7  
DIM "C" = (7 x 2) + 1.4
- FOR POLARIZATION, SPECIFIED PIN  
EXAMPLE : A03 = ROW A, POSITION 03 TO OMIT PIN  
OMIT FROM PRODUCT NUMBER IF THIS FEATURE IS NOT APPLICABLE

- RoHS COMPATIBLE PRODUCT SPECIFICATIONS
  - PLATING:  
- "LF" MEANS THE PRODUCT IS LEAD-FREE,  
2µm MINIMUM MATTE TIN OVER 1.27µm  
MINIMUM NICKEL UNDERPLATE.
  - MANUFACTURING PROCESS COMPATIBILITY  
- THE HOUSING WILL WITHSTAND EXPOSURE TO  
260°C PEAK TEMPERATURE FOR 30 SECONDES  
MAX IN A CONVECTION, INFRA-RED OR VAPOR  
PHASE OR REFLOW OVEN.
  - LABELLING:  
- MEETS PACKAGING SPECS AS PER GS-14-920  
- THIS PRODUCT MEETS EUROPEAN DIRECTIVES  
AND OTHER COUNTRY REGULATIONS AS DISCRIBED  
IN GS-22-008.

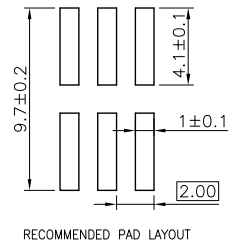
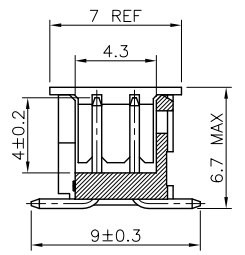
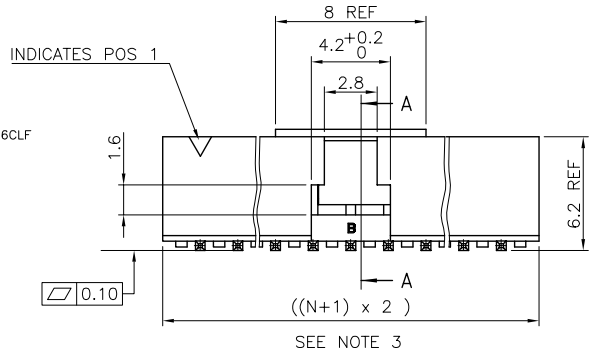
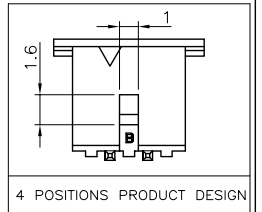
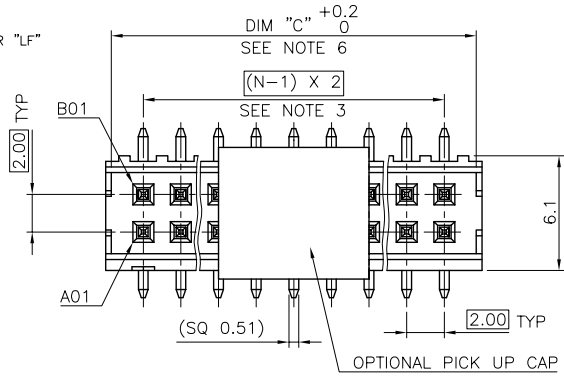

mat'l. code	surface	tolerance	projection	product family
SEE NOTES	ISO 1302	ISO 406 ISO	101	MINITEK
Ltr	ecn no	dr	date	tolerances unless otherwise specified
N	F10-0007	JCO	10.01.28	angles linear X.X ±0.3
H	F05-0124	LMU	05.02.07	X.XXX ±0.05
J	F06-0210	LMU	06.07.05	dr L.MULIN 04.09.27
K	F06-0255	LMU	06.08.28	eng J.COMPAGNON 04.09.27
L	F08-0113	LMU	08.01.17	chr
M	F08-0145	ELA	17.04.08	app JMC 04.09.27
sheet index	revision	N	A	scale 1:1
	1	2		

title  
**SHR HEADER**  
2.00 VERTICAL SMT

dwg no  
98424

sheet 1 of 2

size  
A3

type  
CUSTOMER Drawing

FCI  
FCIconnect.com  
Copyright FCI

1 | 2 | 3 | 4 | 5 | 6

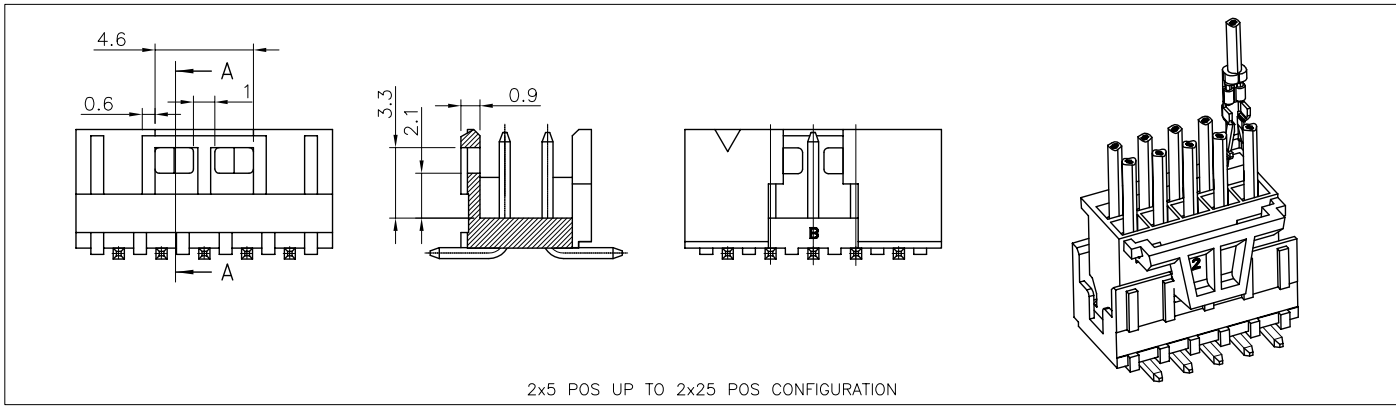
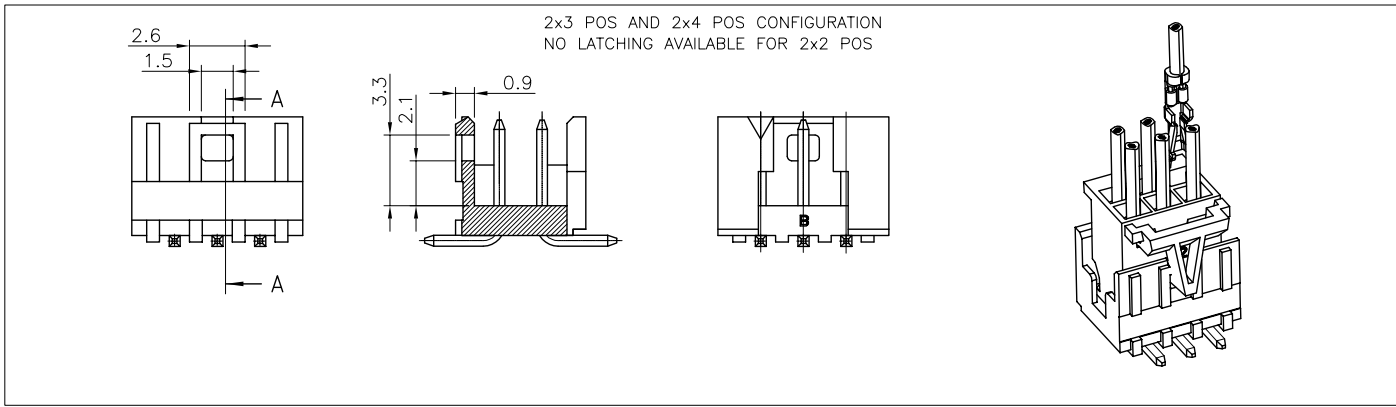

LATCHING FEATURES WHEN USED IN COMBINATION  
WITH ACTIVE LATCH HOUSING 10073599

mat'l. code	surface	tolerance	projection	product family
SEE NOTES	ISO 1302	ISO 406 ISO	101	MINITEK
ltr	ecn no	dr	date	title
A	F08-0113	LMU	08.01.17	SHR HEADER 2.00 VERTICAL SMT
				dwg no
				98424
				sheet 2 of - size
				A3
				type
				CUSTOMER Drawing

dr	J.MULIN	07.11.06
engr	J.COMPAGNON	07.11.06
chr		
appd	J.M.C	07.11.06
sheet index	revision sheet	

PDM: Rev:N STATUS Released Printed: Apr 02, 2010



Copyright FCI

form: A3

1 | 2 | 3 | 4 | 5 | 6