

PART NUMBERING SYSTEM

M80 - X #X XX XX #X - XX - XXX - XX - XXX

PRODUCT RANGE

GENDER

4	Female (Socket)
5	Male (Plug)

SIGNAL CONTACT STYLE

00	No Signal Contacts
T1	Vertical PC Tail, 3mm tail
T2	Vertical PC Tail, 4.5mm tail
L1	Horizontal PC Tail, 3mm tail (Male only)
L2	Horizontal PC Tail, 4.5mm tail (Male only)
C1	Crimp 24-28 AWG (Small Bore)
D1	Crimp 22 AWG (Large Bore)
S1	Vertical Surface Mount
S2	Horizontal Surface Mount (Male only)

NO. OF SIGNAL CONTACTS

00, 02 to 50 (Must be even number)

SIGNAL CONTACT FINISH

	00	No Signal Contacts	
	01	Gold + Tin/Lead	Female PC Tail only
	05	Gold	
	22	Gold + Tin/Lead	Male PC Tail only
	42	Gold + Tin	All PC Tail & Female Crimp

PART NUMBER OF SPECIAL CONTACTS AFTER FINAL SIGNAL CONTACT

See following page, or 000 if none loaded

NUMBER OF SPECIAL CONTACTS AFTER FINAL SIGNAL CONTACT

00 to 12

PART NUMBER OF SPECIAL CONTACTS BEFORE SIGNAL CONTACT NO. 1

See following page, or 000 if none loaded

NUMBER OF SPECIAL CONTACTS BEFORE SIGNAL CONTACT NO. 1

00 to 12

JACKSCREW VARIANT (see following page)

00	None assembled
F1	Hexagonal slotted jackscrew (Female only)
F2	Hex socket jackscrew (Female only)
F3	Guide Pin with Panel Mount (Female only)
M1	Jackscrew Nut only (Male only)
M2	Jackscrew Nut with Vertical 3.5mm Board Mount Stud (Male only)
M3	Jackscrew Nut with Vertical 5mm Board Mount Stud (Male only)
M5	Jackscrew Nut with Horizontal 5mm Board Mount Slotted Bolt (Male only)
M7	Jackscrew Nut with Horizontal 5mm Board Mount Hex Skt Bolt (Male only)

Note: If special contacts are being ordered separately, and cavities in mould are to be left empty, then the Special Contact part numbers should be 000.

EXAMPLES:

M80-5T11422M1-02-311-02-311

DIL Male Vertical with Jackscrew, no board mount, 3mm PC Tail - 2 Coax, 14 Signal, 2 Coax.

M80-4C12005F1-04-326-00-000

DIL Female Crimp with Slotted Hex Jackscrews, Small Bore - 4 Power (for 14 AWG), 20 Signal

M80-4D11042F2-04-305-02-308

DIL Female Crimp with Hex Socket Jackscrews, Large Bore - 4 Special cavity, 10 Signal, 2 Special cavity.

Supplied with 4-off Female Straight Crimp Coax for Ø2mm cable, and 2-off Female 90° Crimp Coax for Ø2mm cable.

Max. number of contacts per connector: Special contacts only - 12 off, Signal contacts only - 50 off.

www.harwin.com



Datamate

SPECIFICATION

JACKSCREWS

NONE ASSEMBLED (MALE & FEMALE)

00

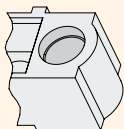

Pages 38, 39, 40

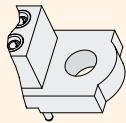

Pages 41, 42

FOR MALE ASSEMBLIES

M1

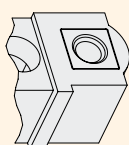
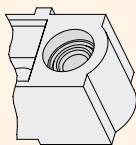

Jackscrew Nut Only

Pages 38, 39, 40

M2
or
M3

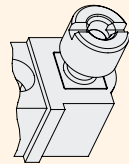
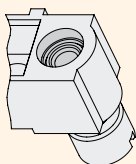

Jackscrew Nut with Vertical Board Mount Stud

Page 38

M5
or
M7

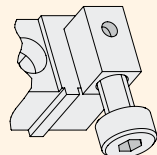
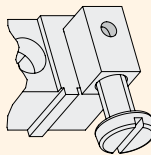

Jackscrew Nut with Horizontal Board Mount Stud

Page 38

FOR FEMALE ASSEMBLIES

F1

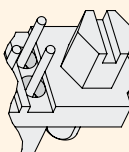
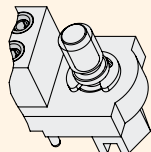

Hexagonal Slotted Jackscrew

Pages 41, 42

F2

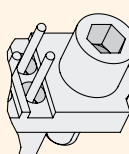
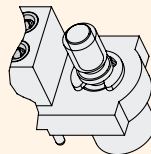

Hex Socket Jackscrew

Pages 41, 42

F3

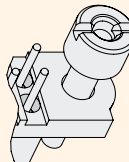
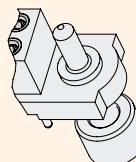

Panel Guide with Board Mount

Page 41

*See following pages for dimensional information.

SPECIAL CONTACTS

MALE

311, 312

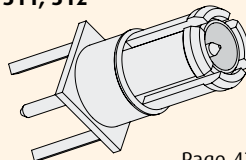

Page 43

313,
314

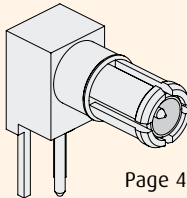

Page 43

315, 316, 317

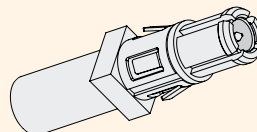

Page 44

318,
319

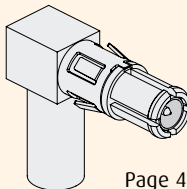

Page 44

331, 332

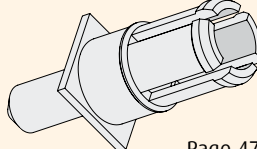

Page 47

333,
334

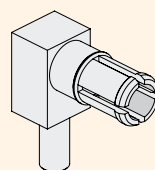

Page 47

335, 336, 337

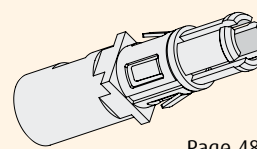

Page 48

FEMALE

301, 302

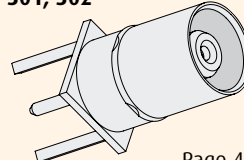

Page 45

305, 306, 307

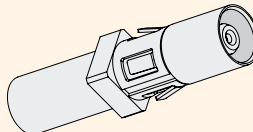

Page 46

308,
309

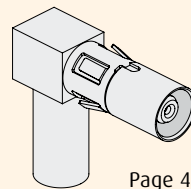

Page 46

321, 322

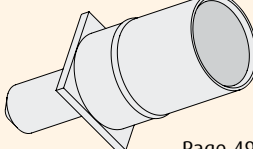

Page 49

325, 326, 327

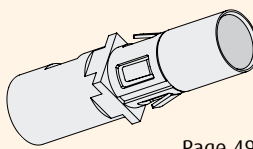

Page 49

COAX

POWER

*See pages listed above for dimensional information.

www.harwin.com



SPECIFICATION

Special Contacts

Materials

Latching collar:	Beryllium copper, nickel plated
Other metallic parts:	Copper alloy, Gold plated
Insulator:	PTFE

Electrical

Frequency range:	6 GHz (depending on cable)
Impedance:	50 Ohms
V.S.W.R.:	$< 1.05 + 0.04 F$ (GHz)
Operating voltage (sea level):	180 V a.c. at 500 mA
Maximum voltage (sea level):	1000 Vrms
Contact resistance:	6 Milliohms max
Insulation resistance:	106 Megohms at 250 Vrms

Mechanical

Endurance:	500 cycles
Insertion force:	5N max, 0.6N min
Withdrawal force:	2N max, 0.5N min
Contact replacement in connector:	5 times

Environmental

Operating temperature:	-55°C to +125°C
Salt spray test:	96 hrs
Humidity test:	56 days

www.harwin.com



HARWIN

Datamate Connectors

Male Vertical PC Tail

- ❖ Customer defined contact configurations.
- ❖ Jackscrews are assembled where specified.
- ❖ Special contacts are assembled where specified.
- ❖ For loose special contacts see pages 43 and 47.
- ❖ Fully shrouded contacts.
- ❖ Polarised mouldings.
- ❖ Mates with connectors shown on pages 41 and 42.



NON-SYMMETRICAL CONTACT CONFIGURATION

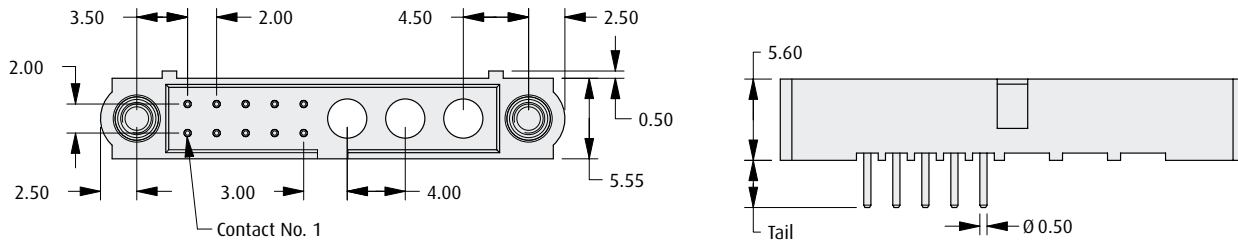

EXAMPLE OF PART NUMBER **M80-5TX10XXXX-00-000-03-XXX**

SYMMETRICAL CONTACT CONFIGURATION

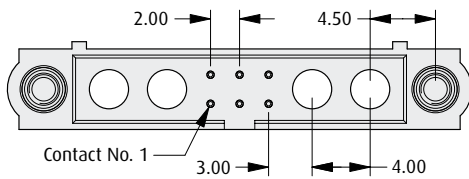

EXAMPLE OF PART NUMBER **M80-5TX06XXXX-02-XXX-02-XXX**

SPECIAL CONTACTS ONLY

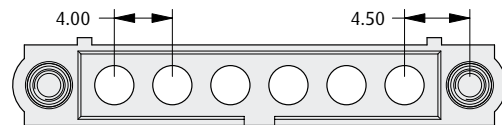

EXAMPLE OF PART NUMBER **M80-5000000XX-06-XXX-00-000**

WITH JACKSCREWS

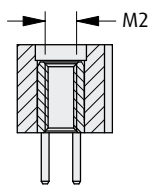

TAIL LENGTH	SERIES CODE
3mm	M80-5T1XXXXM1
4.5mm	M80-5T2XXXXM1

NO JACKSCREWS

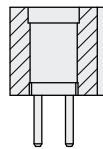

TAIL LENGTH	SERIES CODE
3mm	M80-5T1XXXX00
4.5mm	M80-5T2XXXX00

WITH BOARD-MOUNT JACKSCREWS

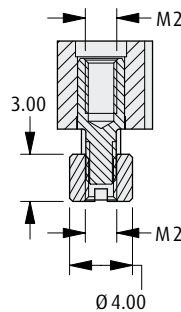

TAIL LENGTH	STUD LENGTH	SERIES CODE
3mm	3.5mm	M80-5T1XXXXM2
3mm	5.0mm	M80-5T1XXXXM3
4.5mm	3.5mm	M80-5T2XXXXM2
4.5mm	5.0mm	M80-5T2XXXXM3

All dimensions in mm.

www.harwin.com



Datamate Connectors

Male Horizontal PC Tail



- ❖ Jackscrews are assembled where specified.
- ❖ For loose special contacts see pages 43 and 47.
- ❖ Mates with connectors shown on pages 41 and 42.

NON-SYMMETRICAL CONTACT CONFIGURATION

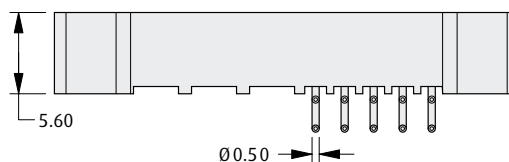
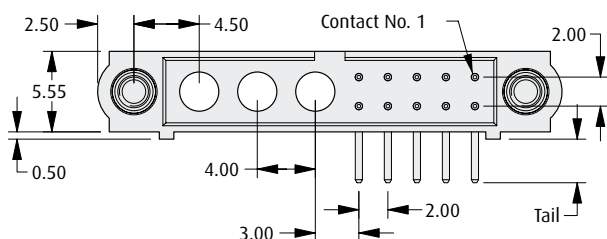

EXAMPLE OF PART NUMBER **M80-5LX10XXXX-00-000-03-XXX**

SYMMETRICAL CONTACT CONFIGURATION

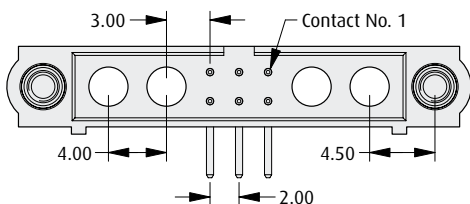

SPECIAL CONTACTS ONLY

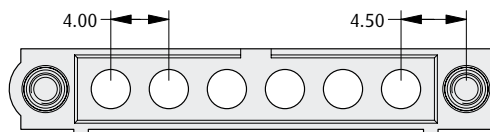

EXAMPLE OF PART NUMBER **M80-5LX06XXXX-02-XXX-02-XXX**

EXAMPLE OF PART NUMBER **M80-5000000XX-06-XXX-00-000**

WITH JACKSCREWS

NO JACKSCREWS

WITH BOARD MOUNT SLOTTED JACKSCREWS

WITH BOARD MOUNT HEX SOCKET JACKSCREWS

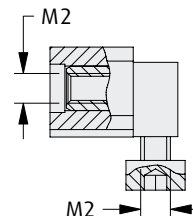
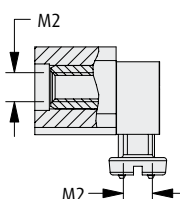
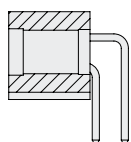
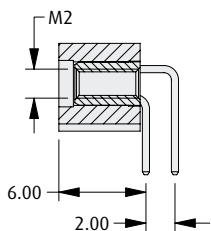

TAIL	SERIES CODE
3mm	M80-5L1XXXXM1
4.5mm	M80-5L2XXXXM1

TAIL	SERIES CODE
3mm	M80-5L1XXXX00
4.5mm	M80-5L2XXXX00

TAIL	BOLT	SERIES CODE
3mm	5.0mm	M80-5L1XXXXM5
4.5mm	5.0mm	M80-5L2XXXXM5

TAIL	BOLT	SERIES CODE
3mm	5.0mm	M80-5L1XXXXM7
4.5mm	5.0mm	M80-5L2XXXXM7

www.harwin.com

All dimensions in mm.



HARWIN

Datamate Connectors

Male Crimp

- ❖ Customer defined contact configurations.
- ❖ Polarised mouldings.
- ❖ Fully shrouded contacts.
- ❖ Large bore 22 AWG, small bore 24-28 AWG.
- ❖ Jackscrews are assembled where specified.
- ❖ Signal contacts are supplied loose and are rear insertable.
- ❖ Mates with connectors shown on pages 41 and 42.

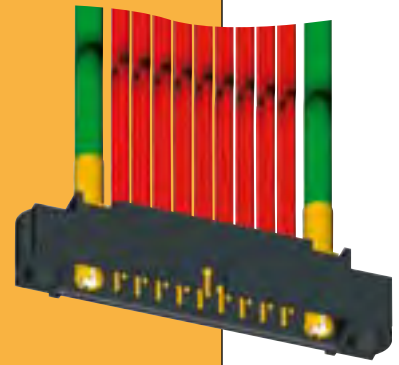

NON-SYMMETRICAL CONTACT CONFIGURATION

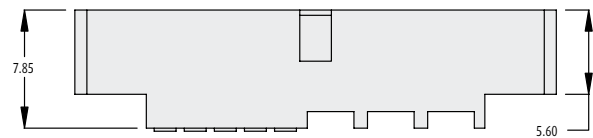
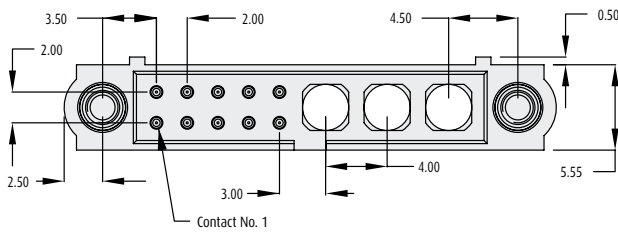

EXAMPLE OF PART NUMBER **M80-5X110XXXX-00-000-03-XXX**

SYMMETRICAL CONTACT CONFIGURATION

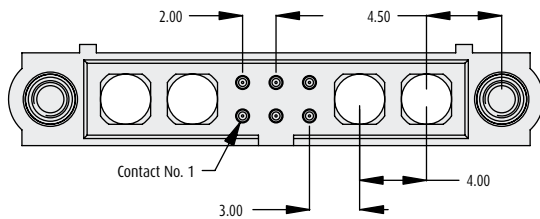

SPECIAL CONTACTS ONLY

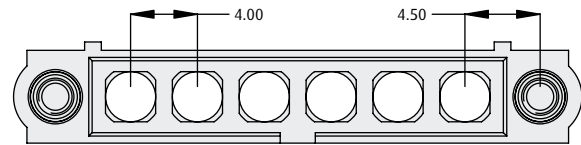

EXAMPLE OF PART NUMBER **M80-5X106XXXX-02-XXX-02-XXX**

EXAMPLE OF PART NUMBER **M80-5000000XX-06-XXX-00-000**

WITH JACKSCREWS

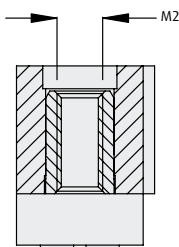

CRIMP SIZE	SERIES CODE
Large Bore	M80-5D1XXXXM1
Small Bore	M80-5C1XXXXM1

NO JACKSCREWS

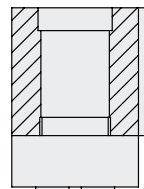

CRIMP SIZE	SERIES CODE
Large Bore	M80-5D1XXXX00
Small Bore	M80-5C1XXXX00

All dimensions in mm.

www.harwin.com



Datamate Connectors

Female PC Tail

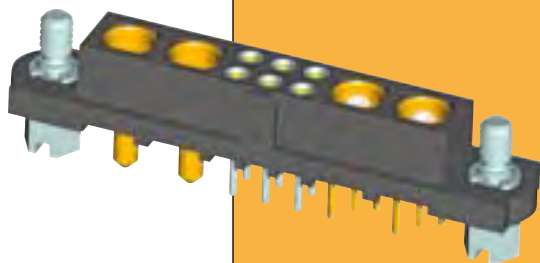

- ❖ Customer defined contact configurations.
- ❖ Jackscrews assembled where specified.
- ❖ Fully shrouded contacts.
- ❖ Polarised mouldings.
- ❖ Mates with connectors shown on pages 38 and 40.
- ❖ Special contacts are assembled where specified.
- ❖ For loose special contacts see pages 45 and 49.

NON-SYMMETRICAL CONTACT CONFIGURATION

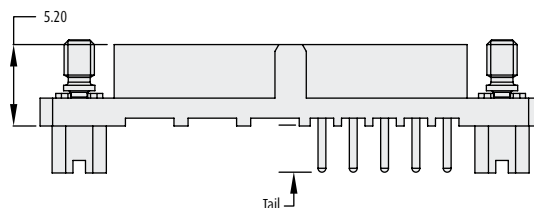
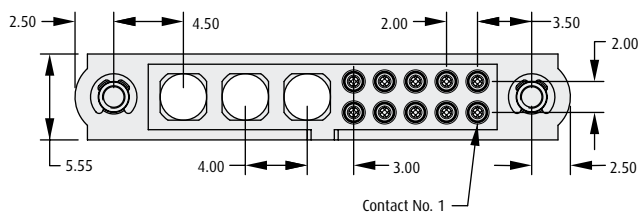

EXAMPLE OF PART NUMBER **M80-4TX10XXXX-00-000-03-XXX**

SYMMETRICAL CONTACT CONFIGURATION

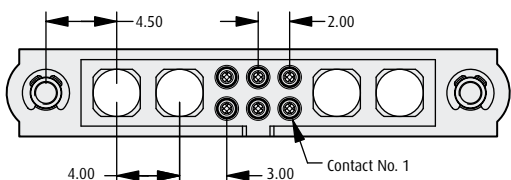

SPECIAL CONTACTS ONLY

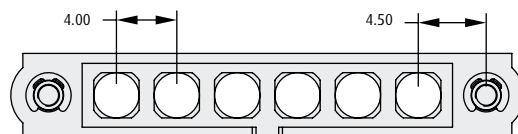

EXAMPLE OF PART NUMBER **M80-4TX06XXXX-02-XXX-02-XXX**

EXAMPLE OF PART NUMBER **M80-4000000XX-06-XXX-00-000**

WITH SLOTTED JACKSCREWS

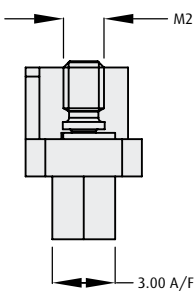

NO JACKSCREWS

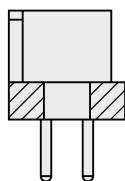

WITH HEX SOCKET JACKSCREWS

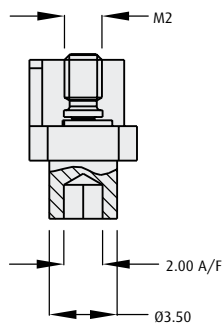

WITH PANEL MOUNT & GUIDE

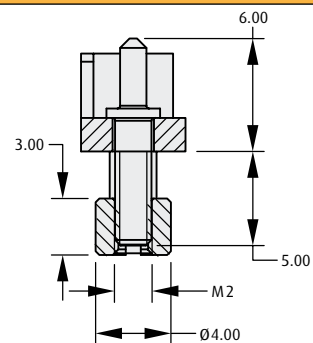

TAIL LENGTH	SERIES CODE	TAIL LENGTH	SERIES CODE	TAIL LENGTH	SERIES CODE	TAIL LENGTH	SERIES CODE
3mm	M80-4T1XXXXF1	3mm	M80-4T1XXXX00	3mm	M80-4T1XXXXF2	3mm	M80-4T1XXXXF3
4.5mm	M80-4T2XXXXF1	4.5mm	M80-4T2XXXX00	4.5mm	M80-4T2XXXXF2	4.5mm	M80-4T2XXXXF3

www.harwin.com

All dimensions in mm.



Datamate Connectors

Female Crimp

- ❖ Customer defined contact configurations.
- ❖ Polarised mouldings.
- ❖ Fully shrouded contacts.
- ❖ Large bore 22 AWG, small bore 24-28 AWG.
- ❖ Jackscrews are assembled where specified.
- ❖ Signal contacts are supplied loose and are rear insertable.
- ❖ Mates with connectors shown on pages 38 to 40.

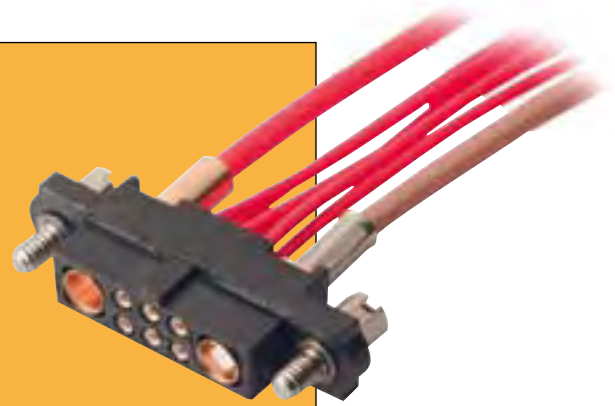

NON-SYMMETRICAL CONTACT CONFIGURATION

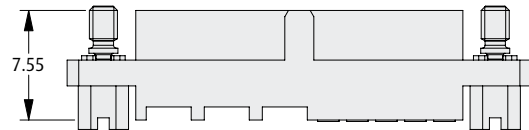
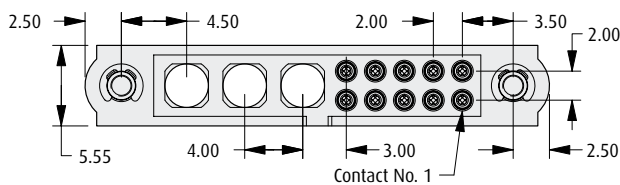

EXAMPLE OF PART NUMBER **M80-4X110XXXX-00-000-03-XXX**

SYMMETRICAL CONTACT CONFIGURATION

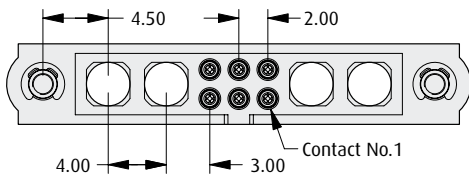

EXAMPLE OF PART NUMBER **M80-4X106XXXX-02-XXX-02-XXX**

SPECIAL CONTACTS ONLY

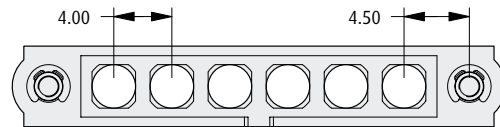

EXAMPLE OF PART NUMBER **M80-4000000XX-06-XXX-00-000**

WITH JACKSCREWS

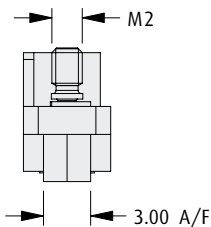

CRIMP SIZE	SERIES CODE
Large Bore	M80-4D1XXF1
Small Bore	M80-4C1XXF1

NO JACKSCREWS

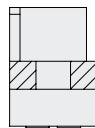

CRIMP SIZE	SERIES CODE
Large Bore	M80-4D1XX00
Small Bore	M80-4C1XX00

WITH BOARD-MOUNT JACKSCREWS

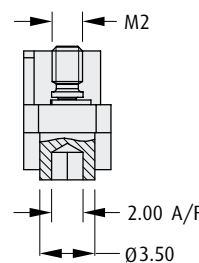

CRIMP SIZE	SERIES CODE
Large Bore	M80-4D1XXF2
Small Bore	M80-4C1XXF2

All dimensions in mm.

www.harwin.com

